

PROFILE SURVEYED  
 PLOTTED, CHECKED  
 NOTE BOOK  
 NO. \_\_\_\_\_  
 STRUCTURE NOTATIONS CHFD

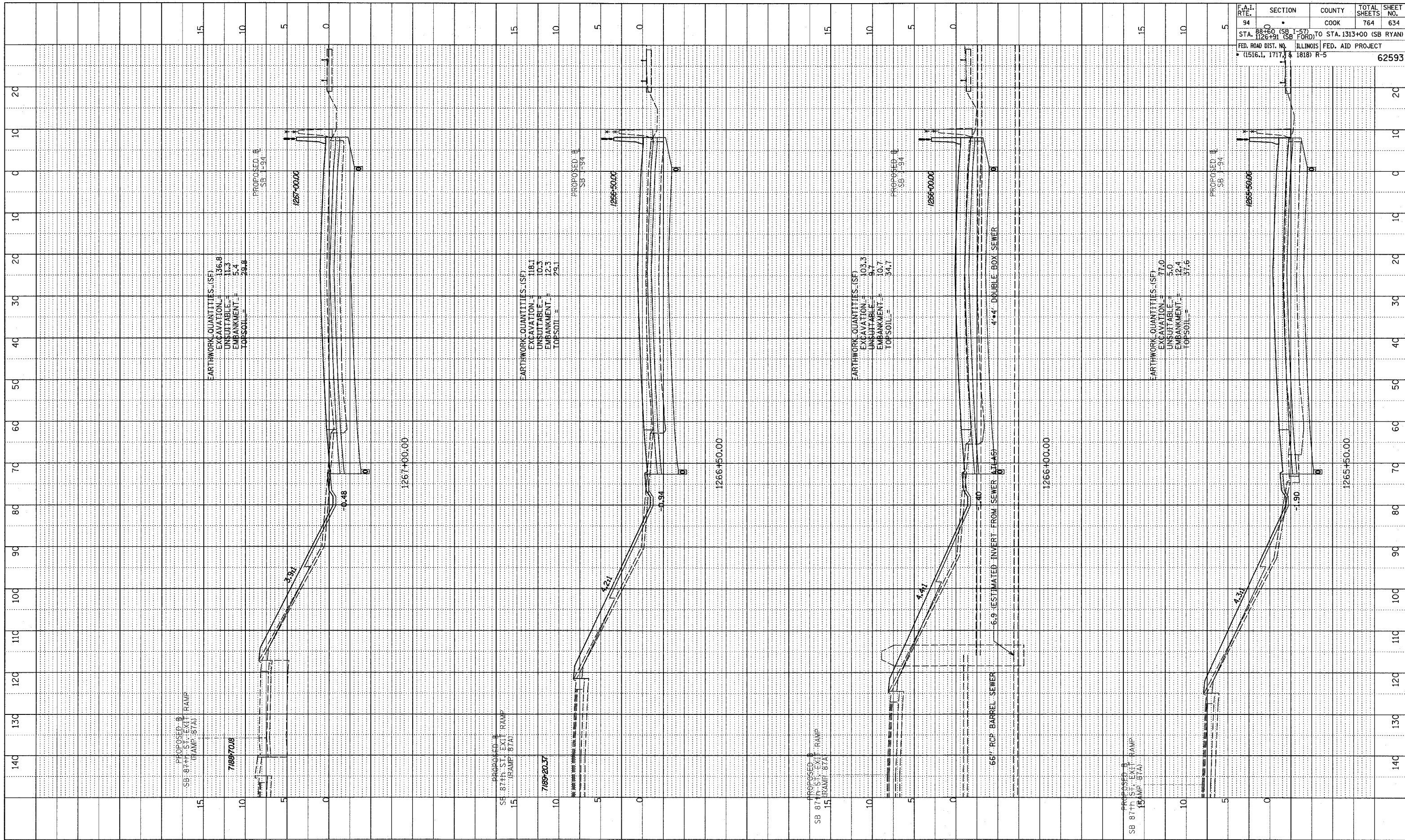

F.A.I. RTE.	SECTION	COUNTY	TOTAL SHEETS	SHEET NO.
94	1265+50 TO 1267+00	COOK	764	634

STA. 88+50 (SB I-57) TO STA. 1313+00 (SB RYAN)  
 STA. 1126+91 (SB FORD)  
 FED. ROAD DIST. NO. ILLINOIS FED. AID PROJECT  
 (1516.1, 1717, & 1818) R-5

62593

TYLIN INTERNATIONAL

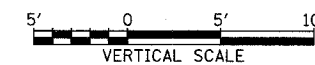
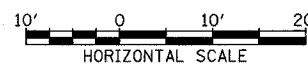

I-94 SOUTHBOUND (DAN RYAN EXPWY)  
 STA. 1265+50 TO STA. 1267+00

02/27/2006 12:32:25 PM P:\02373\road\023\pk23\ss187.dgn