

REVIEWED: _____
 CHECKED: _____
 DRAWN: _____
 DATE: _____
 PROJECT: _____
 SHEET: _____

F.A.I. RTE.	SECTION	COUNTY	TOTAL SHEETS	SHEET NO.
94	89+50 (SB I-57) TO STA. 1126+91 (SB FORD)	COOK	764	641
	ILLINOIS FED. AID PROJECT			
	(1516.1, 1717, & 1818) R-5			
				62593

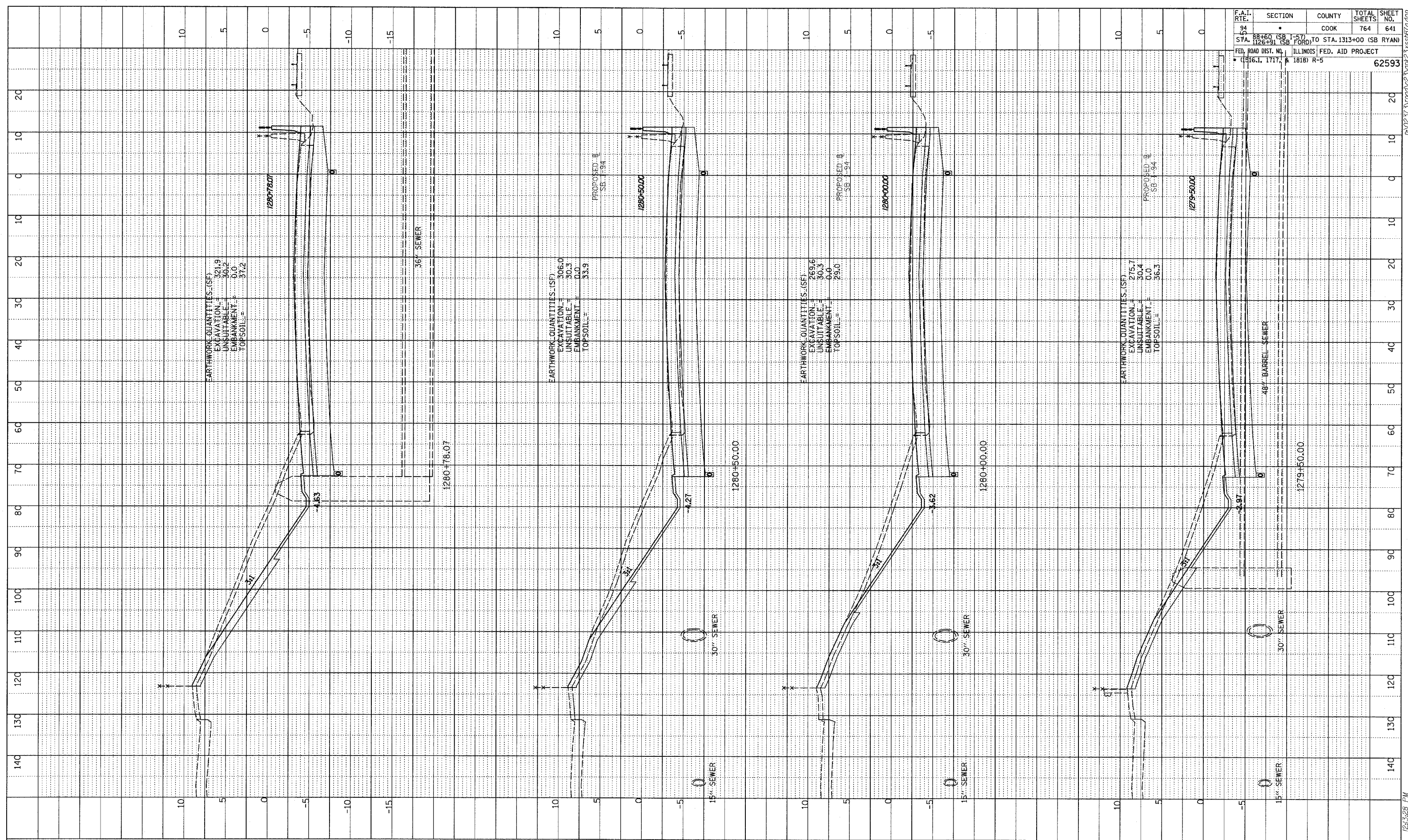

TYLIN INTERNATIONAL

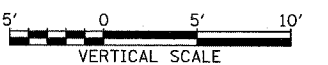
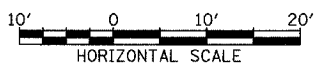

I-94 SOUTHBOUND (DAN RYAN EXPWY)
STA. 1279+50 TO STA. 1280+78.07

02/27/2006 12:53:28 PM