

PROF. ILL. SURVEYED
 GRADES CHECKED
 B.M. NOTED
 STRUCTURE NOTING OK'D

F.A.I. RTE.	SECTION	COUNTY	TOTAL SHEETS	SHEET NO.
84	88+60 (SB) TO STA. 1313+00 (SB RYAN)	COOK	764	655
04	STA. 1128+91 (SB FORD)			
FED. ROAD DIST. NO. ILLINOIS FED. AID PROJECT				0
(1516.1, 1717, 1818) R-5				62593

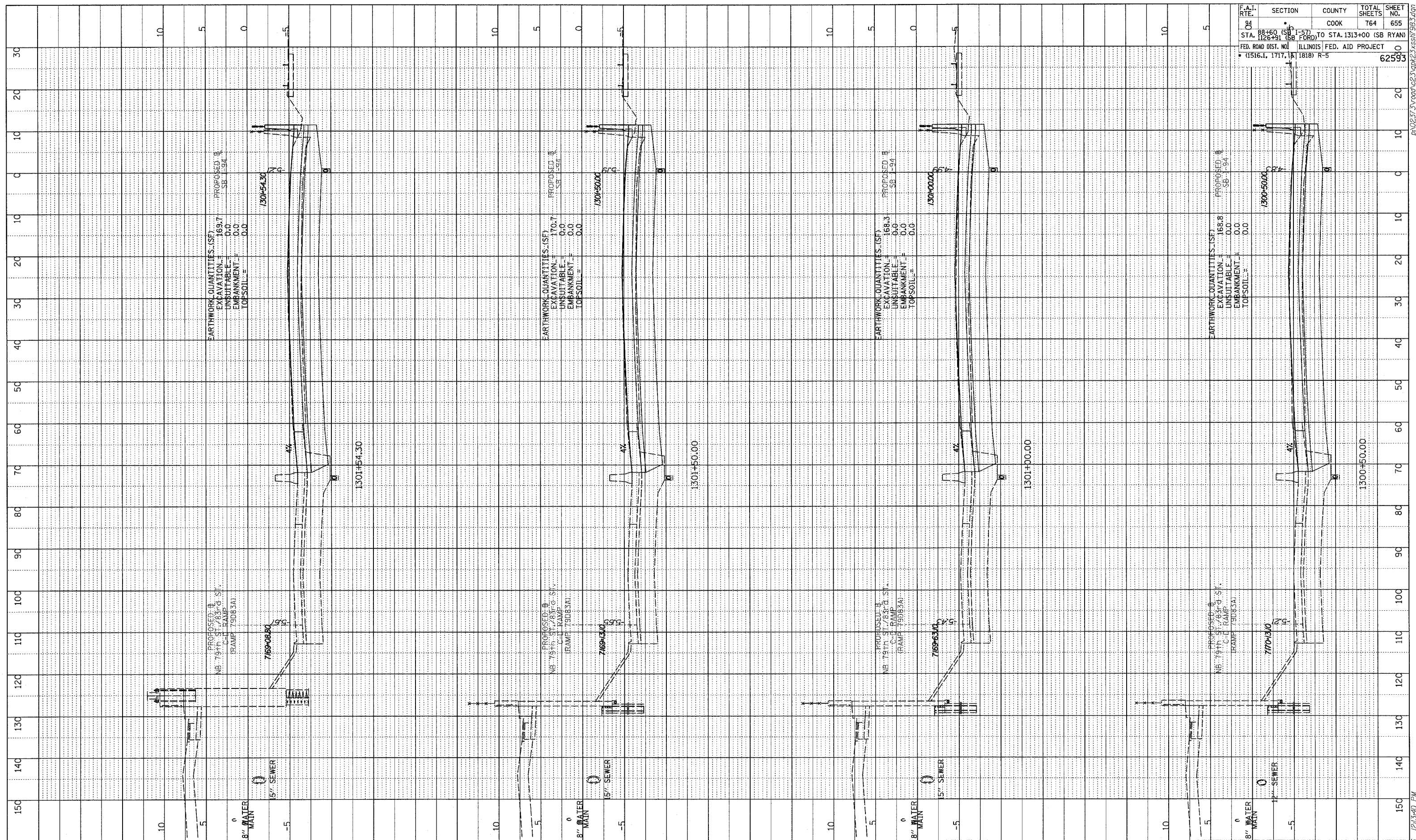

TYLIN INTERNATIONAL

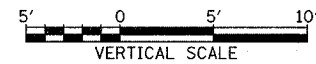

I-94 SOUTHBOUND (DAN RYAN EXPWY)
 STA. 1300+50 TO STA. 1301+54.30

02/27/2006 12:13:40 PM