

SURVEYED
 GRADES CHECKED
 E.M. NOTED
 STRUCTURE NOTING BRAND
 NO.

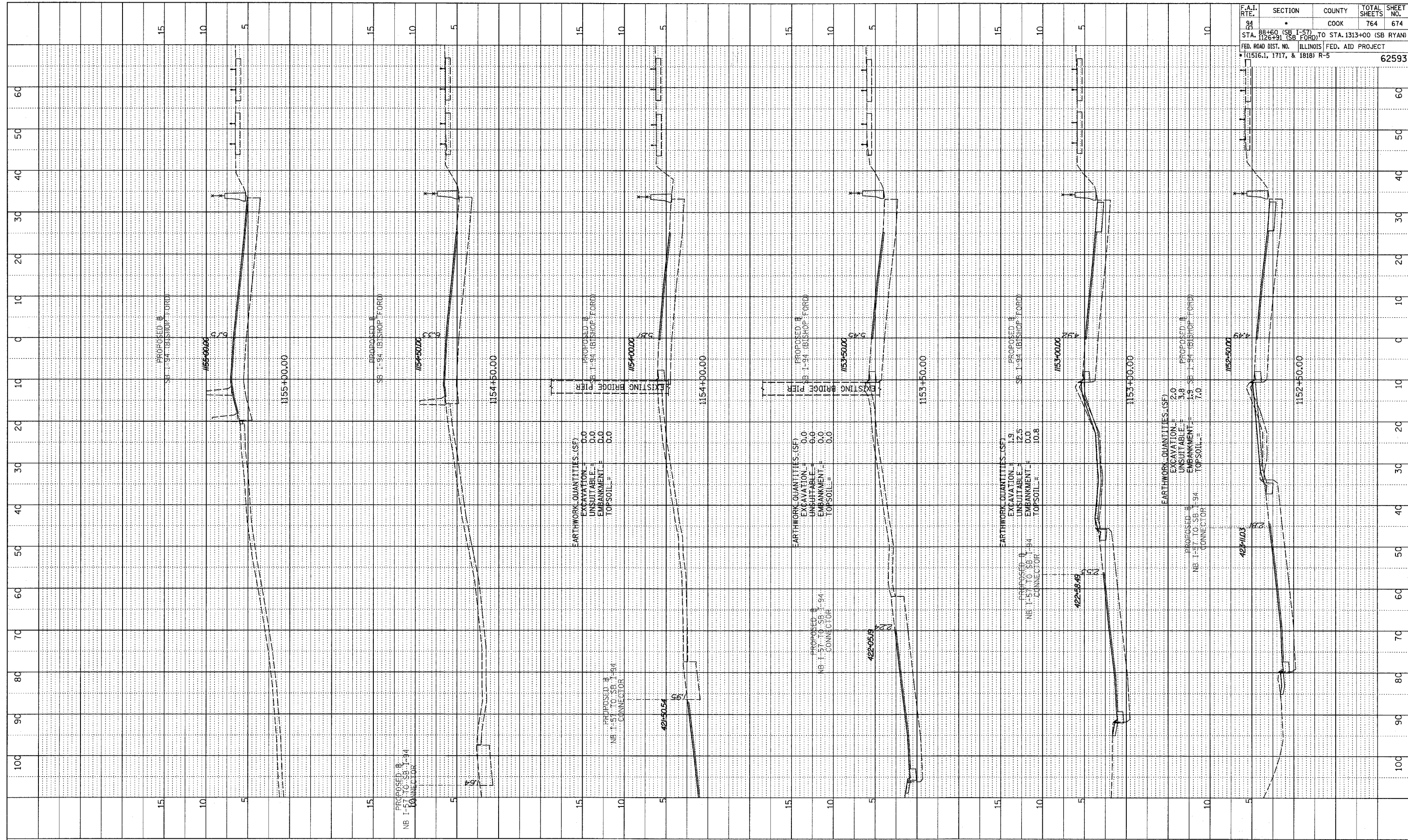

F.A.I. RTE.	SECTION	COUNTY	TOTAL SHEETS	SHEET NO.
94	88+60 (SB I-57) TO STA. 1126+91 (SB FORD)	COOK	764	674
	ILLINOIS FED. AID PROJECT			
	FED. ROAD DIST. NO. (1516.1, 1717, & 1818) R-5			
	62593			

TYLIN INTERNATIONAL

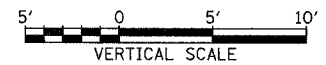
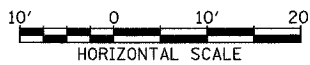

I-94 SOUTHBOUND (BISHOP FORD FWY)
 STA. 1152+50 TO STA. 1155+00

02/27/2006 12:43:56 PM