

SEE SHEET 2 OF 3  
MATCHLINE STA. 1287+00 SB DAN RYAN

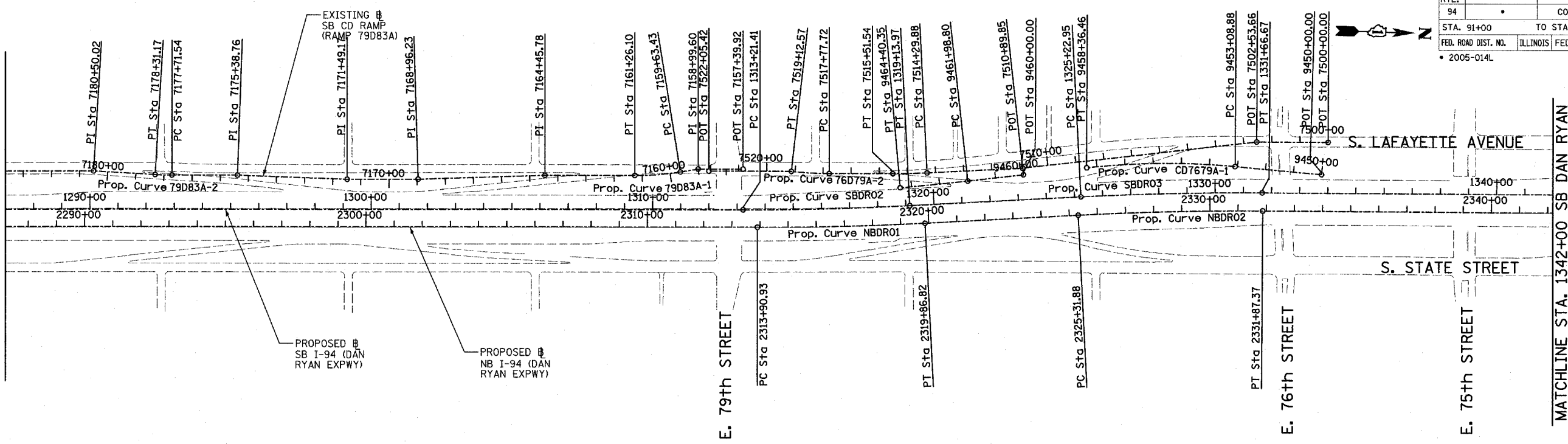

Prop. Curve	P.I. STA	N	E	Δ	D	R	L	T	P.C. STA	P.T. STA
Prop. Curve NBDRO1	2316+88.94	1,853,051.58	1,177,504.84	2° 58' 38.60" (LT)	0° 29' 58.77"	11,467.00	595.89	3.87	2313+90.93	2319+86.82
Prop. Curve NBDRO2	2328+57.71	1,854,218.69	1,177,410.58	3° 16' 48.34" (RT)	0° 30' 01.44"	11,450.00	595.49	4.69	2325+31.88	2331+87.37
Prop. Curve NBDRO3	2398+13.58	1,861,170.38	1,177,231.19	44° 36' 17.12" (LT)	2° 44' 29.13"	2,090.00	1,627.06	168.99	2389+56.30	2405+83.37
Prop. Curve SBDRO2	1316+17.76	1,852,997.25	1,177,445.02	2° 58' 38.60" (LT)	0° 30' 08.86"	11,403.00	592.56	3.85	1313+21.41	1319+13.97
Prop. Curve SBDRO3	1328+44.90	1,854,220.54	1,177,346.22	3° 16' 11.04" (RT)	0° 30' 28.59"	11,280.00	643.72	4.59	1325+22.95	1331+66.67
Prop. Curve SBDRO4	1397+75.78	1,861,149.16	1,177,163.97	44° 32' 58.56" (LT)	2° 47' 41.70"	2,050.00	1,593.95	165.31	1389+36.07	1405+30.02

MATCHLINE STA. 1342+00 SB DAN RYAN

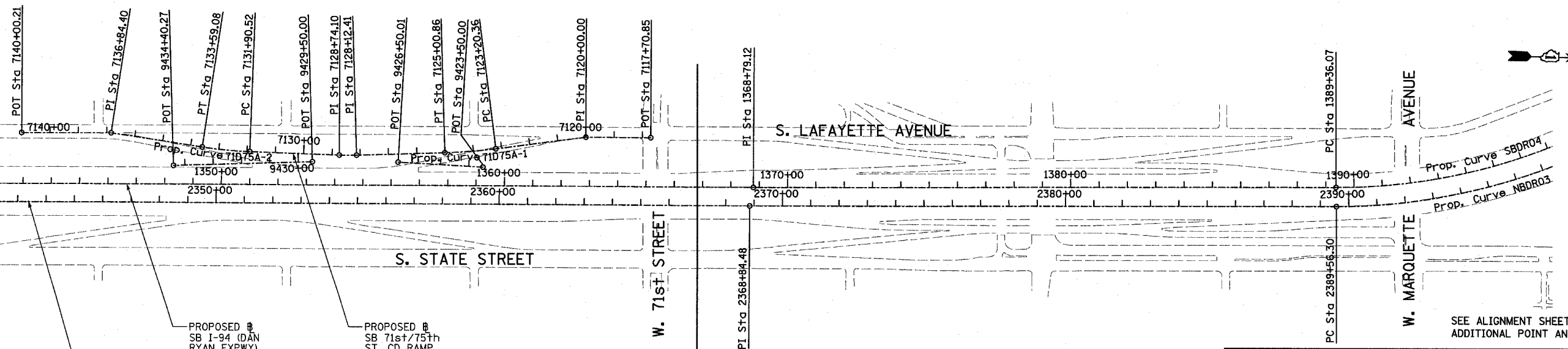

PROPOSED # NB I-94 (DAN RYAN EXPWY)  
PROPOSED # SB I-94 (DAN RYAN EXPWY)  
PROPOSED # SB 71st/75th ST. CD RAMP (RAMP 71D75A)

NB PROJECT LIMIT  
NB I-94 (DAN RYAN) @  
STA. 2367+00.00

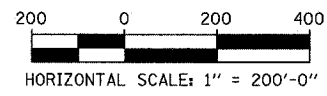

REVISIONS	
NAME	DATE

ILLINOIS DEPARTMENT OF TRANSPORTATION  
F.A.I. 94 (DAN RYAN EXPRESSWAY)  
ALIGNMENT  
SHEET 3 OF 4  
SCALE: 1"=200'  
DATE: JANUARY 13, 2006  
DRAWN BY: JPM  
CHECKED BY: DAK

7/12/2006 9:09:32 AM