

CONTRACT NO. 64858				
F.A.P. RTE.	SECTION	COUNTY	TOTAL SHEETS	SHEET NO.
553	125VBR-1	DEKALB	55	15
STA.		TO STA.		
FED. ROAD DIST. NO. - ILLINOIS		FED. AID PROJECT		

LOCAL TRAFFIC DETOUR ROUTE

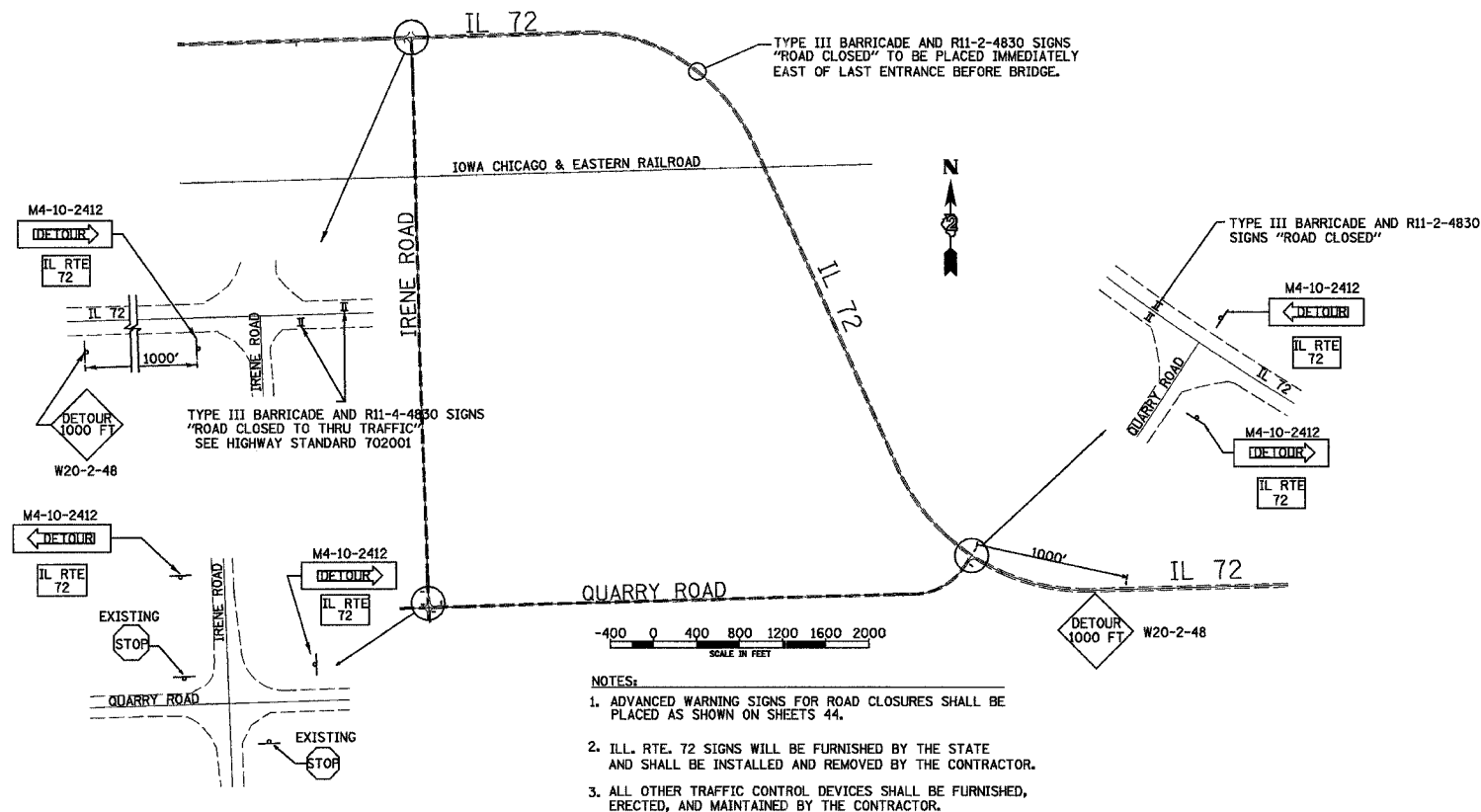

MULTIPLE TRAFFIC DETOUR ROUTE

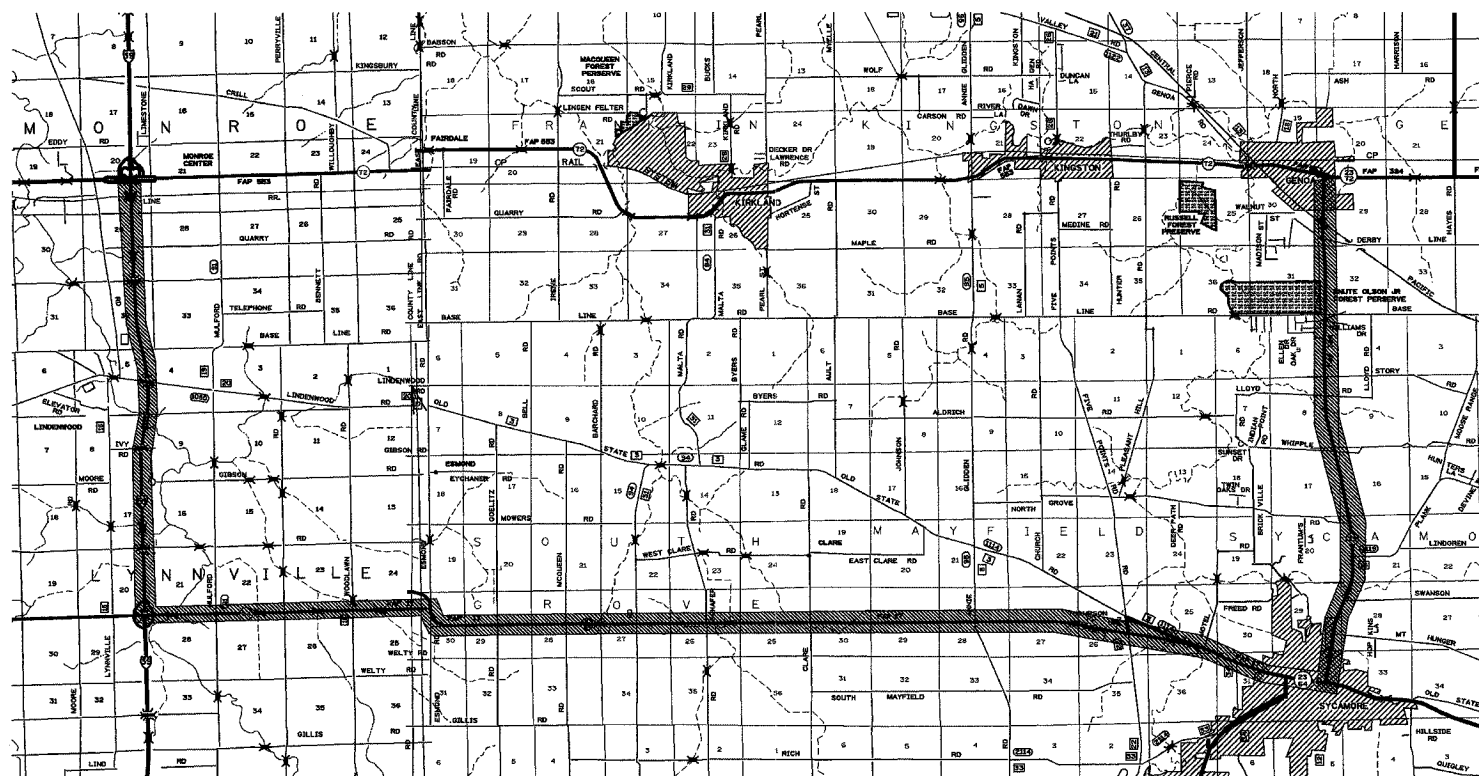

NOTES:

THE MULTIPLE UNIT DETOUR ROUTE WILL BE SET BY THE ILLINOIS DEPARTMENT OF TRANSPORTATION, DISTRICT 2 – THIS ROUTE WILL UTILIZE I-39, ILLINOIS 64, ILLINOIS 23 FOR THE MULTIPLE UNIT TRAFFIC.

THE LOCAL TRAFFIC DETOUR ROUTE WILL ALSO BE SET BY THE ILLINOIS DEPARTMENT OF TRANSPORTATION, DISTRICT 2 – THIS ROUTE WILL UTILIZE QUARRY ROAD FROM IL ROUTE 72 WEST TO IRENE ROAD AND IRENE ROAD FROM IL ROUTE 72 SOUTH TO QUARRY ROAD.

THE CONTRACTOR SHALL NOTIFY THE TRAFFIC OPERATIONS SECTION OF THE BUREAU OF OPERATIONS BY FAX (815) 284-5489 AND THE BUREAU OF PROJECT IMPLEMENTATION (815) 284-5348 IN WRITING BY MEANS OF FAX (TO THE NUMBERS PROVIDED) AND ALSO BY LETTER TO THE DISTRICT OFFICE. THE REQUEST SHALL BE SUBMITTED A MINIMUM OF THREE WEEKS (21 DAYS) PRIOR TO THE ANTICIPATED CLOSURE DATE TO ALLOW THE STATE ADEQUATE TIME TO SET THE DETOUR ROUTE.

SIGNING AND DEVICES REQUIRED TO CLOSE THE ROAD, ACCORDING TO THE TRAFFIC CONTROL FOR ROAD CLOSURE DETAIL AND CONTAINED HEREIN, SHALL BE THE RESPONSIBILITY OF THE CONTRACTOR. DETOUR SIGNING REQUIRED TO DETOUR TRAFFIC TO ALTERNATE ROUTES SHALL BE THE RESPONSIBILITY OF THE DEPARTMENT. THE DAY THE DETOUR SIGNING BEGINS, THE DETOUR WILL BE IN EFFECT AT 1:00 P.M. NO DETOUR SHALL BE ERECTED ON MONDAY OR FRIDAY.

PLOT DATE = 2/06
 FILE NAME = TRAFF
 USER NAME = CHANS

REVISIONS		ILLINOIS DEPARTMENT OF TRANSPORTATION	
NAME	DATE	TRAFFIC CONTROL PLAN	
		FAP 553 (IL 72)	
		SECTION 125VBR-1	
		DEKALB COUNTY	
		SCALE: VERT. 1" = 1000'	DRAWN BY ARR
		HORIZ. 1" = 1000'	CHECKED BY JKC
		DATE 2/06	