

F.A.I. RTE.	SECTION	COUNTY	TOTAL SHEETS	SHEET NO.
I-80	06-48B-1	BUREAU	32	20
STA.		TO STA.		
FED. ROAD DIST. NO.		ILLINOIS FED. AID PROJECT		

MAINTENANCE OF TRAFFIC

1. THE DEPARTMENT SHALL BE NOTIFIED 72 HOURS PRIOR TO ROAD CLOSURE AND IMMEDIATELY AFTER THE ROAD HAS BEEN REOPENED.
2. BUREAU COUNTY SHALL BE NOTIFIED AT LEAST TWO WEEKS PRIOR TO CLOSING THE ROAD.
3. THE CONTRACTOR SHALL FURNISH, INSTALL, MAINTAIN AND REMOVE ALL TEMPORARY SIGN SUPPORTS. AFTER REMOVING THE SUPPORTS, THE CONTRACTOR SHALL FILL HOLES (IF ANY) AND RESTORE THE GROUND TO ITS ORIGINAL CONDITION AND ELEVATION. PLACING OF GRAVEL, SOD, OR SEED SHALL BE INCLUDED IN THE UNIT BID PRICE FOR "TRAFFIC CONTROL FOR ROAD CLOSURE".
4. ALL SIGNS, SUPPORTS AND POSITIONING SHALL BE IN ACCORDANCE WITH THE ILLINOIS MANUAL ON UNIFORM TRAFFIC CONTROL DEVICES, LATEST EDITION.
5. ALL WARNING SIGNS IN TEMPORARY TRAFFIC CONTROL ZONES SHALL HAVE A BLACK LEGEND ON AN ORANGE BACKGROUND, UNLESS OTHERWISE NOTED.
6. EACH TYPE III BARRICADE SHALL BE EQUIPPED WITH TWO FLASHING AMBER LIGHTS.
7. FOR STABILIZATION, ALL TYPE III BARRICADES SHALL HAVE A MINIMUM OF FOUR (4) SANDBAGS PER BARRICADE (ONE PER LEG).
8. THE CONTRACTOR SHALL ERECT SIGN NO. 7 AT LEAST 2 WEEKS IN ADVANCE OF THE CLOSURE.
9. ALL ENTRANCES ON THE CLOSED PORTION OF BACKBONE ROAD MUST BE OPEN FOR TRAFFIC DURING THE ENTIRE CONSTRUCTION PERIOD.
10. THE WORK SHALL BE PAID FOR AT THE LUMP SUM PRICE FOR "TRAFFIC CONTROL FOR ROAD CLOSURE".
11. TRAFFIC CONTROL FOR WORK ALONG I-80 WILL BE PERFORMED IN ACCORDANCE WITH HIGHWAY STANDARDS 701400 AND 701406-04. THE WORK WILL BE PAID FOR AS "TRAFFIC CONTROL AND PROTECTION, STANDARD 701406".
12. THE CONTRACTOR SHALL CONTACT THE BUREAU COUNTY ENGINEER - JEFF PEACOCK AT (815) 875-4477 FOR SETUP AND PLACEMENT OF TWO CHANGEABLE MESSAGE SIGNS. THE ADDRESS FOR THE BUREAU COUNTY ENGINEER IS: ROUTE 34 EAST PRINCETON, ILLINOIS 61356

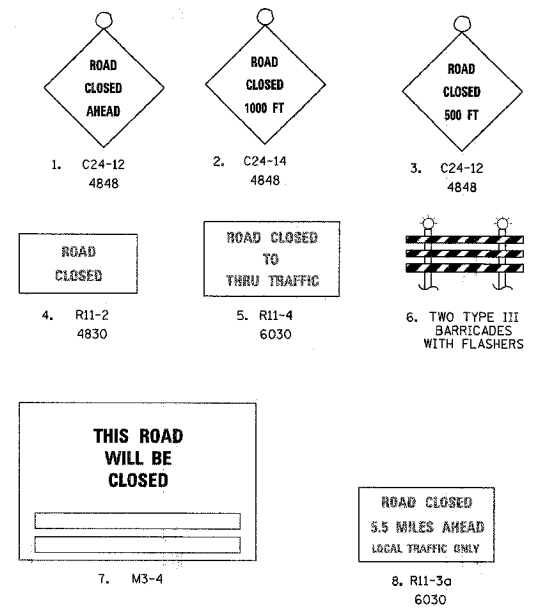
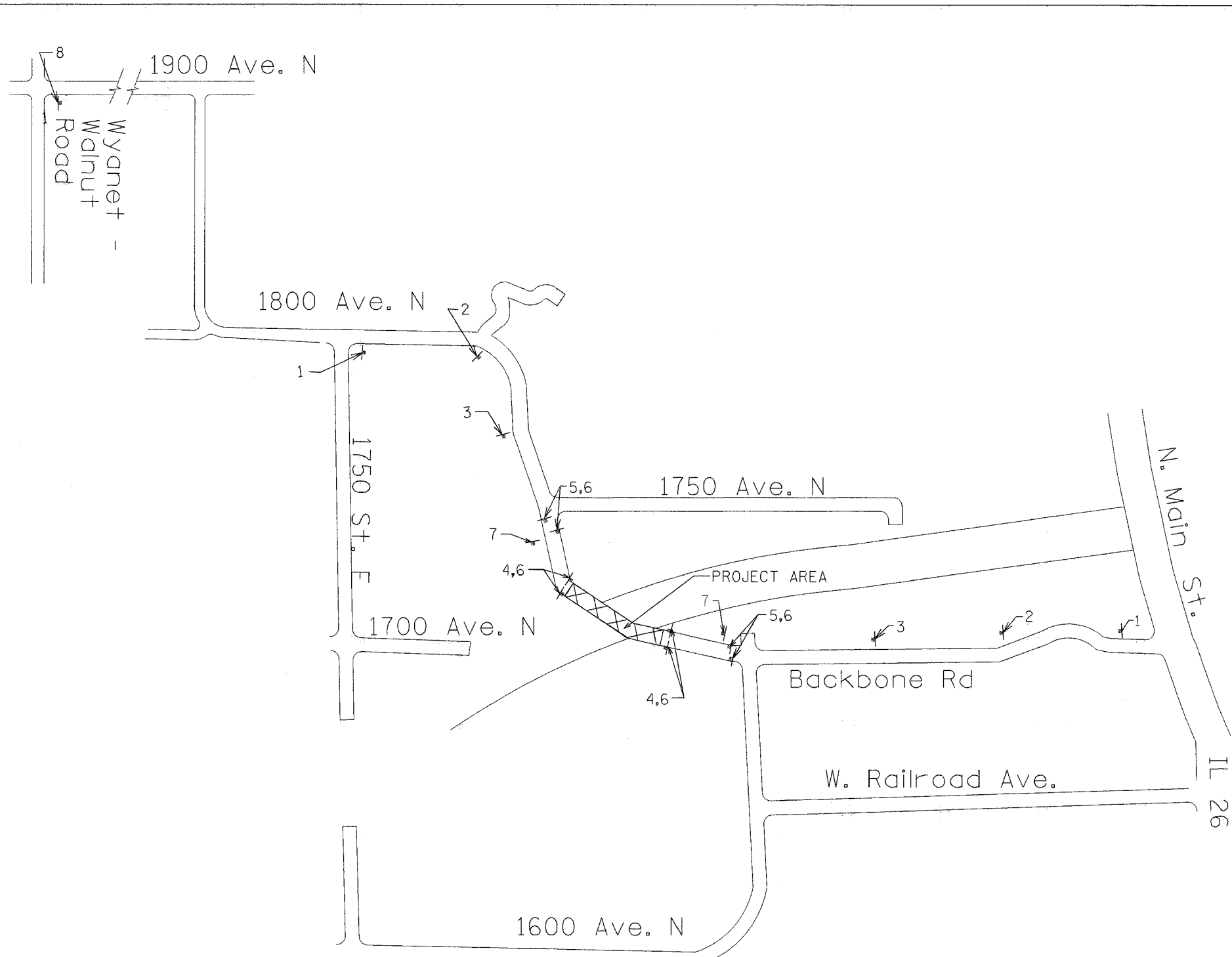
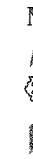

LEGEND
 PROJECT AREA
 CLOSURE SIGN

REVISIONS	
NAME	DATE

ILLINOIS DEPARTMENT OF TRANSPORTATION
**FAS 244 (BACKBONE ROAD)
 BRIDGE REHABILITATION
 MAINTENANCE OF TRAFFIC**

SCALE: VERT. NONE
 HORIZ. NONE
 DATE 2/07/06

DRAWN BY AR
 CHECKED BY RJS