

F.A.I. RTE.	SECTION	COUNTY	TOTAL SHEETS	SHEET NO.
80	(32, 47-4)K	KENDALL/GRUNDY	243	46
STA. 14+19		TO STA. 10+00		
FED. ROAD DIST. NO.		ILLINOIS FED. AID PROJECT		
CONTRACT NO. 66294				

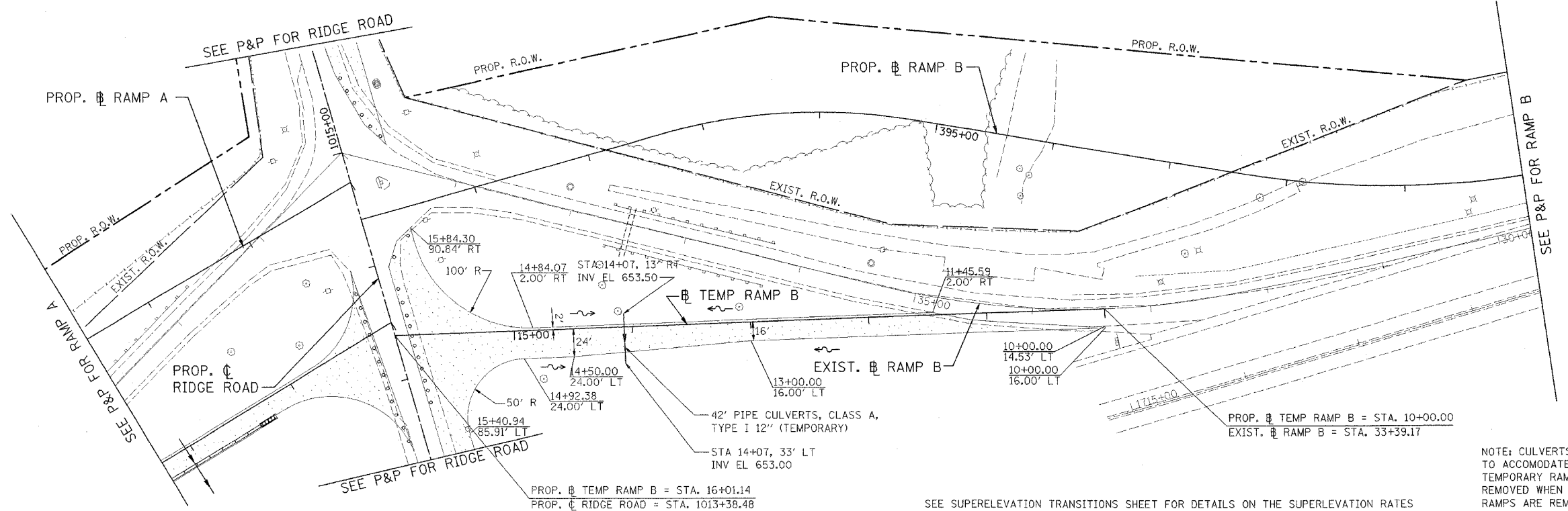

NOTE: CULVERTS TO BE CONSTRUCTED TO ACCOMMODATE DRAINAGE FOR TEMPORARY RAMPS, AND WILL BE REMOVED WHEN THE TEMPORARY RAMPS ARE REMOVED

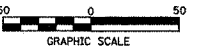

SEE SUPERELEVATION TRANSITIONS SHEET FOR DETAILS ON THE SUPERELEVATION RATES

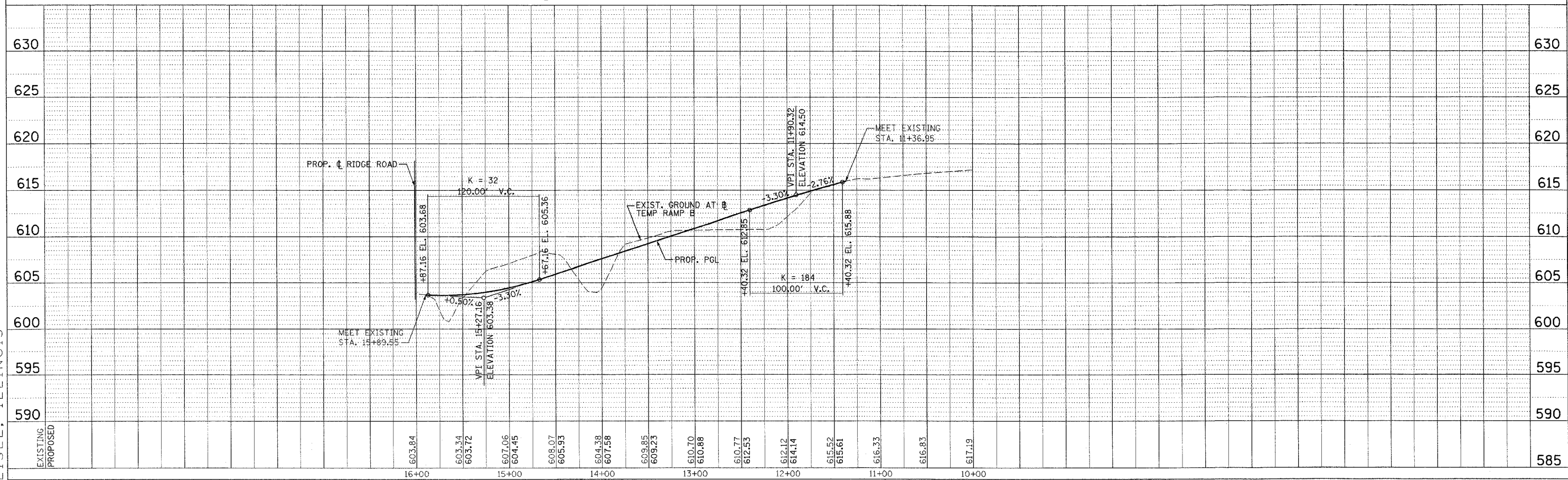

DATE	BY	REVISION

PLAN SURVEYED
PLOTTED
CHECKED
DATE OF WAY CHECKED
NOTE BOOK NO.
P&P FILE NAME

DATE	BY	REVISION

PROFILE
FILE
PLOTTED
CHECKED
DATE OF WAY CHECKED
NOTE BOOK NO.
STRUCTURE NUMBER (if any)

PATRICK
ENGINEERING INC.
LISLE, ILLINOIS