

F.A.I. RTE.	SECTION	COUNTY	TOTAL SHEETS	SHEET NO.
80	32, 47-4K	KENDALL/GROUNY	243	72
STA.	TO STA.			
FED. ROAD DIST. NO.	ILLINOIS	FED. AID PROJECT		
CONTRACT NO. 66294				

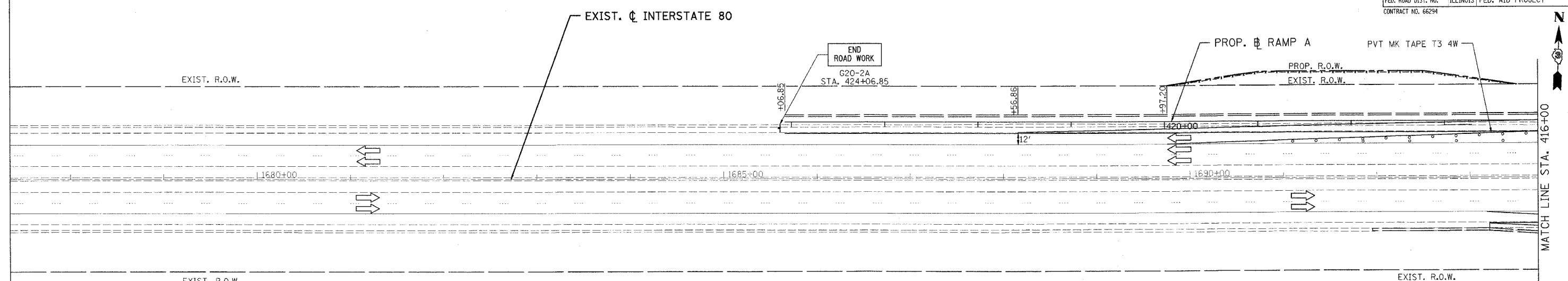

- LEGEND**
- TYPE II BARRICADES OR DRUMS WITH STEADY BURN LIGHTS @ 50' CENTERS, 25' CENTERS ALONG TAPERS AND 12' CENTERS ALONG RADIUS RETURNS
  - ➔ TRAFFIC DIRECTION
  - ⊞ TYPE III BARRICADES WITH FLASHING LIGHTS
  - ▨ WORK ZONE
  - ▨ TEMPORARY PAVEMENT
  - ⊞ ARROW BOARD
  - ⊞ VERTICAL PANEL WITH STEADY BURNING LIGHT

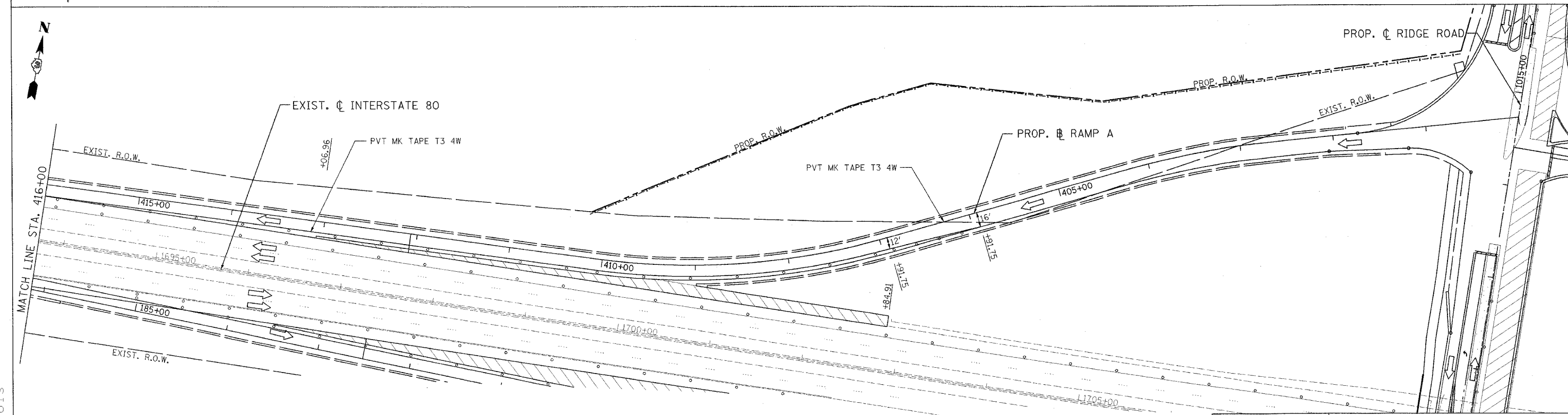

REVISIONS	
NAME	DATE

ILLINOIS DEPARTMENT OF TRANSPORTATION  
 FAI ROUTE 80 (I-80 AT MINOOKA INTERCHANGE)  
 SUGGESTED STAGING OF CONSTRUCTION & TRAFFIC CONTROL  
 STAGE 2  
 RAMP A  
 STA. 400+00 TO STA. 424+06.85  
 SCALE: 1:50  
 DATE: 2/10/06  
 DRAWN BY: MAT  
 CHECKED BY: JJC

**PATRICK**  
 ENGINEERING INC.  
 LISLE, ILLINOIS

MOT-25 OF 31