

F.A.I. RTE.	SECTION	COUNTY	TOTAL SHEETS	SHEET NO.
80	(32, 47-4)K	KENDALL/GRUNDY	243	106
STA.	TO STA.			
FED. ROAD DIST. NO.	ILLINOIS	FED. AID PROJECT		
CONTRACT NO. 66294				

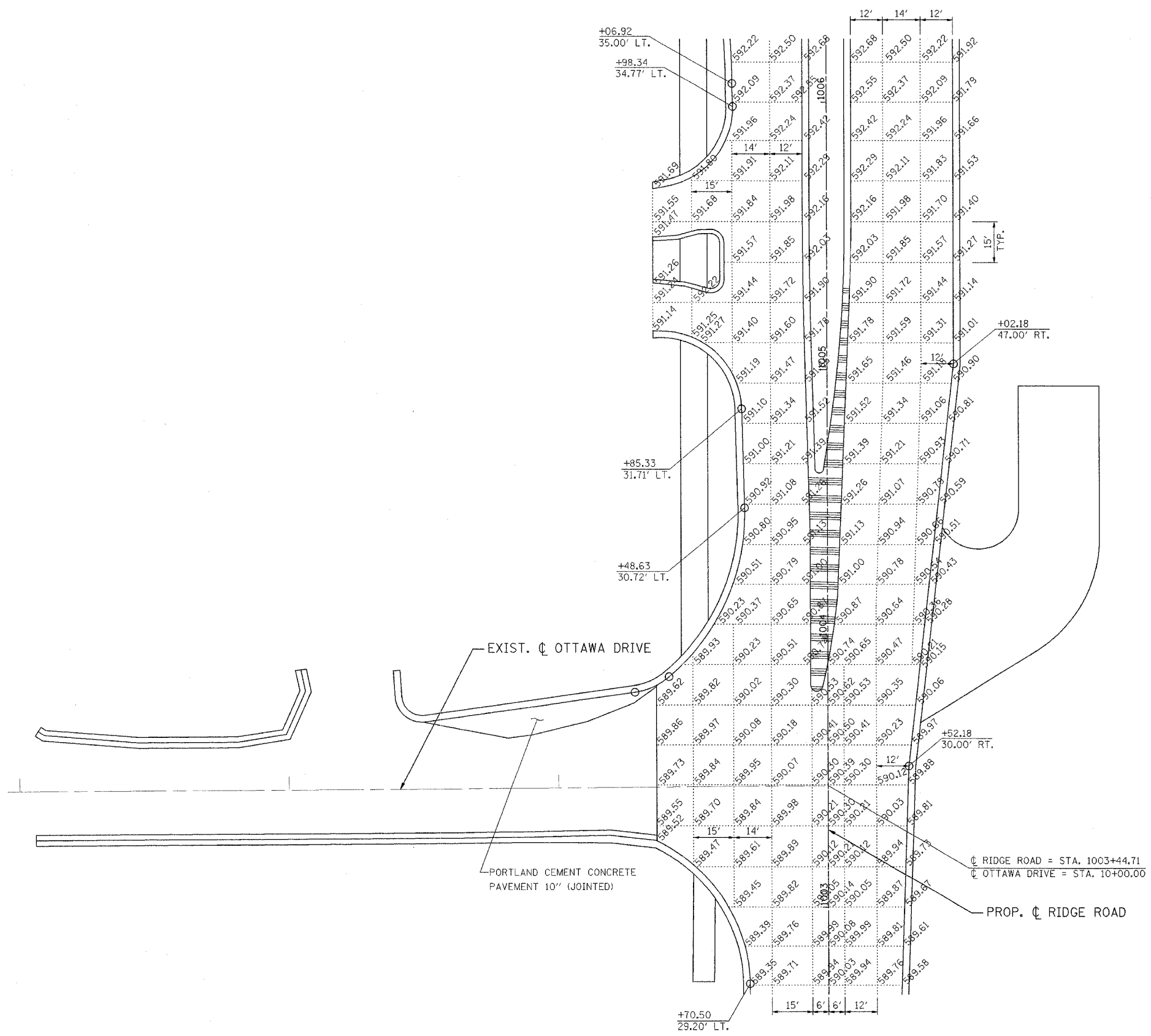

NOTES:  
 ADDITIONAL JOINTS MAY BE REQUIRED IN THE FIELD, AS DIRECTED BY THE ENGINEER.  
 EXACT LOCATIONS TO BE VERIFIED IN THE FIELD, AND APPROVED BY THE ENGINEER.

REVISIONS		ILLINOIS DEPARTMENT OF TRANSPORTATION FAI ROUTE 80 (I-80 AT MINOOKA INTERCHANGE)  PAVEMENT JOINT & ELEVATION PLAN
NAME	DATE	

SCALE: 1:20  
 DATE: 2/10/06  
 DRAWN BY: TCK  
 CHECKED BY: JJC

**PATRICK**  
 ENGINEERING INC.  
 LISLE, ILLINOIS