

F.A.I. RTE.	SECTION	COUNTY	TOTAL SHEETS	SHEET NO.
80	(32, 47-41K)	KENDALL/GRUNDY	243	117
STA.	TO STA.			
FED. ROAD DIST. NO.	ILLINOIS FED. AID PROJECT			
CONTRACT NO. 66294				

**NOTES FOR TEMPORARY TRAFFIC SIGNALS**

1. THE CONTRACTOR SHALL VERIFY THE EXACT LOCATION OF ALL UNDERGROUND UTILITIES PRIOR TO BEGINNING CONSTRUCTION. CALL J.U.L.I.E. AT 800-892-0123. THE CONTRACTOR SHALL ALSO VERIFY THAT NO CONFLICTS WITH PROPOSED STORM SEWER, CONDUITS, ETC. AND THE TEMPORARY WOOD POLES WILL EXIST.
2. THE TRAFFIC SIGNAL SECTION AT THE ILLINOIS DEPARTMENT OF TRANSPORTATION SHALL BE NOTIFIED AT 815-434-8506 AT LEAST 72 HOURS PRIOR TO TURNING ON ANY FLASHER OR CONTROLLER UNITS.
3. THE CONTRACTOR SHALL BE RESPONSIBLE FOR THE MAINTENANCE OF THE TEMPORARY TRAFFIC SIGNAL INSTALLATIONS FOR THE DURATION OF THE SIGNAL WORK.
4. ALL TRAFFIC SIGNAL HEADS SHALL BE 12 INCHES.
5. TEMPORARY TRAFFIC SIGNAL HEADS SHALL BE PROPERLY COVERED PRIOR TO INTERSECTION TURN-ON AND AS DIRECTED BY THE ENGINEER DURING OPERATION OF THE TEMPORARY SIGNALS. THIS COST SHALL BE INCLUDED WITH THE COST OF THE TEMPORARY TRAFFIC SIGNAL INSTALLATION PAY ITEM.
6. THE CONTRACTOR SHALL ARRANGE FOR A FACTORY OR SUPPLIER REPRESENTATIVE TO BE PRESENT AT THE INTERSECTION WHEN THE TEMPORARY SIGNALS ARE TURNED ON. COST TO BE INCLUDED WITH THE TEMPORARY TRAFFIC SIGNAL INSTALLATION PAY ITEM.
7. THE ELECTRICAL CONDUCTORS FOR ALL TRAFFIC SIGNAL HEADS SHALL BE SOLID, SOFT COPPER.
8. THE CONTRACTOR IS RESPONSIBLE FOR UNCOVERING OR HAND DIGGING AROUND UTILITIES AS NECESSARY. THE COST OF THIS WORK IS TO BE INCLUDED WITH THE TEMPORARY TRAFFIC SIGNAL INSTALLATION PAY ITEM.
9. ALL TEMPORARY WOOD POLES SHALL BE LOCATED A MINIMUM OF 1.8M (6FT) FROM THE EDGE OF THE PAVEMENT UNLESS OTHERWISE DIRECTED BY THE ENGINEER.
10. THE PROPOSED TEMPORARY TRAFFIC SIGNAL CONTROL CABINET SHALL BE FURNISHED WITH A MANUAL CONTROL SWITCH AND MANUAL CONTROL CORD WITHIN THE POLICE DOOR COMPARTMENT AS INCIDENTAL TO THE TEMPORARY TRAFFIC SIGNAL INSTALLATION PAY ITEM.
11. THE CONTRACTOR SHALL BE RESPONSIBLE FOR OBTAINING ELECTRICAL SERVICE FOR THE TEMPORARY TRAFFIC SIGNALS. THE CONTRACTOR SHALL CONTACT THE UTILITY COMPANY PRIOR TO BEGINNING WORK TO OBTAIN THE UTILITY COMPANY REQUIREMENTS FOR THE SERVICE INSTALLATION.
12. ALL TEMPORARY WOOD SUPPORT POLES SHALL BE INSTALLED SO THAT A MINIMUM OF 9.1M (30 FT) OF POLE IS ABOVE THE EXISTING PAVEMENT ELEVATION ADJACENT TO THE POLE. A SUFFICIENT LENGTH OF POLE SHALL BE BURIED AND GUYED TO ALLOW THE INSTALLATION TO WITHSTAND 80 K.P.H. SUSTAINED WIND LOADING.
13. THE CABINET OF SUFFICIENT SIZE SHALL BE INSTALLED BY THE CONTRACTOR AT A LOCATION ACCEPTABLE TO THE ENGINEER. THE CABINET SHALL NOT BE LOCATED ON A SPAN WIRE POLE. IT SHALL BE EITHER GROUND MOUNTED ON A WOODEN FOUNDATION OR POST MOUNTED ON A SEPARATE POST. ALL CABLE WITHIN 3M (10 FT) OF THE GROUND SHALL BE IN CONDUIT. IT IS ACCEPTABLE FOR 4M (13.2 FT) OR LESS LENGTHS OF CONDUIT TO BE LAID ALONG THE GROUND IN AREAS ACCEPTABLE TO THE ENGINEER.
14. A MINIMUM OF 8M (26 FT) OF CABLE SLACK SHALL BE PROVIDED FOR EACH SIGNAL HEAD. NEED ENOUGH SLACK TO BE ABLE TO ADJUST RIDGE ROAD SIGNAL HEADS FROM PRE-STAGE TO STAGE III LOCATIONS.
15. REINSTALL EXISTING STREET NAME SIGNS TO TEMPORARY SPAN WIRE POLES AS DIRECTED BY THE ENGINEER.
16. REINSTALL THE EXISTING OR PROVIDE NEW R-10-12 (LEFT TURN YIELD ON GREEN). 600MM X 750MM SIGNS IMMEDIATELY RIGHT OF THE 5-SECTION SPAN-WIRE SIGNAL HEADS & BETWEEN THE 3-SECTION SPAN WIRE SIGNAL HEADS ON THE FAR SPAN WIRES AT RAMPS WHERE PROTECTED/PERMITTED LEFT TURN MOVEMENT EXISTS.
17. INSTALL BRACKET MOUNTED SIGNALS WITH BOTTOM OF SIGNAL 4.5M (15 FT) ABOVE GROUND.
18. THE MICROWAVE DETECTORS SHALL BE MODEL TC 26B AND SHALL BE MOUNTED ON SPAN WIRE OR MOUNTED ON TEMPORARY WOOD POLE IN LIEU OF SPAN WIRE. THE DETECTOR SHALL CALL TO THE ASSOCIATE PHASE. THE DETECTOR AND ANY EQUIPMENT ASSOCIATED WITH THE MICROWAVE DETECTOR AND TO PLACE CALLS INTO THE CONTROL SHALL BE INCLUDED IN THE "INSTALL TEMPORARY TRAFFIC SIGNAL" PAY ITEM.
19. THE CONTROLLER SHALL BE SET TO A MINIMUM RECALL RIDGE ROAD.
20. A SELF ADHERE PHASING DIAGRAM SHALL BE PLACED INSIDE THE CABINET DOOR.

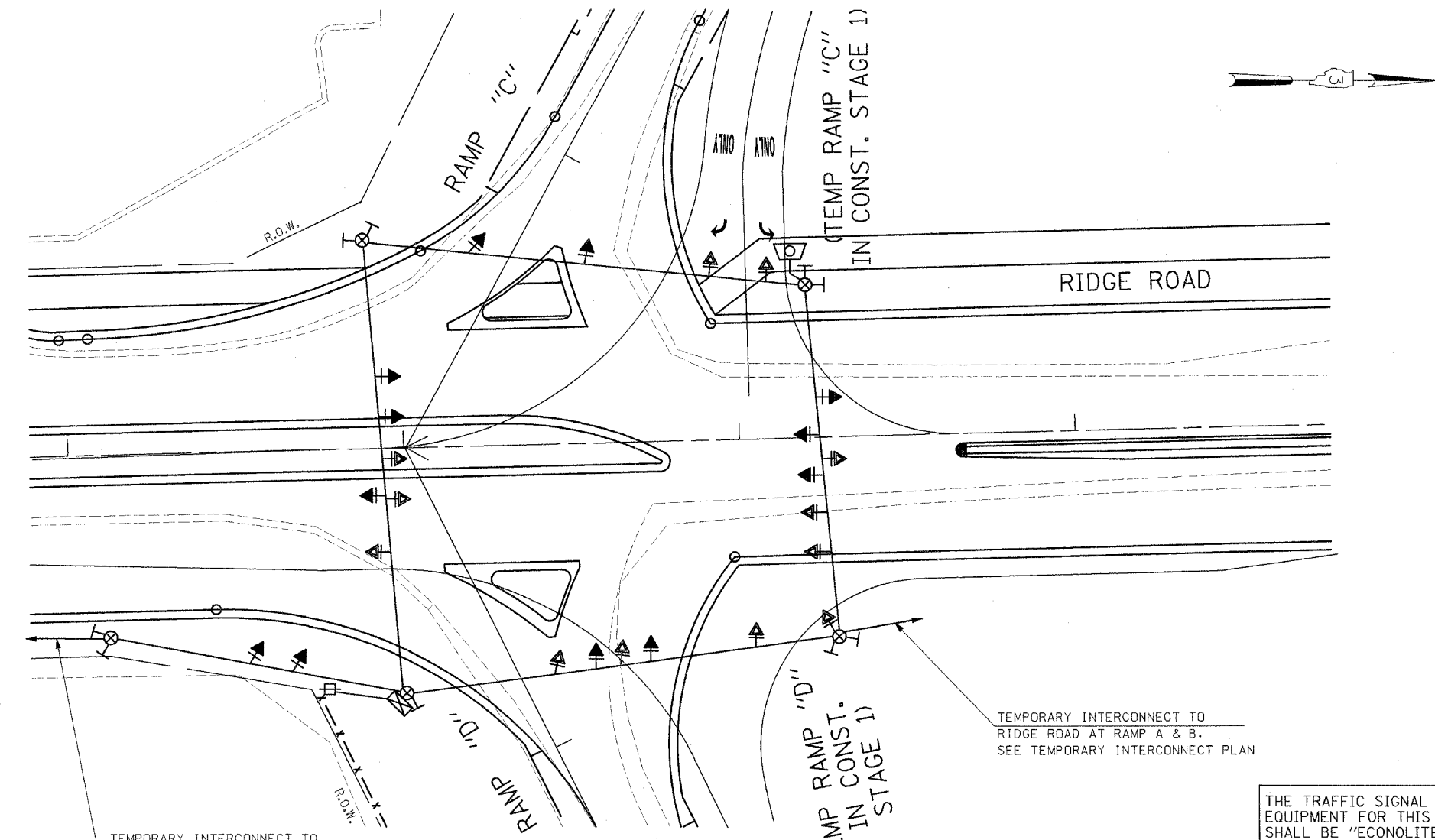

THE TRAFFIC SIGNAL CONTROL EQUIPMENT FOR THIS PROJECT SHALL BE "ECONOLITE" TO MATCH THE EXISTING TRAFFIC SIGNAL CONTROLLER IN THE VILLAGE OF MINOOKA.

**TEMPORARY TRAFFIC SIGNAL LEGEND**

- ▲ TEMPORARY TRAFFIC SIGNAL HEAD SPAN WIRE MOUNTED ORIGINAL LOCATION
- ▲ TEMPORARY TRAFFIC SIGNAL HEAD SPAN WIRE MOUNTED SECONDARY LOCATION
- ⊗ TEMPORARY WOOD POLE (CLASS 5 OR BETTER) 45 FOOT (13.7m) MINIMUM
- ⊠ TEMPORARY CONTROLLER CABINET
- TEMPORARY SPAN WIRE, TETHER WIRE, AND CABLE
- ⊕ TEMPORARY SERVICE INSTALLATION
- ⊥ TEMPORARY PEDESTRIAN SIGNAL HEAD, BRACKET MOUNTED
- ⊙ PEDESTRIAN PUSHBUTTON DETECTOR
- ⊙ EMERGENCY VEHICLE LIGHT DETECTOR
- ⊙ CONFIRMATION BEACON
- VEHICLE DETECTOR, INDUCTION LOOP
- CT COMMON TRENCH
- UD UNIT DUCT
- G.S. CONDUIT IN GROUND
- HANDHOLE
- HEAVY DUTY HANDHOLE
- ⊙ MICROWAVE DETECTOR, TC 26B

**TEMPORARY TRAFFIC SIGNAL INSTALLATION**

SCALE 1"=20'

- NOTE 1:** THE ORIGINAL SIGNAL HEAD PLACEMENT LOCATIONS SHOWN IN THE TEMPORARY TRAFFIC SIGNAL PLAN ARE FOR PRE-STAGE CONSTRUCTION ONLY.
- NOTE 2:** THE SECONDARY SIGNAL HEAD PLACEMENT LOCATIONS SHOWN IN THE TEMPORARY TRAFFIC SIGNAL PLAN ARE FOR CONSTRUCTION STAGE 1 ONLY. FOR OTHER CONSTRUCTION STAGES, THE SIGNAL HEAD PLACEMENTS SHALL BE AS DIRECTED BY THE ENGINEER.
- NOTE 3:** THE MICROWAVE DETECTOR LOCATION SHOWN IN THE TEMPORARY SIGNAL PLAN FOR RAMP "C" IS FOR PROPOSED CONSTRUCTION STAGE 1. FOR OTHER CONSTRUCTION STAGES THE MICROWAVE DETECTOR SHALL BE RELOCATED, IF REQUIRED, AS DIRECTED BY THE ENGINEER.

REVISIONS	
NAME	DATE

ILLINOIS DEPARTMENT OF TRANSPORTATION  
FAI ROUTE 80 (I-80 AT MINOOKA INTERCHANGE)

TEMPORARY TRAFFIC SIGNAL INSTALLATION,  
RIDGE ROAD AT RAMPS "C" AND "D"

SCALE: 1"=20'  
DATE: 2/10/06

DRAWN BY: SA/KGP  
CHECKED BY: PKG

**GO** GANDHI AND ASSOCIATES, INC.  
ENGINEERS AND PLANNERS  
6035 N. NORTHWEST HIGHWAY  
SUITE 306  
CHICAGO, ILLINOIS 60631 TEL. (773) 774-5930