

F.A.I. RTE.	SECTION	COUNTY	TOTAL SHEETS	SHEET NO.
80	(32, 47-4)K	KENDALL/GRUNDY	243	136
STA.	TO STA.			
FED. ROAD DIST. NO.	ILLINOIS FED. AID PROJECT			
CONTRACT NO. 66294				

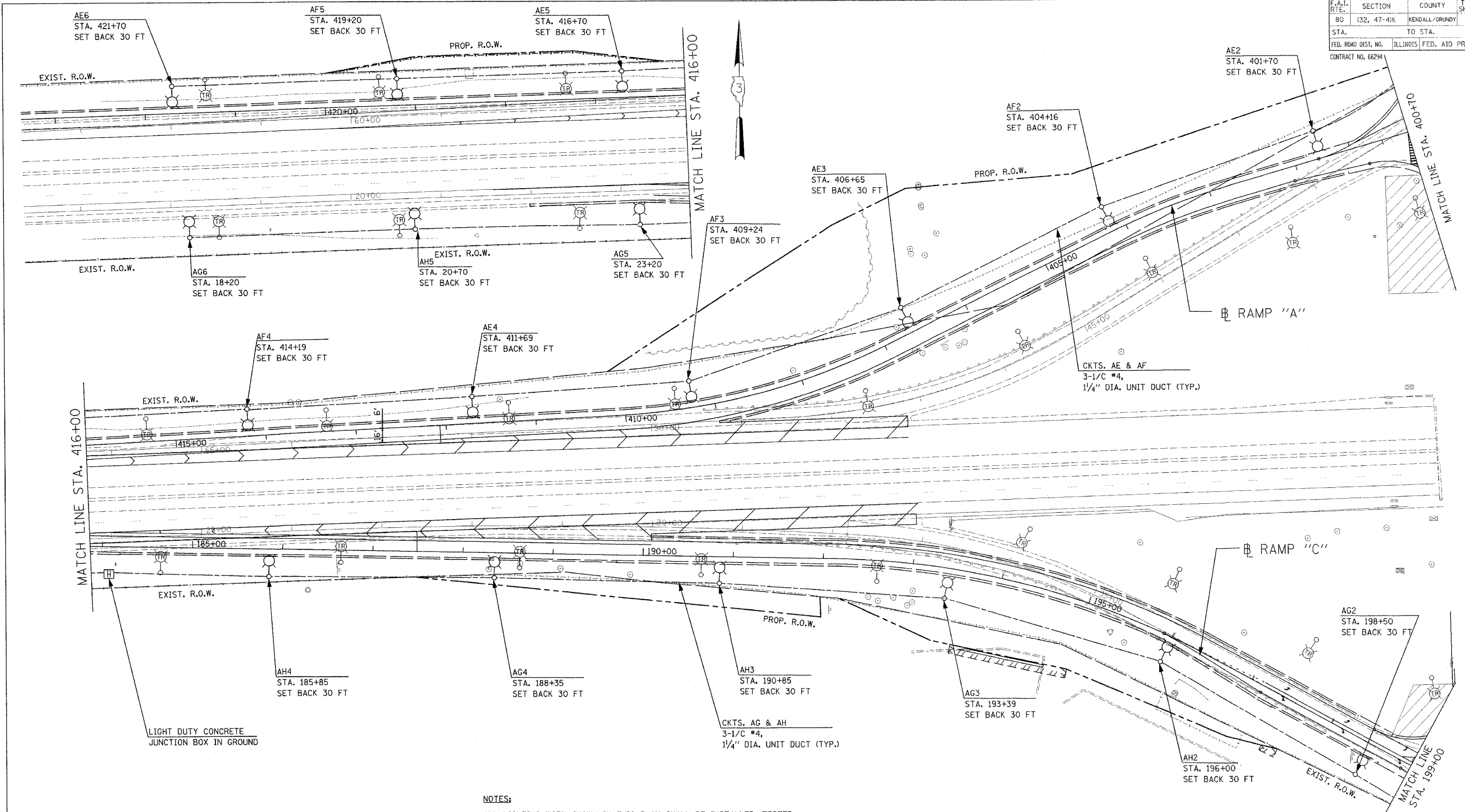

NOTES:

1. ALL LIGHTING WORK SHOWN IN THIS PLAN SHALL BE INSTALLED, TESTED, AND MADE FULLY OPERATIONAL PRIOR TO COMMENCEMENT OF STAGE 1A CONSTRUCTION.
2. THE POLES SHALL BE KEPT OUT OF DITCH AREA AND PLACED AS FAR AS 40', IF NEEDED, TO GET OUT OF FLOW LINE.
3. ALL LUMINAIRES SHALL BE INSTALLED AT A 35° TILT ANGLE.

REVISIONS	
NAME	DATE

ILLINOIS DEPARTMENT OF TRANSPORTATION
 FAI ROUTE 80 (I-80 AT MINOOKA INTERCHANGE)
 TEMPORARY LIGHTING
 RAMP "A" AND RAMP "C"
 SHEET 1 OF 2
 STAGE 1A

SCALE: 1:50
 DATE: 2/10/06

DRAWN BY: KGP/MAE
 CHECKED BY: MAE/PKG

GO GANDHI AND ASSOCIATES, INC.
 ENGINEERS AND PLANNERS
 6035 N. NORTHWEST HIGHWAY
 SUITE 300
 CHICAGO, ILLINOIS 60631 TEL: (773) 774-5910

PATRICK
 ENGINEERING INC.
 LISLE, ILLINOIS