

STAGE I TRAFFIC CONTROL

FAP ROUTE	SECTION	COUNTY	TOTAL SHEETS	SHEET NO.
685	(39BR)I	FULTON	22	7
STA. TO STA.		EXISTING CONDITIONS:		
		CONTRACT NO. 68497		

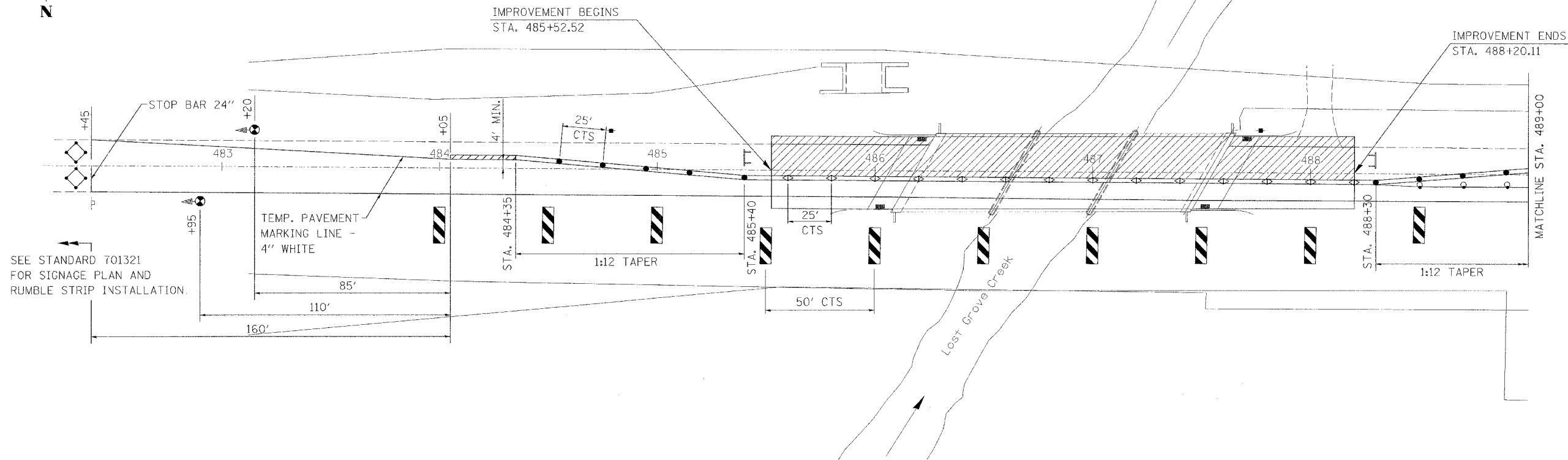

SEE STANDARD 701321 FOR SIGNAGE PLAN AND RUMBLE STRIP INSTALLATION.

SEE STANDARD 701321 FOR SIGNAGE PLAN AND RUMBLE STRIP INSTALLATION

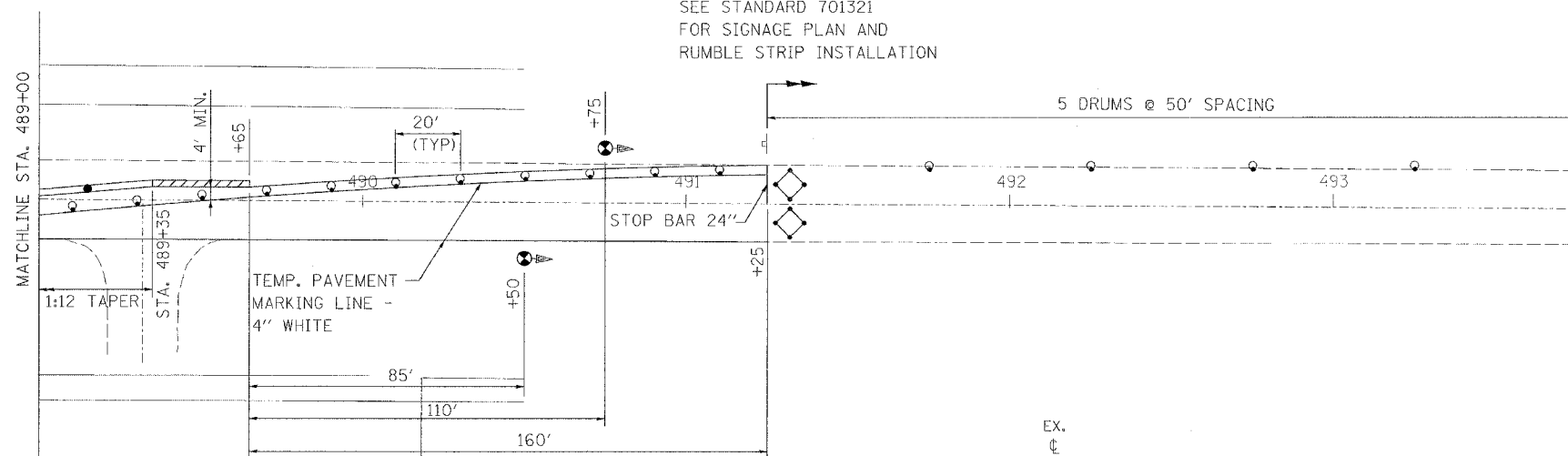

NOTES

TRAFFIC CONTROL SHALL CONFORM TO HIGHWAY STANDARD 701321.

CONTRACTOR TO ADJUST TRAFFIC CONTROL AS NECESSARY TO MAINTAIN ACCESS TO FIELD ENTRANCES.

SYMBOLS

- DRUM WITH STEADY BURNING LIGHT
- ▲ TRAFFIC SIGNAL
- INDUCTION LOOP DETECTOR
- ▨ DOUBLE VERTICAL PANEL
- ◇ TYPE C BIDIRECTIONAL REFLECTOR
- STEADY BURNING LIGHTS AND DOUBLE VERTICAL PANELS
- ▭ TEMPORARY CONCRETE BARRIER
- ▨ IMPACT ATTENUATOR TEMP., (FULLY REDIRECTIVE), TEST LEVEL 2
- ⊥ TYPE III BARRICADE
- ▨ WORK AREA

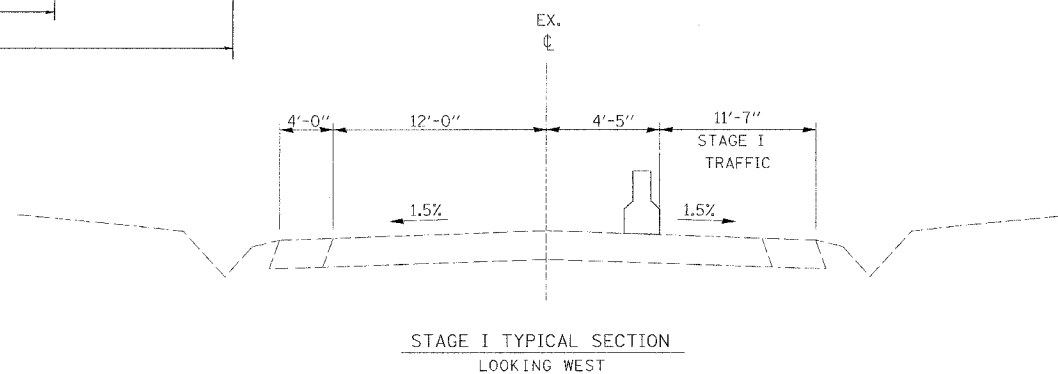

REVISIONS	
NAME	DATE

ILLINOIS DEPARTMENT OF TRANSPORTATION  
 STAGE I TRAFFIC CONTROL  
 STANDARD 701321  
 FAP ROUTE 685  
 SECTION (39BR)I  
 FULTON COUNTY

SCALE: NONE  
 DATE: 2/10/2006

DRAWN BY: KBF  
 CHECKED BY: BWP

\$FILES\$  
 \$DATES\$