

STATE OF ILLINOIS  
DEPARTMENT OF TRANSPORTATION

ROUTE NO.	SECTION	COUNTY	DATE	SHEET NO.	SHEET NO. 6
F.A.P. 685	(39BR)I	FULTON	22	15	13 SHEETS
FED. ROAD DIST. NO. 7	BUILDING	FED. AID PROJECT			

Contract # 68497

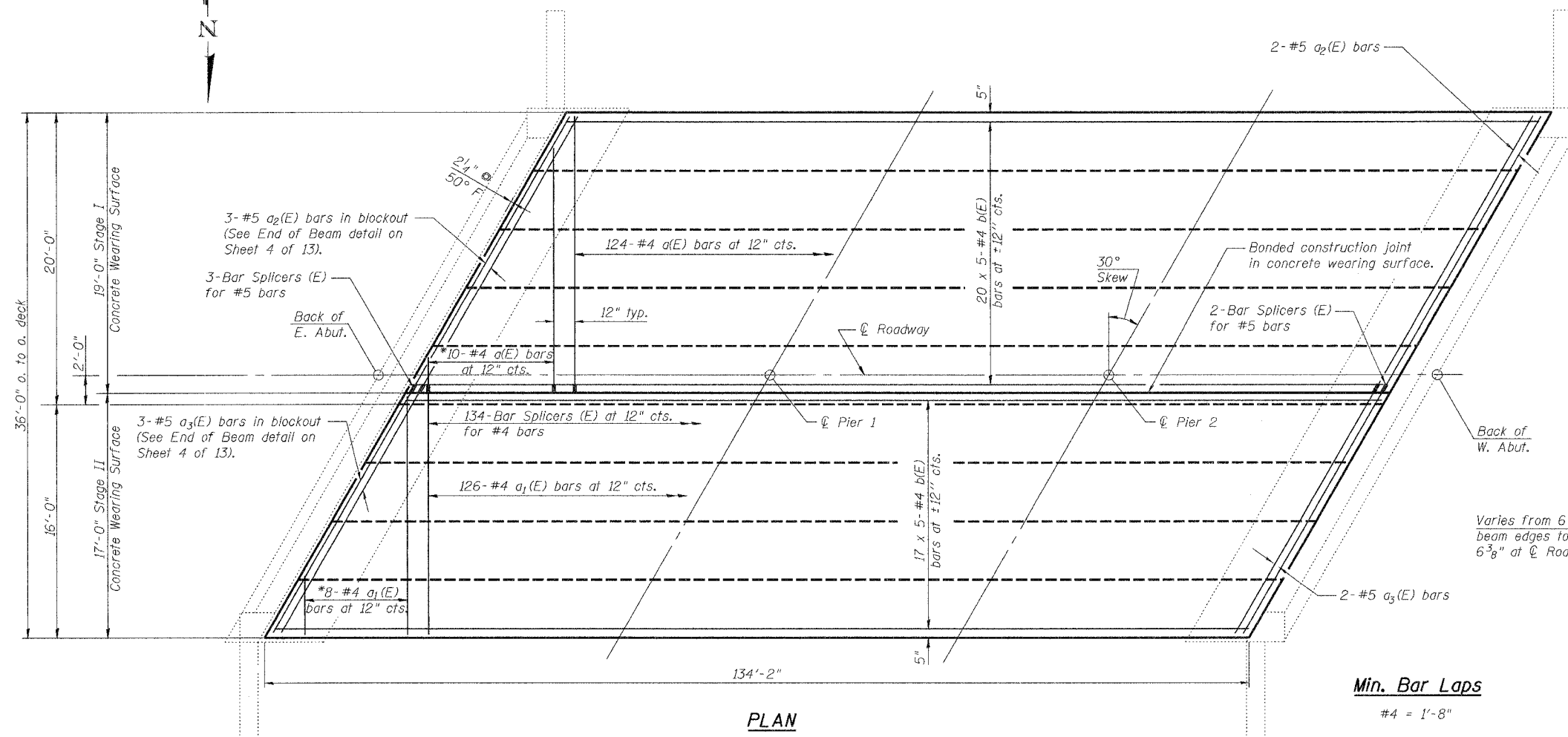

PLAN

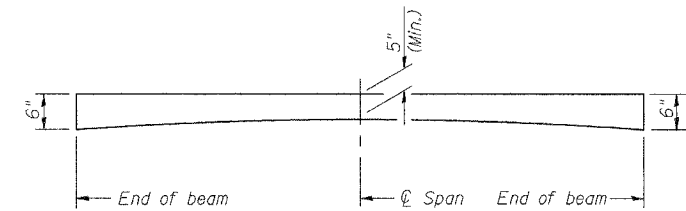

REINFORCED CONCRETE WEARING SURFACE PROFILE  
(Typical all three spans at all locations except Beam 5)

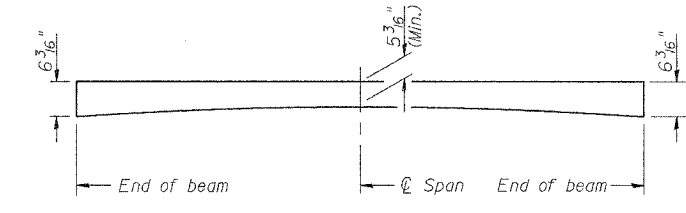

REINFORCED CONCRETE WEARING SURFACE PROFILE  
(Typical all three spans at stage construction line)

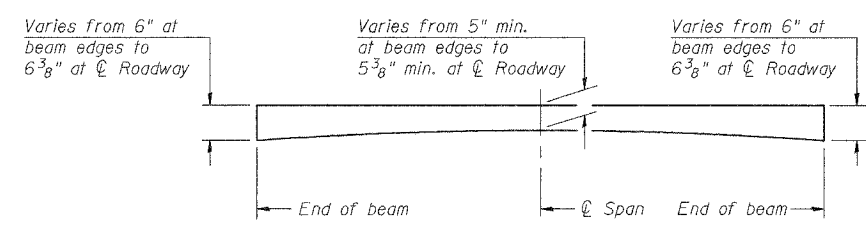

REINFORCED CONCRETE WEARING SURFACE PROFILE  
(Typical all three spans of Beam 5)

\* Order a(E) and a1(E) bars full length. Cut to fit skew and use remainder of bars in opposite end. Ensure hooked end is placed adjacent to outer edge of fascia beam.

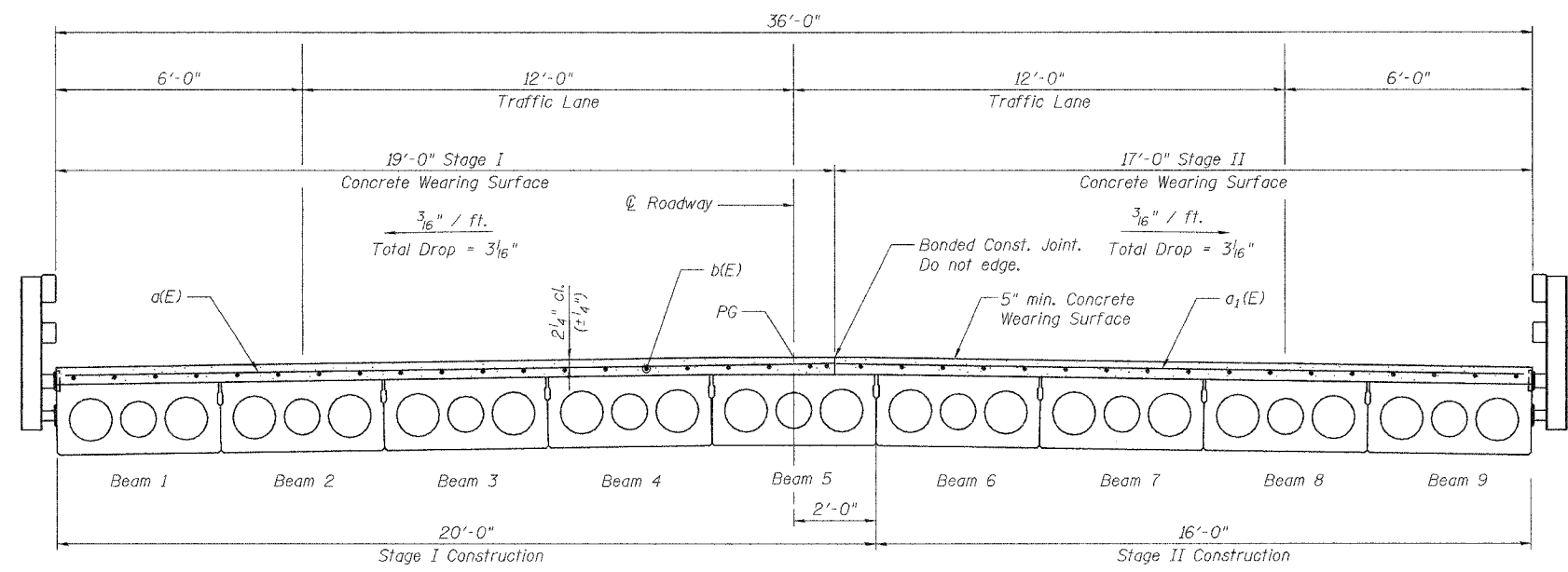

DECK CROSS SECTION  
(Looking Upstation)

SUPERSTRUCTURE  
BILL OF MATERIAL

Bar	No.	Size	Length	Shape	
a(E)	134	#4	19'-0"	C	
a1(E)	134	#4	17'-2"	C	
a2(E)	5	#5	21'-4"	—	
a3(E)	5	#5	19'-3"	—	
b(E)	185	#4	28'-2"	—	
Reinforcement Bars, Epoxy Coated				Pound	6930
Concrete Wearing Surface, 5"				Sq. Yds.	537

Reinforcement bars designated (E) shall be epoxy coated.  
Bars indicated thus 1 x 5-#5 etc. indicates 1 line of bars with 5 lengths per line.

CONCRETE OVERLAY DETAILS  
ILLINOIS ROUTE 9 OVER  
LOST GROVE CREEK  
F.A.P. ROUTE 685 SECTION (39BR)I  
FULTON COUNTY  
SN 029-0052

DESIGNED	BWP
CHECKED	KPC
DRAWN	BWP
CHECKED	KPC