







F.A.P. RTE.	SECTION	COUNTY	TOTAL SHEETS	SHEET NO.
323	(145,146)L	EDGAR	9	4

US RTE 36 & IL RTE 49 LIGHTING PLAN SHEET

LEGEND

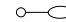
-  LIGHT POLE, ALUMINUM, 40 FT. M.H., 12 FT. DAVIT ARM, 4 EACH
-  LUMINAIRE, SODIUM VAPOR, HORIZONTAL MOUNT, 250 WATT, 4 EACH
-  LIGHT POLE FOUNDATION, 30" DIAMETER, (SEE DETAIL FOR DEPTH)
-  BREAKAWAY DEVICE, COUPLING, WITH STAINLESS STEEL SCREEN, 16 EACH (4 PER POLE)
-  REMOVAL OF EXISTING LIGHTING UNIT, NO SALVAGE, 8 EACH
-  POLE FOUNDATION, REMOVED, 7 EACH
-  REMOVE EXISTING HELIX FOUNDATION, 1 EACH

NOTES

- 1) REPLACE POLES IN THE INTERSECTION AS CLOSE AS POSSIBLE TO THE EXISTING LIGHT POLES. POLE SETBACK AS SHOWN ON SHEET 7.
- 2) POLES #3 & #4 MUST BE LOCATED TO MAINTAIN CLEARANCE TO OVERHEAD POWER LINE
- 3) PROPOSED LIGHTING CONTROLLER PHOTOCELL RELAY SHALL INCLUDE FLASHING BEACON CONTROLS SEE SHEET 5 FOR DETAILS OF FLASHING BEACON

EXIST. CURVE 7
 PI STA. = 6+02.39
 $\Delta = 40^\circ 00' 14''$ (RT)
 D = 5° 10' 13"
 R = 1,108.20'
 T = 403.40'
 L = 773.75'
 E = 71.14'
 e = -----
 T.R. = -----
 S.E. RUN = -----
 P.C. STA. = 1+98.99
 P.T. STA. = 9+72.74

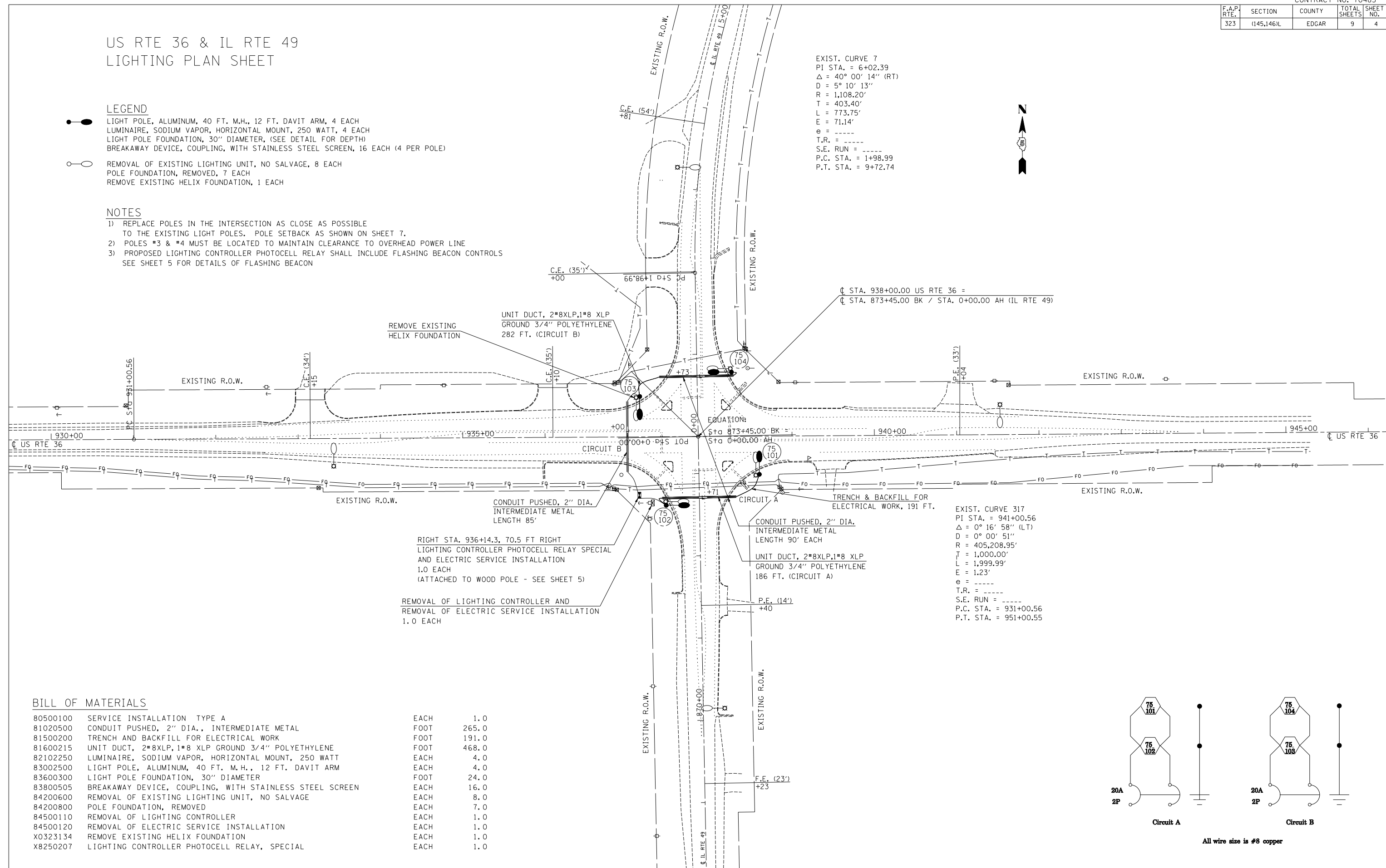

EXIST. CURVE 317
 PI STA. = 941+00.56
 $\Delta = 0^\circ 16' 58''$ (LT)
 D = 0° 00' 51"
 R = 405,208.95'
 T = 1,000.00'
 L = 1,999.99'
 E = 1.23'
 e = -----
 T.R. = -----
 S.E. RUN = -----
 P.C. STA. = 931+00.56
 P.T. STA. = 951+00.55

BILL OF MATERIALS

80500100	SERVICE INSTALLATION TYPE A	EACH	1.0
81020500	CONDUIT PUSHED, 2" DIA., INTERMEDIATE METAL	FOOT	265.0
81500200	TRENCH AND BACKFILL FOR ELECTRICAL WORK	FOOT	191.0
81600215	UNIT DUCT, 2*8XLP,1*8 XLP GROUND 3/4" POLYETHYLENE	FOOT	468.0
82102250	LUMINAIRE, SODIUM VAPOR, HORIZONTAL MOUNT, 250 WATT	EACH	4.0
83002500	LIGHT POLE, ALUMINUM, 40 FT. M.H., 12 FT. DAVIT ARM	EACH	4.0
83600300	LIGHT POLE FOUNDATION, 30" DIAMETER	FOOT	24.0
83800505	BREAKAWAY DEVICE, COUPLING, WITH STAINLESS STEEL SCREEN	EACH	16.0
84200600	REMOVAL OF EXISTING LIGHTING UNIT, NO SALVAGE	EACH	8.0
84200800	POLE FOUNDATION, REMOVED	EACH	7.0
84500110	REMOVAL OF LIGHTING CONTROLLER	EACH	1.0
84500120	REMOVAL OF ELECTRIC SERVICE INSTALLATION	EACH	1.0
X0323134	REMOVE EXISTING HELIX FOUNDATION	EACH	1.0
X8250207	LIGHTING CONTROLLER PHOTOCELL RELAY, SPECIAL	EACH	1.0

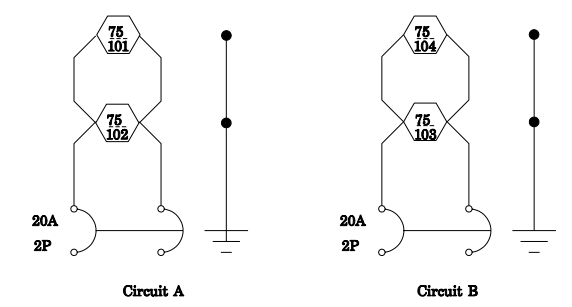

All wire size is #8 copper