

F.A.P. RTE.	SECTION	COUNTY	TOTAL SHEETS	SHEET NO.
315	34-4(4B,B-1)	HANCOCK	452	1

D-96-551-02 +3
CONTRACT NO. 72680 455

STATE OF ILLINOIS
DEPARTMENT OF TRANSPORTATION
DIVISION OF HIGHWAYS

PLANS FOR PROPOSED FEDERAL AID HIGHWAY

F.A.P. ROUTE 315 (IL 336 / US 136)
SECTION 34-4(4B,B-1)
PROJECT: MA-0315(043)
HANCOCK COUNTY
C-96-501-07

FOR INDEX OF SHEETS, SEE SHEET NO. 2

VOLUME 1 OF 2

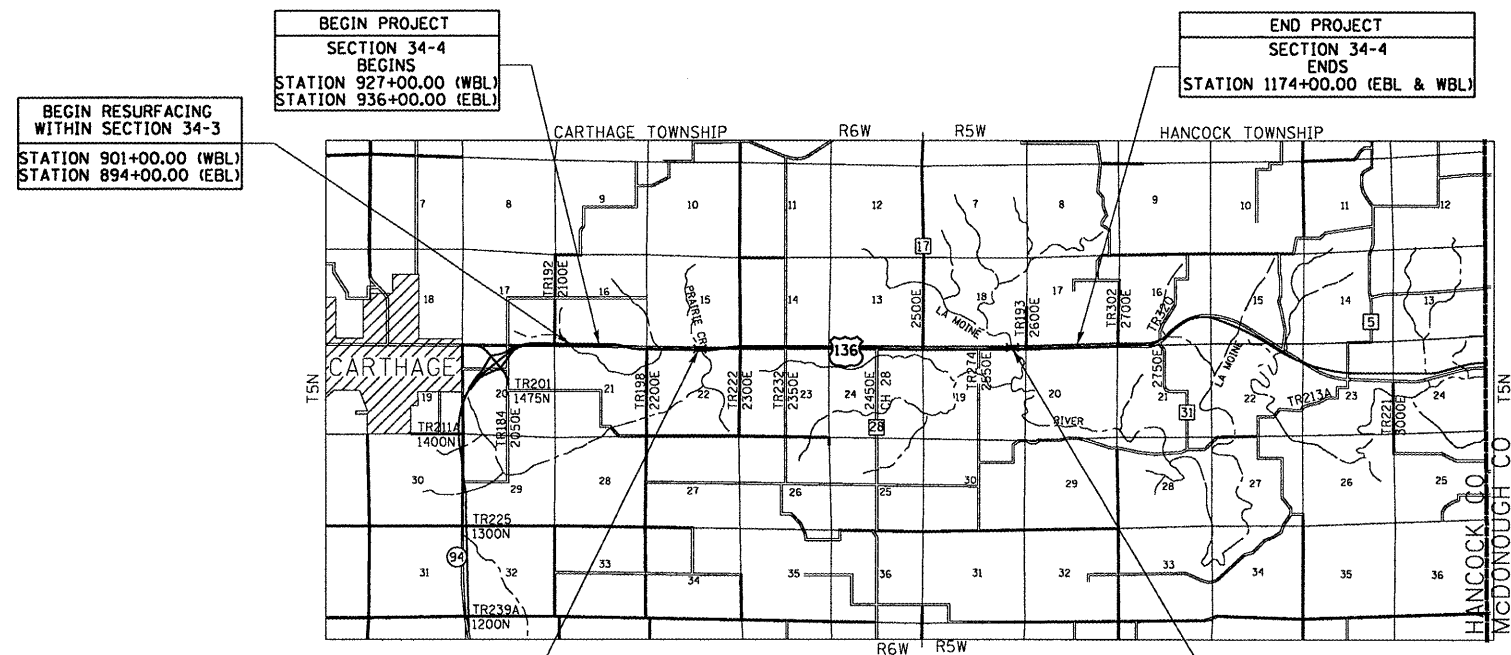
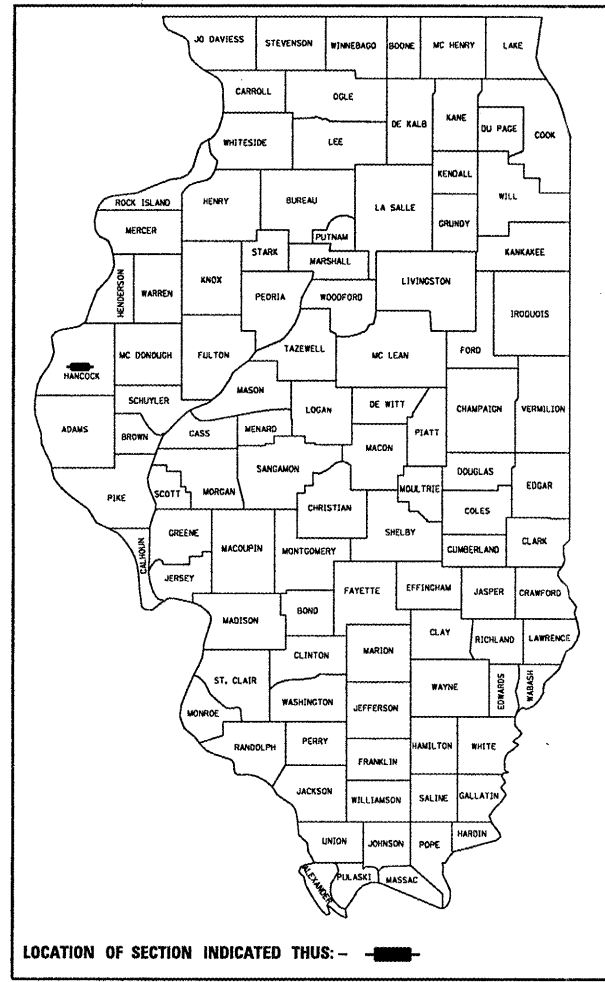

SECTION 34-4B
STATION 973+28.00
SN 034-0506 (WBL)
SN 034-0507 (EBL)
PROPOSED DUAL SINGLE SPAN PPC I-BEAM BRIDGES
WITH RC DECK, INTEGRAL RC SPILL-THRU PILE
BENT ABUTMENTS, 98'-0" BK TO BK ABUTMENTS,
43'-2" OUT TO OUT DECK, SKEW 30° RT AHD

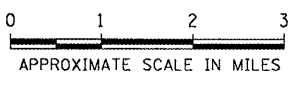

SECTION 34-4B-1
STATION 1153+07.72
SN 034-0508 (WBL)
PROPOSED SIX SPAN CONTINUOUS W-BEAM 43'-2"
O TO O. DECK, 461'-4" BACK TO BACK ABUTMENTS,
PILE SUPPORTED SOLID WALL, PIERS AND PILE
BENT ABUTMENTS, SKEW 15° RIGHT

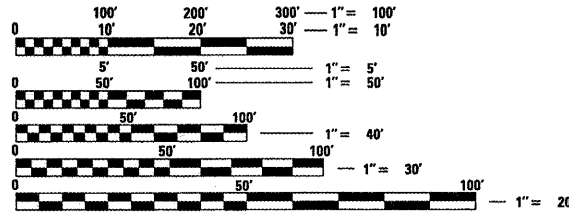

FULL SIZE PLANS HAVE BEEN PREPARED USING STANDARD
ENGINEERING SCALES. REDUCED SIZED PLANS WILL NOT
CONFORM TO STANDARD SCALES. IN MAKING MEASUREMENTS
ON REDUCED PLANS, THE ABOVE SCALES MAY BE USED.

J.U.L.I.E.
JOINT UTILITY LOCATION INFORMATION FOR EXCAVATION
1-800-892-0123

DESIGN DESIGNATION
FAP 315
OTHER PRINCIPAL ARTERIAL
ADT = 4200 (2025)
% SU = 5
% MU = 8

TOTAL LENGTH OF PROJECT = 24,700.00 FEET = 4.678 MILES
NET LENGTH OF PROJECT = 24,700.00 FEET = 4.678 MILES

JAMES R. BURKE
062-050474
REGISTERED
PROFESSIONAL
ENGINEER
STATE OF ILLINOIS

Jack Burke 11/30/07
Exp 11/30/07

ENGINEERS SEAL

STATE OF ILLINOIS
DEPARTMENT OF TRANSPORTATION
DIVISION OF HIGHWAYS

SUBMITTED *February 3, 2006*
Chris M. Reed
DEPUTY DIRECTOR OF HIGHWAYS, REGION FOUR ENGINEER

March 24, 2006
Mike Hine
ENGINEER OF DESIGN AND ENVIRONMENT

March 24, 2006
Milton R. Sees, P.E.
DIRECTOR OF HIGHWAYS, CHIEF ENGINEER

Hutchison Engineering, Inc.
SINCE 1945
1801 West Lafayette
PO Box 820
Jacksonville, Illinois 62651
PHONE : (217)245-7164 FAX (217)243-0468

PRINTED BY THE AUTHORITY OF THE STATE OF ILLINOIS

PROJECT ENGINEER: JOHN C. MEGANGARD (217) 782-6990
SENIOR SQUAD LEADER: MARK DUST (217) 785-0597