

B.M. TA-233: Set chiseled "□" in west end of South concrete handrail of SN 034-0066,
 @ West Fork La Moine River. Elev. 561.06 (171.010 m)

D-96-551-02
CONTRACT NO. 72680

ROUTE NO.	SEC	COUNTY	SECT	SHEET
FAP 315	*	HANCOCK	452	199
FED. ROAD DIST. NO. 7	ILLINOIS	PROJECT	* 34-4B-1	

SHEET NO. 1
 34 SHEETS

EXISTING STRUCTURE:
 SN 034-0066 will be the (EBL) after construction of proposed structure. Traffic to be maintained on existing alignment during construction. Existing structure to remain in place.

Traffic Barrier Terminal
 Std. 631026, Type 6
 (All Corners)

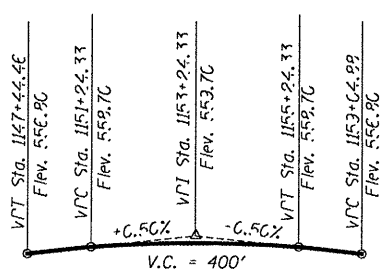
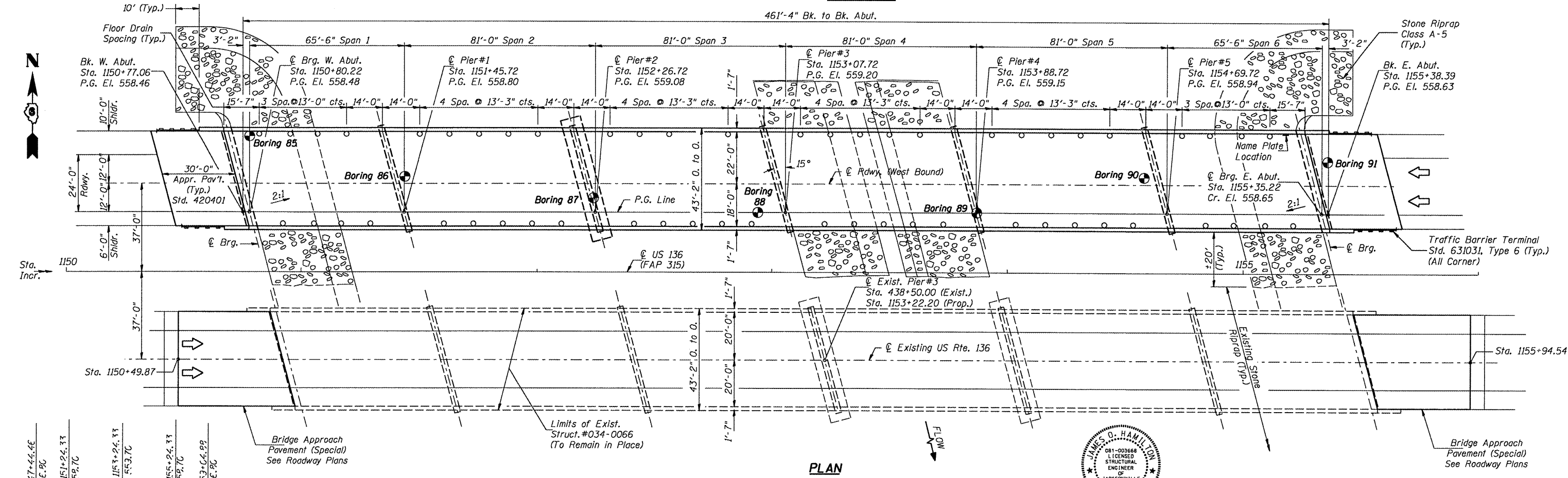
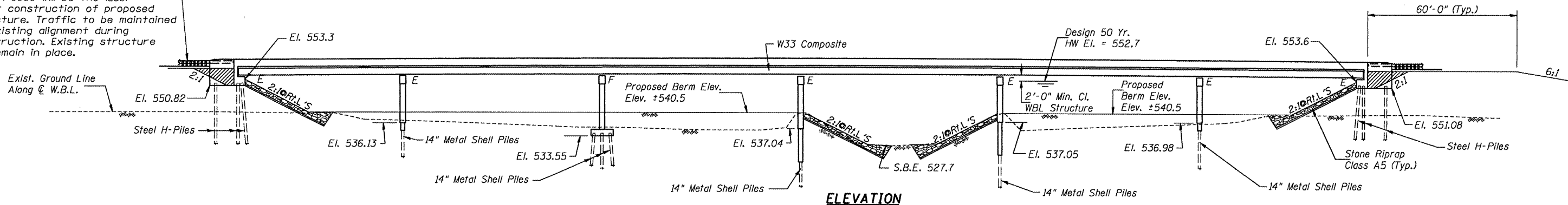

DESIGNED	JOH
CHECKED	BRT
DRAWN	TC
CHECKED	JOH

WATERWAY INFORMATION
 Drainage Area = 310.1 Sq. Mi., Low Grade Elev. = 555.80 @ Sta. 1163+04.88

Flood	Freq. Yr.	Q C.F.S.	Opening Sq. ft.		Nat. H.W.E. ft.	Head - ft.		Headwater Elev. - ft.	
			Exist.	Prop.		Exist.	Prop.	Exist.	Prop.
Design	50	19,703	5,867	5,871	552.72	0.39	0.40	553.11	553.12
Base	100	22,706	6,290	6,290	554.33	0.36	0.36	554.69	554.69
Overtopping	165	25,000	6,290	6,290	555.49	0.41	0.41	555.90	555.90
Max. Calc.	500	29,951	6,290	6,290	557.70	0.08	0.08	557.78	557.78

DESIGN SPECIFICATIONS
 1996 AASHTO with 1997 thru 2002 Interims

DESIGN STRESSES
 (FIELD UNITS)
 f'c = 3,500 p.s.i.
 fy = 60,000 p.s.i. (Reinforcement)
 fy = 50,000 p.s.i. (Structural Steel)
 (AASHTO M270 Grade 50W)

LOADING HS20-44
 Allow 50*/sq. ft. future wearing surface.

SEISMIC DATA
 Seismic Performance Category (SPC) = A
 Bedrock Acceleration Coefficient (A) = 0.040g
 Site Coefficient (S) = 1.0

James D. Hamilton
 3/16/2006
 Expires 11/30/2006

APPROVED
 FOR STRUCTURAL ADEQUACY ONLY
Ralph E. Anderson
 ENGINEER OF BRIDGES AND STRUCTURES

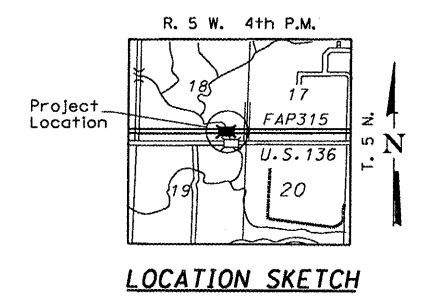

GENERAL PLAN
 US ROUTE 136 OVER
 LA MOINE RIVER
 FAP ROUTE 315 SECTION 34-4B-1
 HANCOCK COUNTY
 STATION 1153+07.72
 STR. NO. 034-0508 (WBL)

HUTCHISON ENGINEERING, INC.
 JACKSONVILLE, ILLINOIS
 Date: January 31, 2006