

F.A.S. RTE.	SECTION	COUNTY	TOTAL SHEETS	SHEET NO.
1808	(1)RS-2	LAWRENCE	15	1

STATE OF ILLINOIS
DEPARTMENT OF TRANSPORTATION
DIVISION OF HIGHWAYS

**PROPOSED
HIGHWAY PLANS**

FAS ROUTE 1808 (OLD US 50)
SECTION (1)RS-2
LAWRENCE COUNTY

C-97-076-04

D-97-038-04

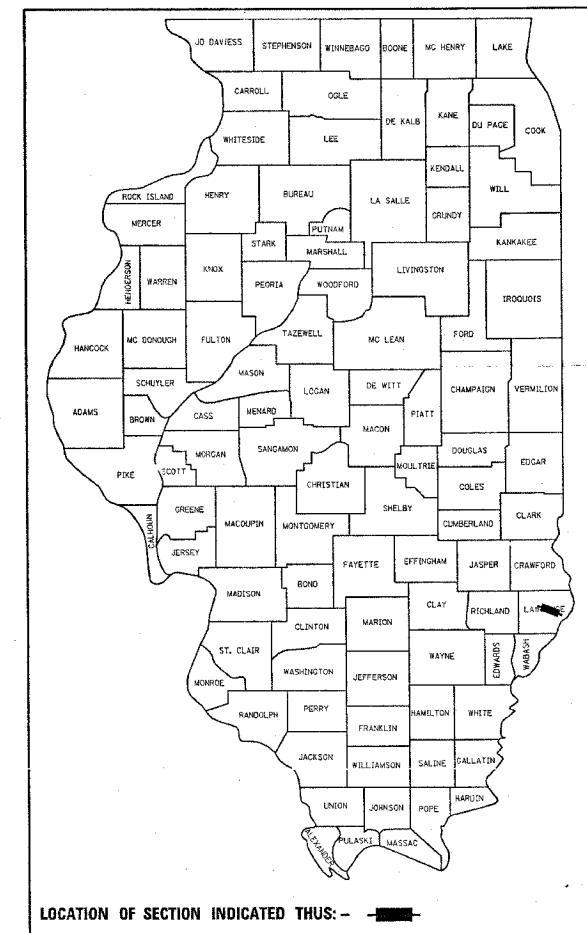

LOCATION OF SECTION INDICATED THUS: —■—

FOR INDEX OF SHEETS, SEE SHEET NO. 2

STRUCTURE OMISSIONS

STATION	TO	STATION
75+32.26	TO	78+41.24
163+95	TO	164+65
200+35	TO	200+95
248+91	TO	249+48
309+34	TO	309+78
343+76	TO	343+98

R 10 W

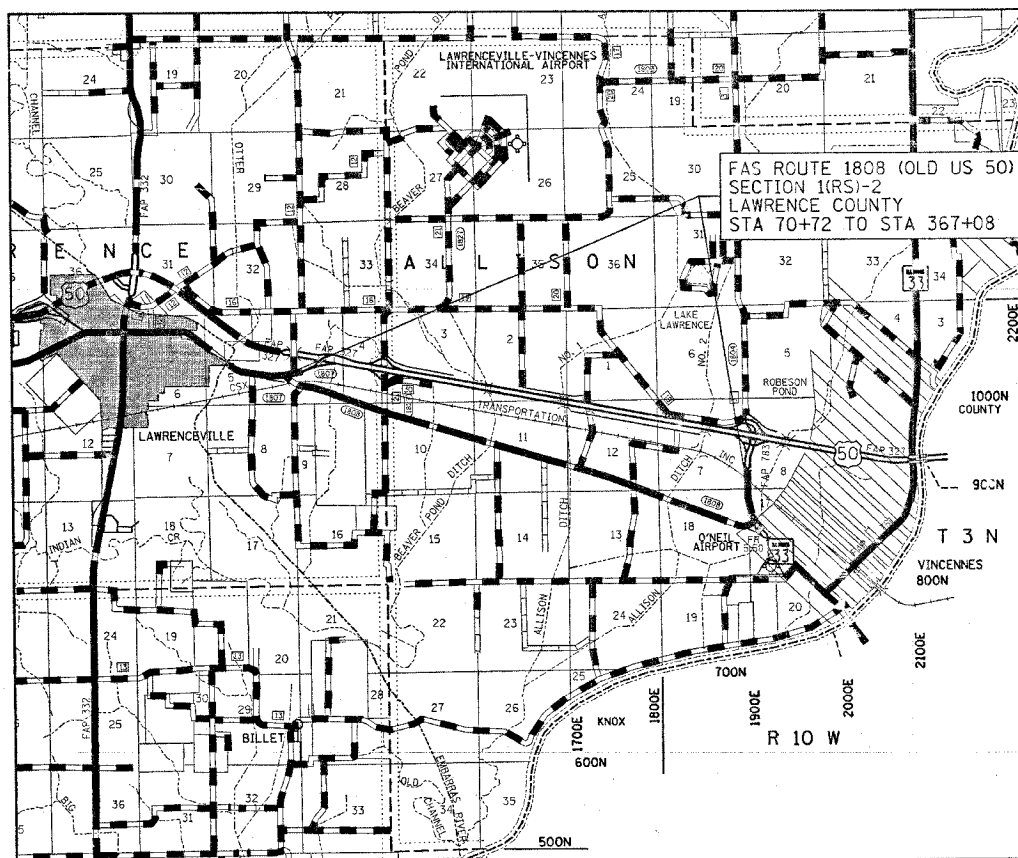

2003 ADT = 3750

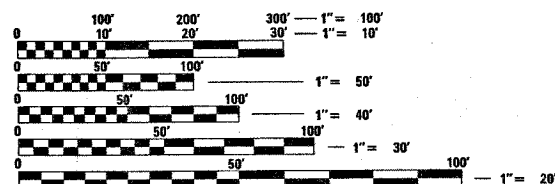

FULL SIZE PLANS HAVE BEEN PREPARED USING STANDARD ENGINEERING SCALES. REDUCED SIZED PLANS WILL NOT CONFORM TO STANDARD SCALES. IN MAKING MEASUREMENTS ON REDUCED PLANS, THE ABOVE SCALES MAY BE USED.

J.U.L.I.E.
JOINT UTILITY LOCATION INFORMATION FOR EXCAVATION
1-800-892-0123

PROJECT ENGINEER: BILL STANLEY
SQUAD LEADER: MYRA OLTMAN
DESIGNER: KAREN THOLE
TELEPHONE: (217) 342-3951 EXT: 314

STATE OF ILLINOIS
DEPARTMENT OF TRANSPORTATION
DIVISION OF HIGHWAYS

SUBMITTED Oct 17 20 05
Christina M. Deardorff
DEPUTY DIRECTOR OF HIGHWAYS, REGION ENGINEER

December 9, 20 05
Mike Nune
ENGINEER OF DESIGN AND ENVIRONMENT

December 9, 20 05
Eric Harshbarger
DEPUTY DIRECTOR OF HIGHWAYS, CHIEF ENGINEER

PRINTED BY THE AUTHORITY
OF THE STATE OF ILLINOIS

CONTRACT NO. 74058 TOWNSHIP: ALLISON

GROSS LENGTH = 29,636 FEET 5.60 MILES
NET LENGTH = 29,074 FEET 5.50 MILES