

| F.A. RTE. | SECTION | COUNTY | TOTAL SHEETS | SHEET NO. |
|-----------|---------|--------|--------------|-----------|
| • | •• | ••• | 5 | 4 |

| STA. | TO STA. |
|---------------------|---------------------------|
| FED. ROAD DIST. NO. | ILLINOIS FED. AID PROJECT |

- FAU ROUTE 8413 & FAP ROUTE 2796
- D7 FLASHING BEACON 2006-1
- FAYETTE & EFFINGHAM

BILL OF MATERIALS
FAU 8413 (US 40) & IL 185 IN VANDALIA

| ITEM | UNIT | QUANTITY |
|---|------|----------|
| SERVICE INSTALLTION, TYPE A | EACH | 1.0 |
| TRAFFIC SIGNAL WOOD POLE, 35 FT., CLASS 3 | EACH | 1.0 |
| TRAFFIC SIGNAL WOOD POLE, 40 FT., CLASS 3 | EACH | 1.0 |
| CONDUIT ATTACHED TO STRUCTURE, 1 1/2" DIA., GALVANIZED STEEL | FOOT | 18.0 |
| FLASHER CONTROLLER | EACH | 1.0 |
| SPAN WIRE | FOOT | 115.0 |
| TETHER WIRE | FOOT | 115.0 |
| ELECTRIC CABLE AERIAL SUSPENDED, SIGNAL, NO. 14 5C | FOOT | 83.0 |
| REMOVE EXISTING FLASHING BEACON INSTALLATION COMPLETE | EACH | 1.0 |
| SIGNAL HEAD, POLYCARBONATE, LED, 4-FACE, 1-SECTION, SPAN WIRE MOUNTED | EACH | 2.0 |

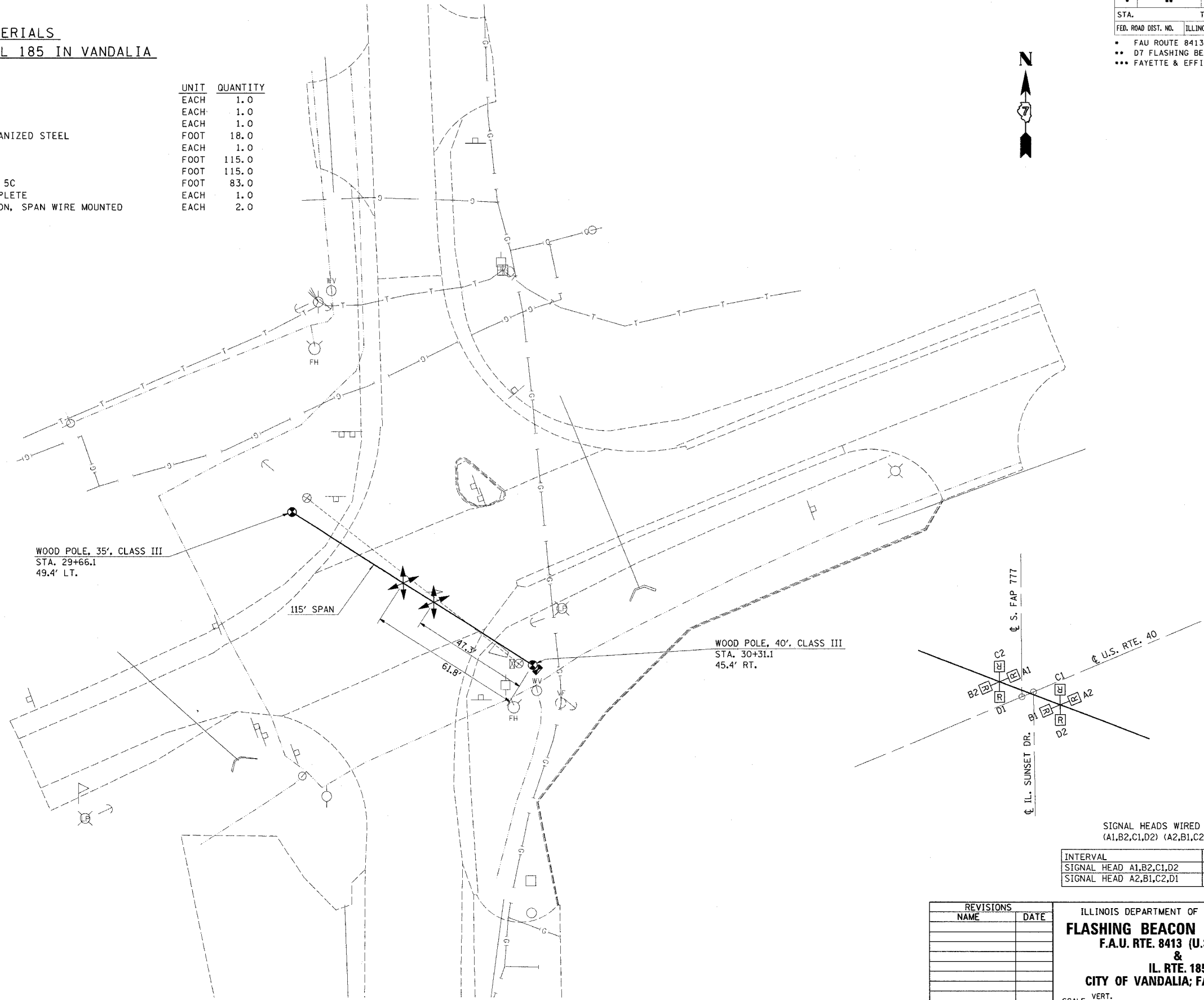

- LEGEND**
- ⊗ EXISTING WOOD POLE
 - ⊗ EXISTING LIGHT POLE
 - ⊗ EXISTING CONTROLLER & CABINET
 - ⊗ EXISTING SIGNAL HEAD
 - ⊗ PROPOSED FLASHER CONTROLLER
 - ⊗ PROPOSED SIGNAL HEAD
 - ⊗ PROPOSED WOOD POLE

| INTERVAL | 1 | 2 |
|-------------------------|------|------|
| SIGNAL HEAD A1,B2,C1,D2 | R | DARK |
| SIGNAL HEAD A2,B1,C2,D1 | DARK | R |

| REVISIONS | |
|-----------|------|
| NAME | DATE |
| | |
| | |
| | |
| | |
| | |
| | |
| | |
| | |
| | |
| | |

ILLINOIS DEPARTMENT OF TRANSPORTATION
FLASHING BEACON MODERIZATION
F.A.U. RTE. 8413 (U.S. RTE. 40)
 &
IL. RTE. 185
CITY OF VANDALIA; FAYETTE COUNTY

SCALE: VERT. _____ DRAWN BY _____
 HORIZ. _____ CHECKED BY _____
 DATE _____

PLOT DATE = 2/10/2006
 FILE NAME = #FILE#
 SCALE = _____
 USER NAME = #USER#