

STATE OF ILLINOIS  
DEPARTMENT OF TRANSPORTATION

\*D-7 JOINT REPAIRS 2006-3

ROUTE NO.	SECTION	COUNTY	TOTAL SHEETS	SHEET NO.
FAP 116	#	RICHLAND	31	21
STA.	TO STA.			
FED. ROAD DIST. NO.	ILLINOIS	FED. AID PROJECT		
DWS. NO. 3 OF 6				

CONTRACT NO. 74120

**NOTE**

1. See Drawing No. 4 of 6 for Sections and additional Details.

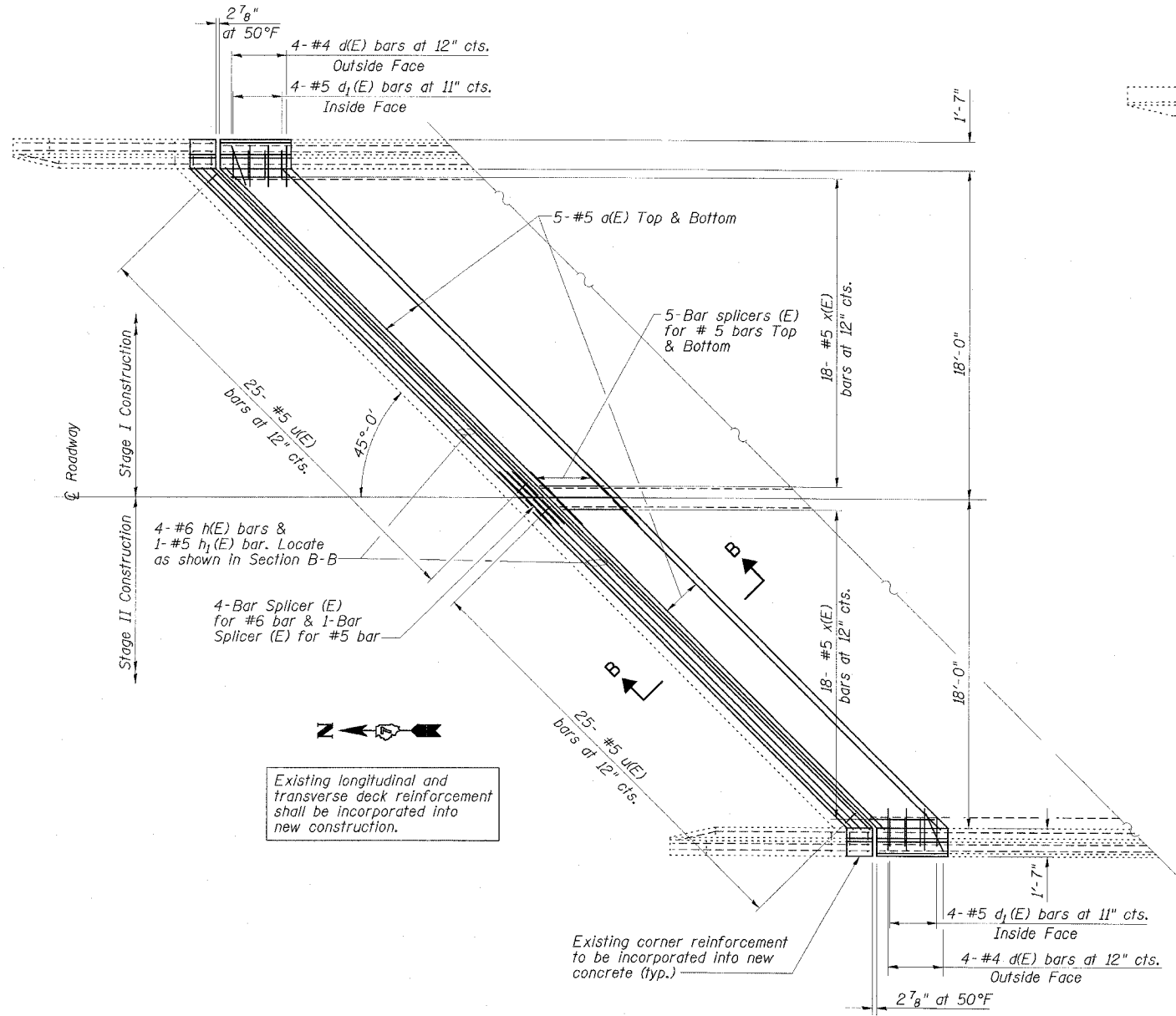

**PROPOSED PARTIAL PLAN**  
(North Abutment shown; South Abutment similar)

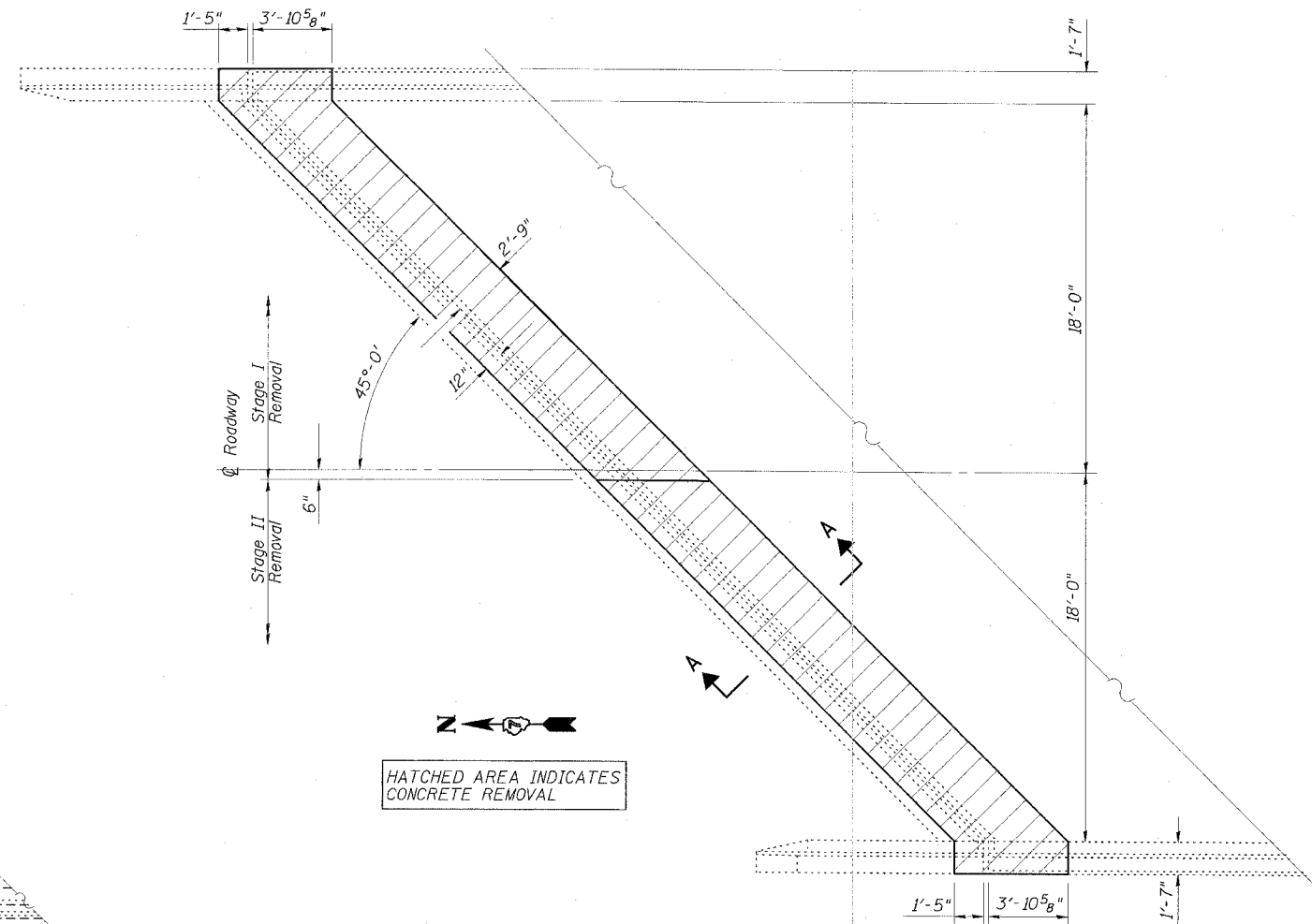

**EXISTING PARTIAL PLAN**  
(North Abutment shown; South Abutment similar)

**ESCA**  
CONSULTANTS, INC.

DESIGNED BY:	MTD	11/05
DRAWN BY:	HAG	11/05
CHECKED BY:	MTD	11/05
APPROVED BY:	RDP	1/06

**EXPANSION JOINT REPLACEMENT DETAILS**  
**IL 130 OVER LONG BRANCH CREEK**  
**FAP RTE 116 (IL 130)**  
**D-7 JOINT REPAIRS 2006-3**  
**RICHLAND COUNTY**  
**STATION 745+75.00**  
**STRUCTURE NO. 080-0021**