

F.A. RTE.	SECTION	COUNTY	TOTAL SHEETS	SHEET NO.
103	27-1R	ST. CLAIR	382	53
STA. 135+00.00		TO STA. 147+00.00		
FED. ROAD DIST. NO. ILLINOIS FED. AID PROJECT				
CONTRACT NO. 76300				

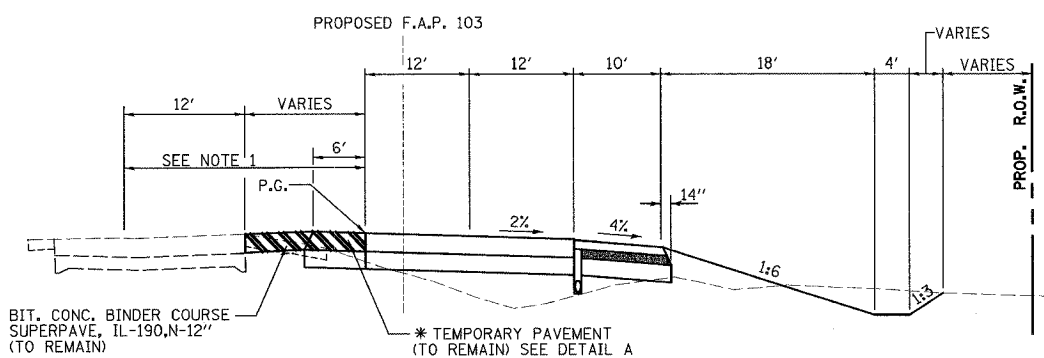

TEMPORARY MEDIAN CROSSOVER

STATION 148+82.70 TO 158+50
* STATION 160+00.00 TO 162+50.00 LT.

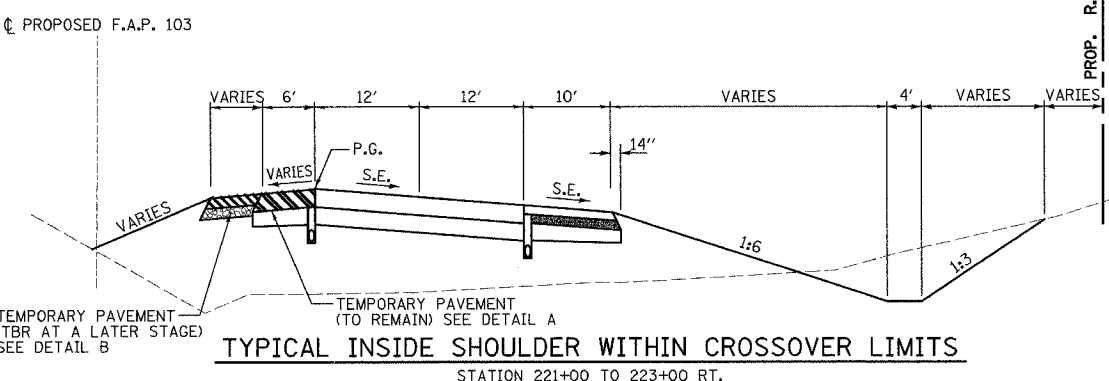

TYPICAL INSIDE SHOULDER WITHIN CROSSOVER LIMITS

STATION 221+00 TO 223+00 RT.

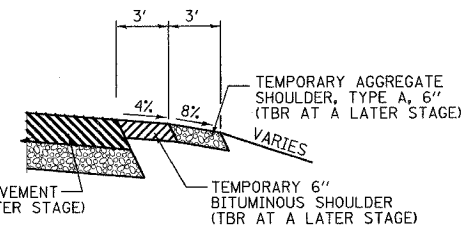

TEMPORARY PAVEMENT TAPER

STATION 223+00 TO 226+50 RT.
STATION 263+00 TO 266+50 RT.
STATION 286+52.84 TO 290+12.71 LT. (NO AGG. SHDR.)

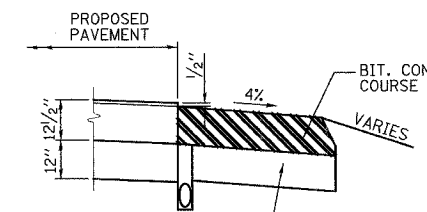

TEMPORARY PAVEMENT (TO REMAIN)

DETAIL A

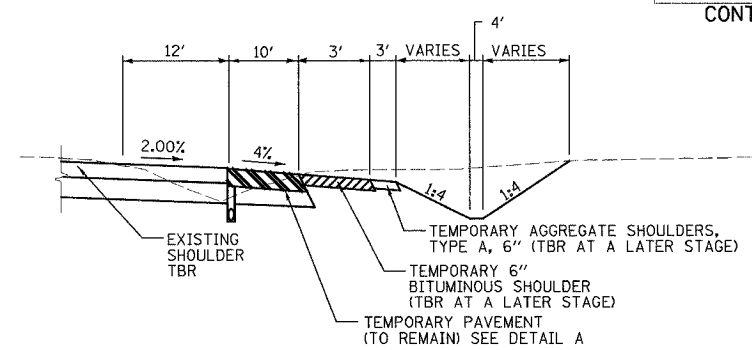

WIDENING FOR CULVERT INSTALLATIONS

STATION 211+00 TO 221+00 RT.
STATION 296+80 TO 304+76.90 RT. (NO AGG. SHDR.)

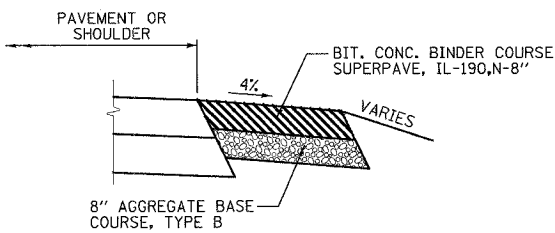

TEMPORARY PAVEMENT (TO BE REMOVED AT A LATER STAGE)

DETAIL B

- NOTES:**
1. PRIOR TO CONSTRUCTING STAGE 2, PLACE BIT. CONC. BINDER WEDGE TRANSITION ON EXISTING EAST BOUND LANE FROM STA. 159+00 TO STA. 164+00 TO MATCH NORTH EDGE OF PROPOSED LEFT-TURN LANE (STAGE 1A).
 2. PRIOR TO CONSTRUCTING PROPOSED IMPROVEMENTS, MILL EXISTING PAVEMENT AT ALL LOCATIONS WHERE THE PROPOSED PAVEMENT WIDENING EXCEEDS 2 FEET IN WIDTH AND WHERE PROPOSED CONCRETE CURBS OR MEDIANS ARE DOWELLED TO THE EXISTING PAVEMENT.
 3. FINAL SURFACE COURSE PLACEMENT ON THE PAVEMENT AND FINAL 2" LIFT ON THE SHOULDER TO OCCUR IN STAGE 4.

STAGE 1

DIVERT EASTBOUND TRAFFIC TO THE NORTH EAST OF GREEN MOUNT ROAD AND CONSTRUCT THE NEW EASTBOUND LANES AND ACCESS ROADS FROM PROJECT BEGINNING TO STA. 223+00. WITH TRAFFIC ON EXISTING PAVEMENT, CONSTRUCT THE NEW WESTBOUND LANES AND ACCESS ROADS FROM STA. 223+00 TO STA. 265+10 AND EASTBOUND LANES AND ACCESS ROADS FROM STA. 266+50 TO STA. 290+00. WIDEN THE WEST SIDE OF THE EXISTING PAVEMENT FROM STA. 290+00 TO STA. 338+10. CONSTRUCT TEMPORARY PAVEMENT FOR CROSS-OVERS AT STATIONS 150+00, 160+00, 223+00, 265+00 AND AT STATIONS 215+55.78, 288+32.00, AND 300+81.00 FOR CULVERT INSTALLATIONS. CONSTRUCT PAVEMENT CONNECTION FROM EXISTING PAVEMENT TO THE CENTERLINE OF FAP 103 FOR NEW ACCESS ROADS AT STATIONS 163+20 RIGHT, 180+56, 206+36, 232+13, 251+78, AND 276+84. CONSTRUCT CULVERTS AT STA. 328+17 AND 333+85 WITH ONE-LANE TRAFFIC AND FLAGGERS DURING DAY-TIME OPERATION ONLY.

REFER TO SHEETS 76 THROUGH 82 FOR TRAFFIC CONTROL PLANS FOR STAGE 1 CONSTRUCTION.

GENERAL NOTES:

THE CONTRACTOR SHALL MAINTAIN TEMPORARY ACCESS TO ALL ADJACENT PROPERTIES, PRIVATE DRIVES AND PUBLIC ROADWAYS THROUGHOUT THE LENGTH OF THE CONSTRUCTION CONTRACT. ALL EARTHWORK AND SUBGRADE PREPARATION REQUIRED FOR MAINTAINING TEMPORARY ACCESS WILL NOT BE MEASURED AND PAID FOR SEPARATELY BUT SHALL BE CONSIDERED INCLUDED IN THE CONTRACT UNIT PRICE PER TON FOR AGGREGATE FOR TEMPORARY ACCESS.

REMOVAL OF TEMPORARY ACCESS MATERIALS INCLUDING: TEMPORARY AGGREGATE, ACCESS PIPE CULVERTS AND EARTH EMBANKMENTS WILL NOT BE MEASURED AND PAID FOR SEPARATELY BUT SHALL BE CONSIDERED INCLUDED IN THE CONTRACT UNIT PRICE PER TON FOR AGGREGATE FOR TEMPORARY ACCESS, PER FOOT FOR PIPE CULVERTS (TEMPORARY) AND PER CUBIC YARD FOR EARTH EXCAVATION.

THE CONTRACTOR SHALL MAINTAIN DRAINAGE BY CONSTRUCTING TEMPORARY DITCHES AND CULVERTS AS SHOWN ON THE PLANS AND CROSS SECTIONS AND AS NECESSARY TO AVOID FLOODING OF ROADWAY AND ADJACENT PROPERTIES.

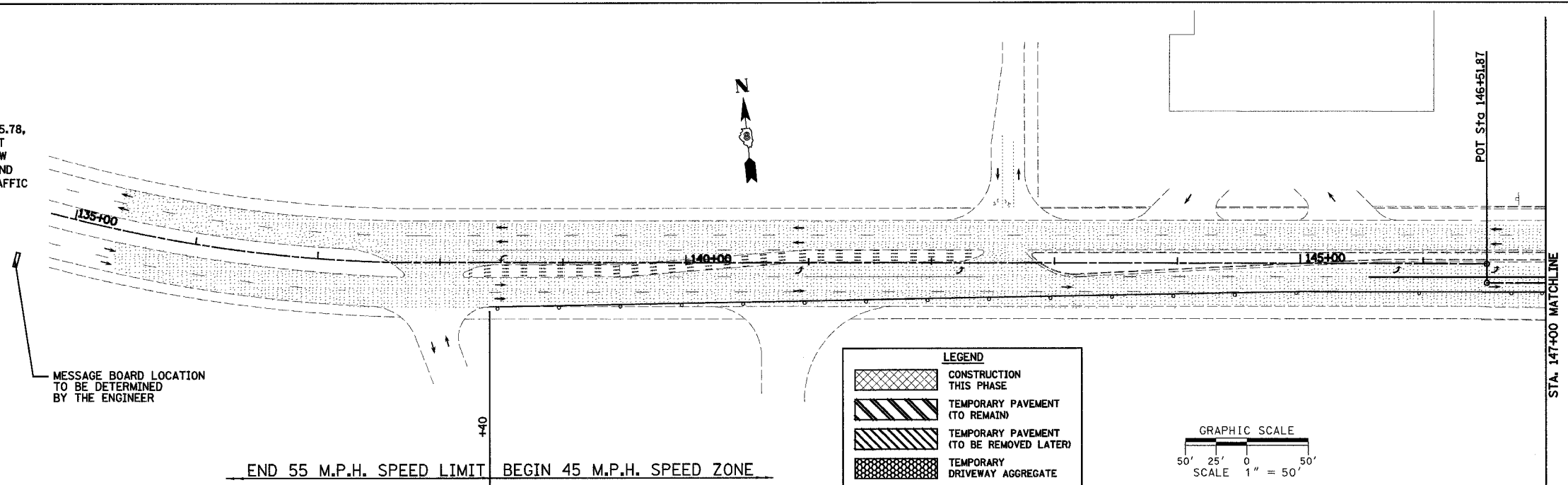

LEGEND

[Cross-hatched pattern]	CONSTRUCTION THIS PHASE
[Diagonal lines /]	TEMPORARY PAVEMENT (TO REMAIN)
[Diagonal lines \]	TEMPORARY PAVEMENT (TO BE REMOVED LATER)
[Stippled pattern]	TEMPORARY DRIVEWAY AGGREGATE
[Dotted pattern]	EXISTING PAVEMENT
[Arrow]	DIRECTION OF TRAFFIC FLOW THIS STAGE
[T-shaped symbol]	TYPE III BARRICADE
[Circle with cross]	DRUM OR BARRICADE W/ STEADY BURN LIGHTS
[Dashed line]	TEMPORARY DITCH
[Solid line]	PROPOSED DITCH

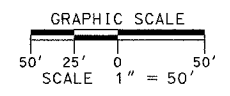

REVISIONS	
NAME	DATE

ILLINOIS DEPARTMENT OF TRANSPORTATION

CONSTRUCTION PLAN - STAGE 1

SHEET 1 OF 7 SHEETS

F.A.P. 103 (IL. RTE. 13/15)

SECTION 27-1R - ST. CLAIR CO.

SCALE: 1" = 50'

DATE: February 11, 2005

DRAWN BY: CRO

CHECKED BY: RCY

DATE	BY	REVISION

DATE	BY	REVISION