

F.A. RTE.	SECTION	COUNTY	TOTAL SHEETS	SHEET NO.
103	27-1R	ST. CLAIR	382	63
STA. 211+00.00		TO STA. 243+00.00		
FED. ROAD DIST. NO. ILLINOIS FED. AID PROJECT				
CONTRACT NO. 76300				

DATE	BY
SURVEYED	BY
NOTE BOOK	NO.
ALIGNED	
CHECKED	
BY	
DATE	
FILE NAME	

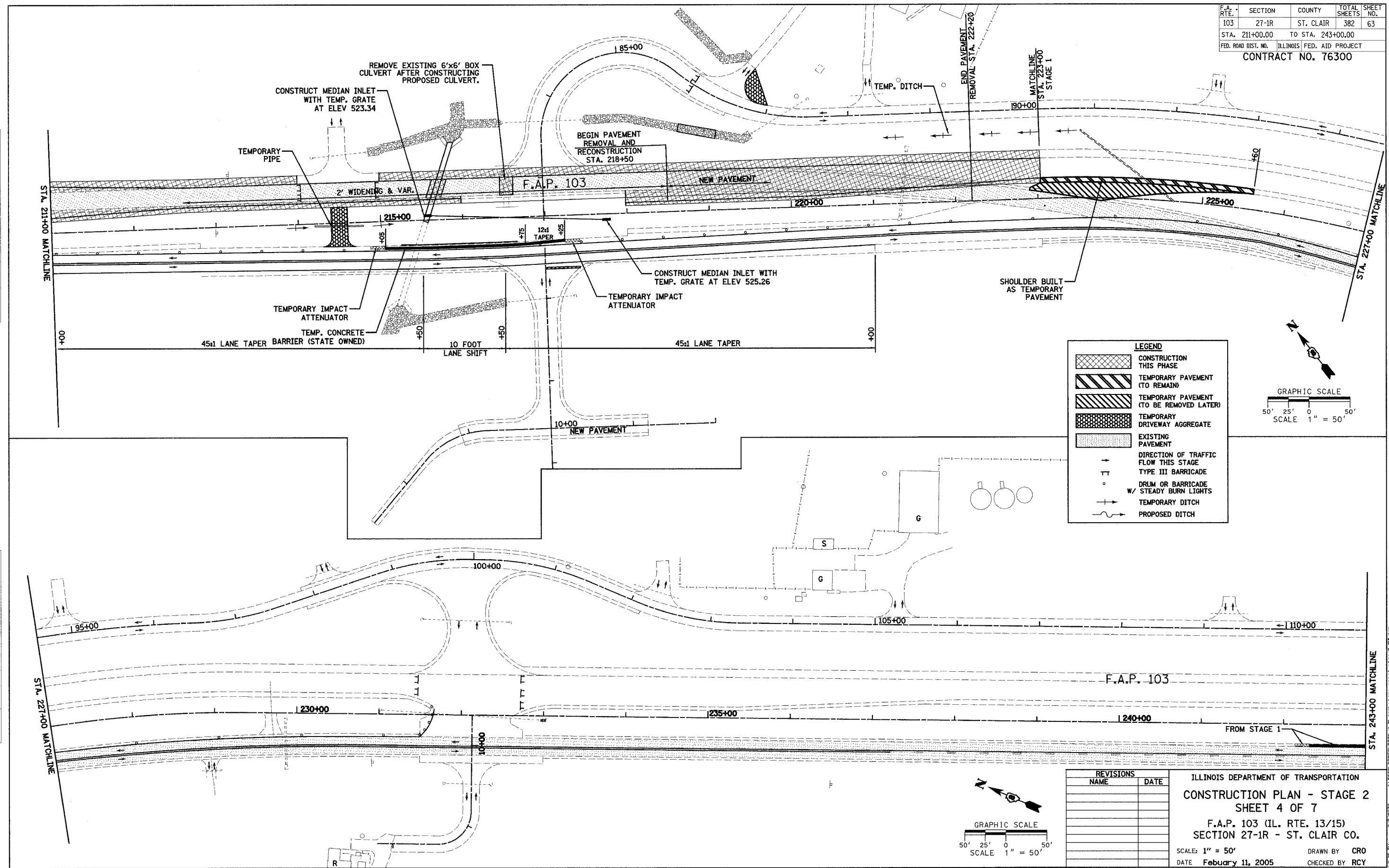

DATE	BY
SURVEYED	BY
NOTE BOOK	NO.
ALIGNED	
CHECKED	
BY	
DATE	
FILE NAME	

LEGEND

- CONSTRUCTION THIS PHASE
- TEMPORARY PAVEMENT (TO REMAIN)
- TEMPORARY PAVEMENT (TO BE REMOVED LATER)
- TEMPORARY DRIVEWAY AGGREGATE
- EXISTING PAVEMENT
- DIRECTION OF TRAFFIC FLOW THIS STAGE
- TYPE III BARRICADE
- DRUM OR BARRICADE W/ STEADY BURN LIGHTS
- TEMPORARY DITCH
- PROPOSED DITCH

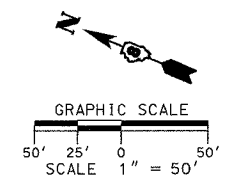
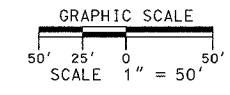

REVISIONS	NAME	DATE

ILLINOIS DEPARTMENT OF TRANSPORTATION
CONSTRUCTION PLAN - STAGE 2
SHEET 4 OF 7
 F.A.P. 103 (IL. RTE. 13/15)
 SECTION 27-1R - ST. CLAIR CO.
 SCALE: 1" = 50'
 DATE: February 11, 2005
 DRAWN BY: CRO
 CHECKED BY: RCY