

F.A. RTE.	SECTION	COUNTY	TOTAL SHEETS	SHEET NO.
103	27-1R	ST. CLAIR	382	67
STA. 135+00.00		TO STA. 147+00.00		
FED. ROAD DIST. NO. ILLINOIS FED. AID PROJECT				
CONTRACT NO. 76300				

DATE	BY
DATE	BY
DATE	BY

DATE	BY
DATE	BY
DATE	BY

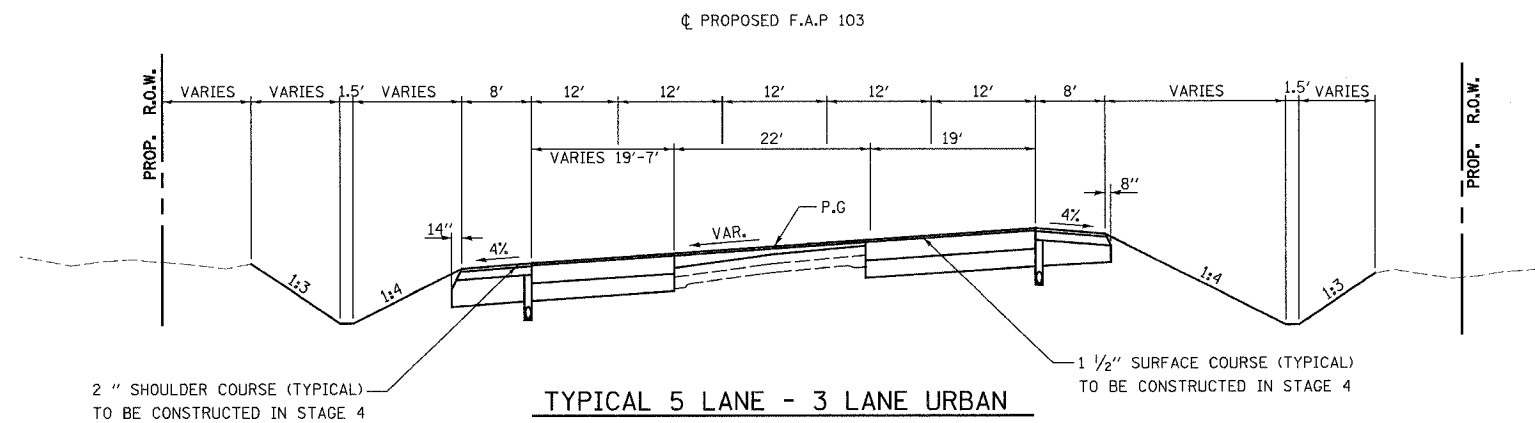

TYPICAL 5 LANE - 3 LANE URBAN

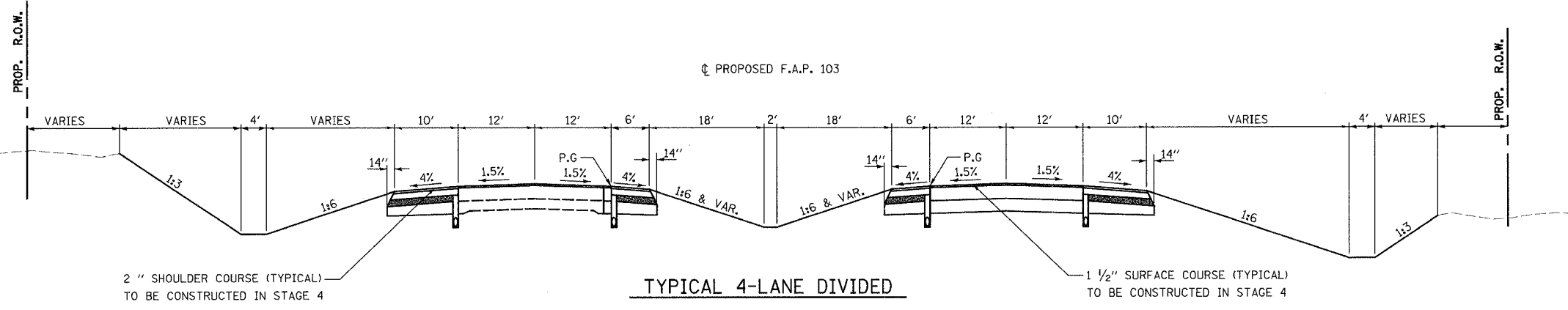

TYPICAL 4-LANE DIVIDED

NOTES:

- MILL EXISTING PAVEMENT AT ALL LOCATIONS WHERE THE PROPOSED PAVEMENT WIDENING EXCEEDS 2 FEET IN WIDTH AND WHERE PROPOSED CONCRETE CURBS OR MEDIANS ARE DOWELLED TO THE EXISTING PAVEMENT PRIOR TO CONSTRUCTING PROPOSED IMPROVEMENTS.
- FINAL SURFACE COURSE PLACEMENT ON THE PAVEMENT AND FINAL 2" LIFT ON THE SHOULDER TO OCCUR IN STAGE 4.

STAGE 3

DIVERT TRAFFIC TO OUTSIDE LANES OF PROPOSED EASTBOUND AND WESTBOUND PAVEMENTS FROM STA. 153+92 TO STA. 162+50 AND THE OUTSIDE LANE OF PROPOSED EASTBOUND PAVEMENT FROM STA. 212+80 TO 218+00 TO ALLOW TEMPORARY PAVEMENT REMOVAL AND MEDIAN WORK IN THESE AREAS. MAINTAIN TRAFFIC ON PROPOSED WESTBOUND LANES FROM STA. 223+00 TO STA. 298+00. WIDEN, RESURFACE AND RECONSTRUCT EASTBOUND LANES FROM STA. 223+00 TO STA. 266+50.

REFER TO SHEETS 92 THROUGH 98 FOR TRAFFIC CONTROL PLANS FOR STAGE 3 CONSTRUCTION.

STAGE 4

REMOVE TEMPORARY MEDIAN CROSS-OVER AT STA 223+00, FINAL GRADE MEDIAN AND FILL TEMPORARY PIPE AT STA. 224+00. OVERLAY ENTIRE PROJECT WITH BITUMINOUS SURFACE ON PAVEMENT AND 2 INCHES ON THE SHOULDERS. MAINTAIN TRAFFIC ACCORDING TO STANDARD 701421.

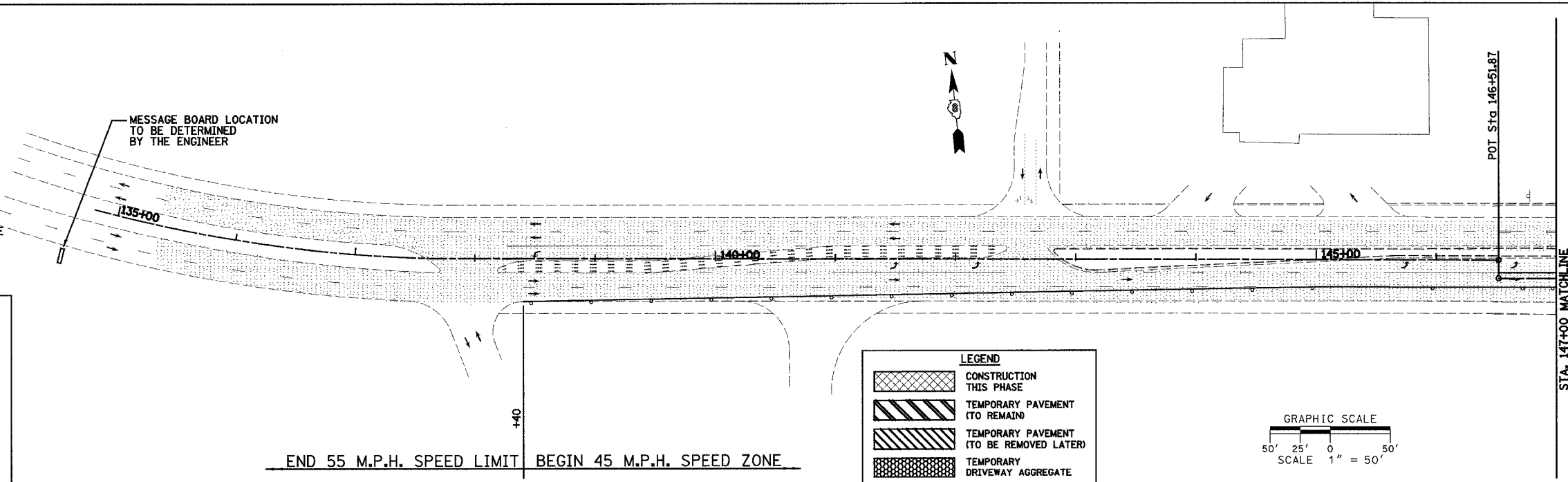

GENERAL NOTES:

THE CONTRACTOR SHALL MAINTAIN TEMPORARY ACCESS TO ALL ADJACENT PROPERTIES, PRIVATE DRIVES AND PUBLIC ROADWAYS THROUGHOUT THE LENGTH OF THE CONSTRUCTION CONTRACT. ALL EARTHWORK AND SUBGRADE PREPARATION REQUIRED FOR MAINTAINING TEMPORARY ACCESS WILL NOT BE MEASURED AND PAID FOR SEPERATELY BUT SHALL BE CONSIDERED INCLUDED IN THE CONTRACT UNIT PRICE PER TON FOR AGGREGATE FOR TEMPORARY ACCESS.

REMOVAL OF TEMPORARY ACCESS MATERIALS INCLUDING: TEMPORARY AGGREGATE, ACCESS PIPE CULVERTS AND EARTH EMBANKMENTS WILL NOT BE MEASURED AND PAID FOR SEPERATELY BUT SHALL BE CONSIDERED INCLUDED IN THE CONTRACT UNIT PRICE PER TON FOR AGGREGATE FOR TEMPORARY ACCESS, PER FOOT FOR PIPE CULVERTS(TEMPORARY) AND PER CUBIC YARD FOR EARTH EXCAVATION.

THE CONTRACTOR SHALL MAINTAIN DRAINAGE BY CONSTRUCTING TEMPORARY DITCHES AND CULVERTS AS SHOWN ON THE PLANS AND CROSS SECTIONS AND AS NECESSARY TO AVOID FLOODING OF ROADWAY AND ADJACENT PROPERTIES.

LEGEND

[Cross-hatched pattern]	CONSTRUCTION THIS PHASE
[Diagonal hatching]	TEMPORARY PAVEMENT (TO REMAIN)
[Diagonal hatching]	TEMPORARY PAVEMENT (TO BE REMOVED LATER)
[Dotted pattern]	TEMPORARY DRIVEWAY AGGREGATE
[Stippled pattern]	EXISTING PAVEMENT
[Arrow]	DIRECTION OF TRAFFIC FLOW THIS STAGE
[T-shaped symbol]	TYPE III BARRICADE
[Circle]	DRUM OR BARRICADE W/ STEADY BURN LIGHTS
[Line with cross-ticks]	TEMPORARY DITCH
[Wavy line]	PROPOSED DITCH

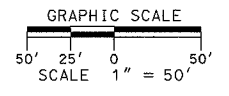

REVISIONS	
NAME	DATE

ILLINOIS DEPARTMENT OF TRANSPORTATION

CONSTRUCTION PLAN - STAGE 3

SHEET 1 OF 7

F.A.P. 103 (IL. RTE. 13/15)

SECTION 27-1R - ST. CLAIR CO.

SCALE: 1" = 50'

DATE: February 11, 2005

DRAWN BY: CRO

CHECKED BY: RCY

J:\2002\02058\000\CONTR\CON\stage3_constr_stage3_103.dgn 3/9/2005 14:48 PM