

F.A. RTE.	SECTION	COUNTY	TOTAL SHEETS	SHEET NO.
103	27-1R	ST. CLAIR	382	70
STA. 211+00.00		TO STA. 243+00.00		
FED. ROAD DIST. NO.		ILLINOIS	FED. AID PROJECT	
CONTRACT NO. 76300				

NOTE: FILL TEMP. PIPE AT STA. 224+00 LT. AND FINAL GRADE MEDIAN AND LT. DITCH FROM STA. 221+00 TO STA. 224+00 IN STAGE 4

DATE	BY
DATE	BY
DATE	BY
DATE	BY

DATE	BY
DATE	BY
DATE	BY
DATE	BY

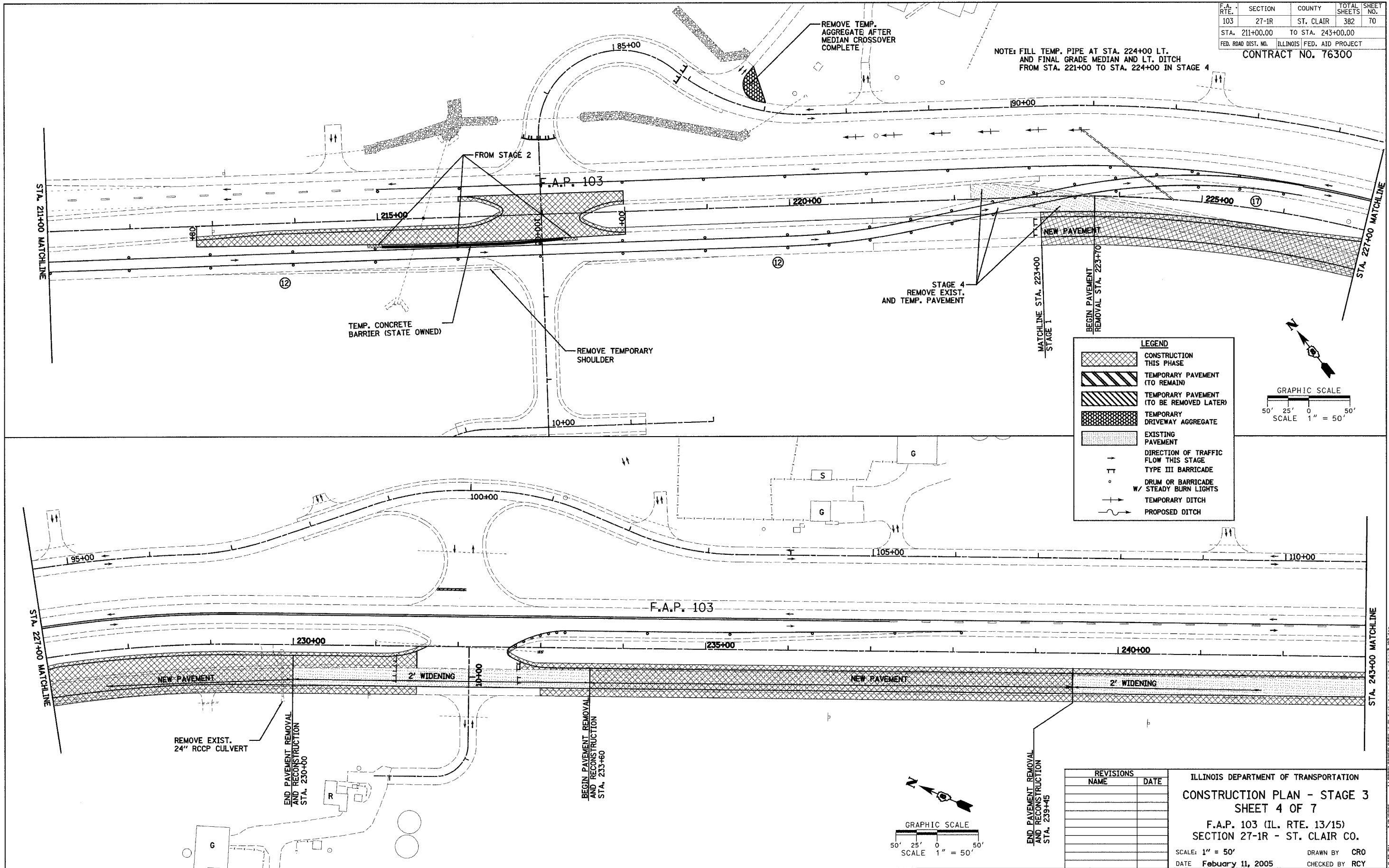

**LEGEND**

- CONSTRUCTION THIS PHASE
- TEMPORARY PAVEMENT (TO REMAIN)
- TEMPORARY PAVEMENT (TO BE REMOVED LATER)
- TEMPORARY DRIVEWAY AGGREGATE
- EXISTING PAVEMENT
- DIRECTION OF TRAFFIC FLOW THIS STAGE
- TYPE III BARRICADE
- DRUM OR BARRICADE W/ STEADY BURN LIGHTS
- TEMPORARY DITCH
- PROPOSED DITCH

REVISIONS	
NAME	DATE

ILLINOIS DEPARTMENT OF TRANSPORTATION  
**CONSTRUCTION PLAN - STAGE 3**  
**SHEET 4 OF 7**  
 F.A.P. 103 (IL. RTE. 13/15)  
 SECTION 27-1R - ST. CLAIR CO.  
 SCALE: 1" = 50'  
 DATE February 11, 2005  
 DRAWN BY CRO  
 CHECKED BY RCY

J:\2002\020658\0001\CIVIL\pdp\stage\_constr\_stage3\_03.dgn 3/9/2005 4:49 PM