

F.A. RTE.	SECTION	COUNTY	TOTAL SHEETS	SHEET NO.
103	27-1R	ST. CLAIR	382	98
STA. 307+00.00		TO STA. 338+00.00		
FED. ROAD DIST. NO.		ILLINOIS FED. AID PROJECT		
CONTRACT NO. 76300				

STAGE 3 MAINLINE TEMPORARY PAVEMENT MARKINGS SHALL BE OF THE SAME COLOR AND INSTALLED TO THE SAME DIMENSIONS AS SHOWN IN THE PLANS FOR THE PERMANENT MARKINGS STATION 305+50 TO 338+00.

NOTE:

1. CONTRACTOR TO REMOVE OR COVER CONFLICTING TRAFFIC CONTROL SIGNS.
2. DRUMS OR BARRICADES SHALL BE PLACED ALONG ENTRANCES AND SIDE ROADS SO THAT THEY ARE ADEQUATELY DELINEATED THROUGH THE WORK ZONE.

DATE	BY
DATE	BY
DATE	BY
DATE	BY
DATE	BY

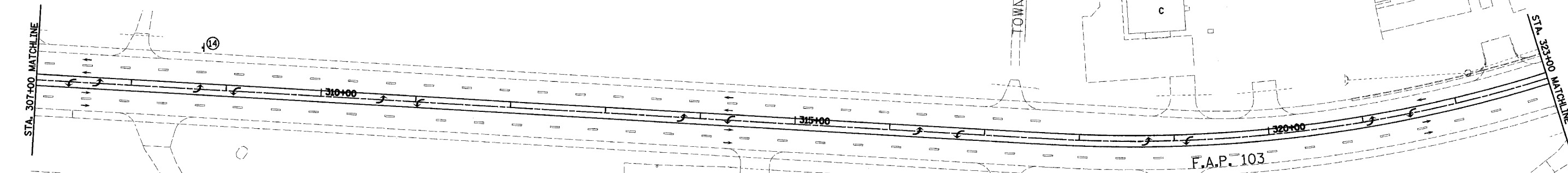

STAGE 3 - PERMANENT SIGNAGE AS DELINEATED ON SHEETS 193 - 198, BETWEEN STATIONS 305+00 AND 336+00 SHALL BE INSTALLED PRIOR TO OPENING TO TRAFFIC. SPEED LIMIT SIGNS SHALL BE COVERED.

LEGEND	
	DENOTES CONSTRUCTION THIS PHASE
	DENOTES TEMPORARY PAVEMENT
	DENOTES EXISTING PAVEMENT
	DIRECTION OF TRAFFIC FLOW THIS STAGE
	TYPE III BARRICADE
	DRUM OR BARRICADE W/ STEADY BURN LIGHTS
	MESSAGE BOARD LOCATION TO BE DETERMINED BY THE ENGINEER
	FLAGGER W/ TRAFFIC CONTROL SIGN
	CONSTRUCTION SPEED LIMIT SIGN
	ARROW BOARD

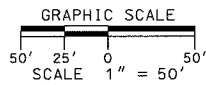

DATE	BY
DATE	BY
DATE	BY
DATE	BY
DATE	BY

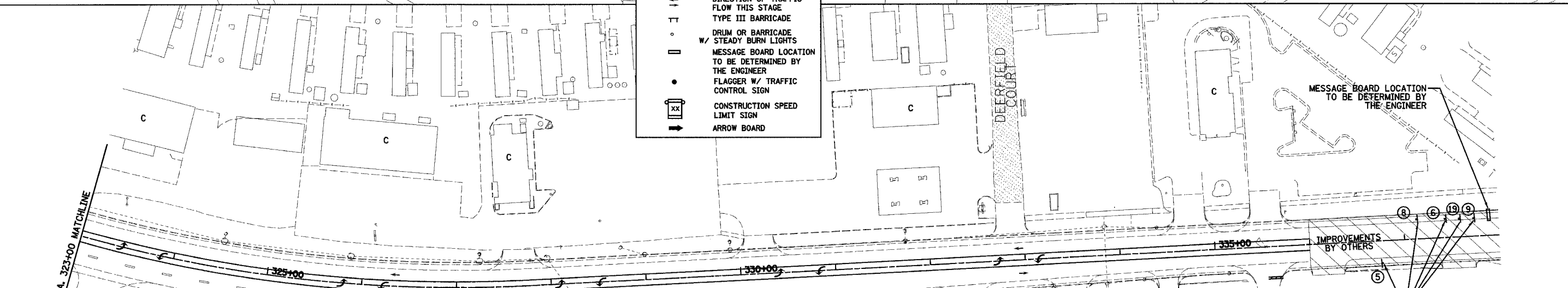

STAGE 3 MAINLINE TEMPORARY PAVEMENT MARKINGS SHALL BE OF THE SAME COLOR AND INSTALLED TO THE SAME DIMENSIONS AS SHOWN IN THE PLANS FOR THE PERMANENT MARKINGS STATION 305+50 TO 338+00.

STAGE 3 - PERMANENT SIGNAGE AS DELINEATED ON SHEETS 193 - 198, BETWEEN STATIONS 305+00 AND 336+00 SHALL BE INSTALLED PRIOR TO OPENING TO TRAFFIC. SPEED LIMIT SIGNS SHALL BE COVERED.

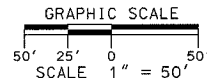

REVISIONS	
NAME	DATE

ILLINOIS DEPARTMENT OF TRANSPORTATION
TRAFFIC CONTROL PLAN - STAGE 3
SHEET 7 OF 7
 F.A.P. 103 (IL. RTE. 13/15)
 SECTION 27-1R - ST. CLAIR CO.
 SCALE: 1" = 50'
 DATE February 11, 2005
 DRAWN BY CRO
 CHECKED BY RCY

J:\2002\020658\000\civil\gpn\Traffic_control\stage7.dwg 3/9/2005 14:59 PM