

160 150 140 130 120 110 100 90 80 70 60 50 40 30 20 10 0 10 20 30 40 50 60 70 80 90 100 110 120

PROP. F.A.P. 103

F.A. RTE.	SECTION	COUNTY	TOTAL SHEETS	SHEET NO.
103	27-1R	ST. CLAIR	382	248
STA.		TO STA.		
FED. ROAD DIST. NO.		ILLINOIS FED. AID PROJECT		
CONTRACT NO. 76300				

215+21.52

SPEC. DITCH RIGHT
STA. 215+20.5 TO 216+50
AT +5.79 %

FINAL SURVEY	DATE
SURVEYED	
NOTE BOOK	
AREAS CHECKED	

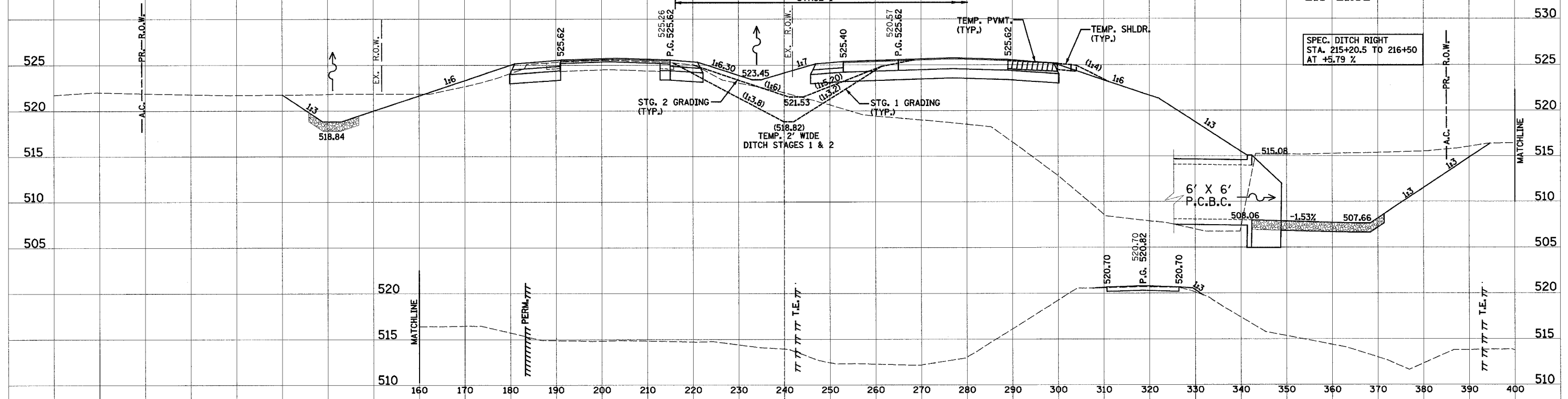

SPEC. DITCH LEFT
STA. 215+00 TO 215+94
AT -10.63 %

ORIGINAL SURVEY	DATE
SURVEYED	
NOTE BOOK	
AREAS CHECKED	

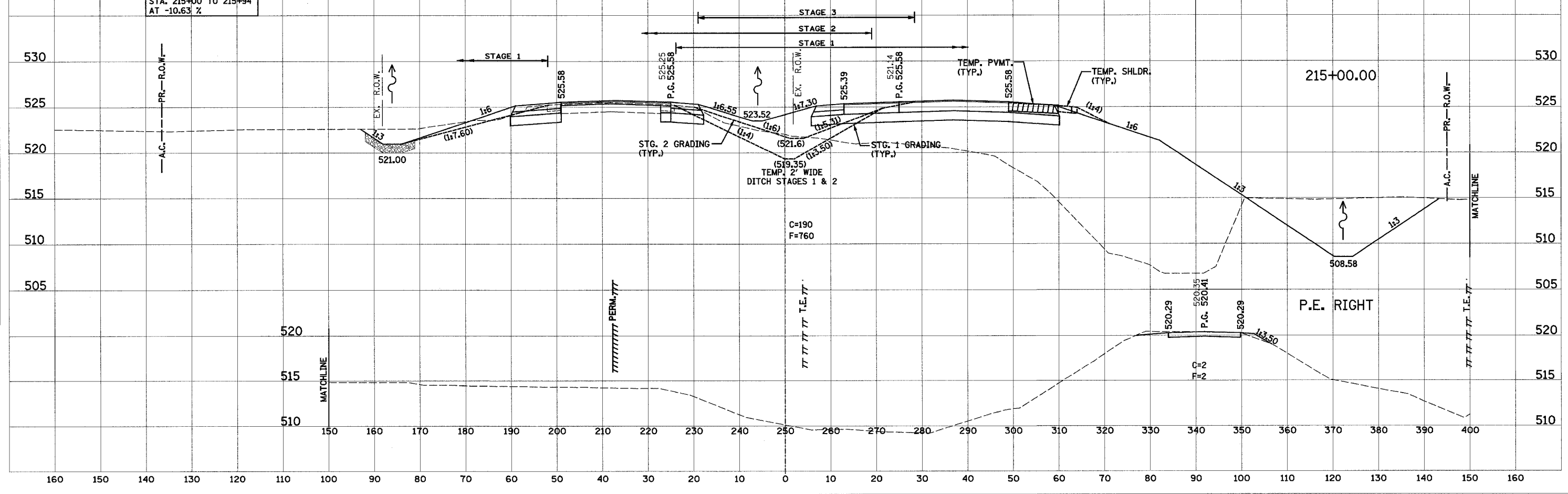

215+00.00

P.E. RIGHT

160 150 140 130 120 110 100 90 80 70 60 50 40 30 20 10 0 10 20 30 40 50 60 70 80 90 100 110 120 130 140 150 160