

160 150 140 130 120 110 100 90 80 70 60 50 40 30 20 10 0 10 20 30 40 50 60 70 80 90 100 110 120

PROP. F.A.P. 103

F.A. RTE.	SECTION	COUNTY	TOTAL SHEETS	SHEET NO.
103	27-1R	ST. CLAIR	382	275
STA.		TO STA.		
FED. ROAD DIST. NO.		ILLINOIS FED. AID PROJECT		
CONTRACT NO. 76300				

DATE	BY

DATE	BY

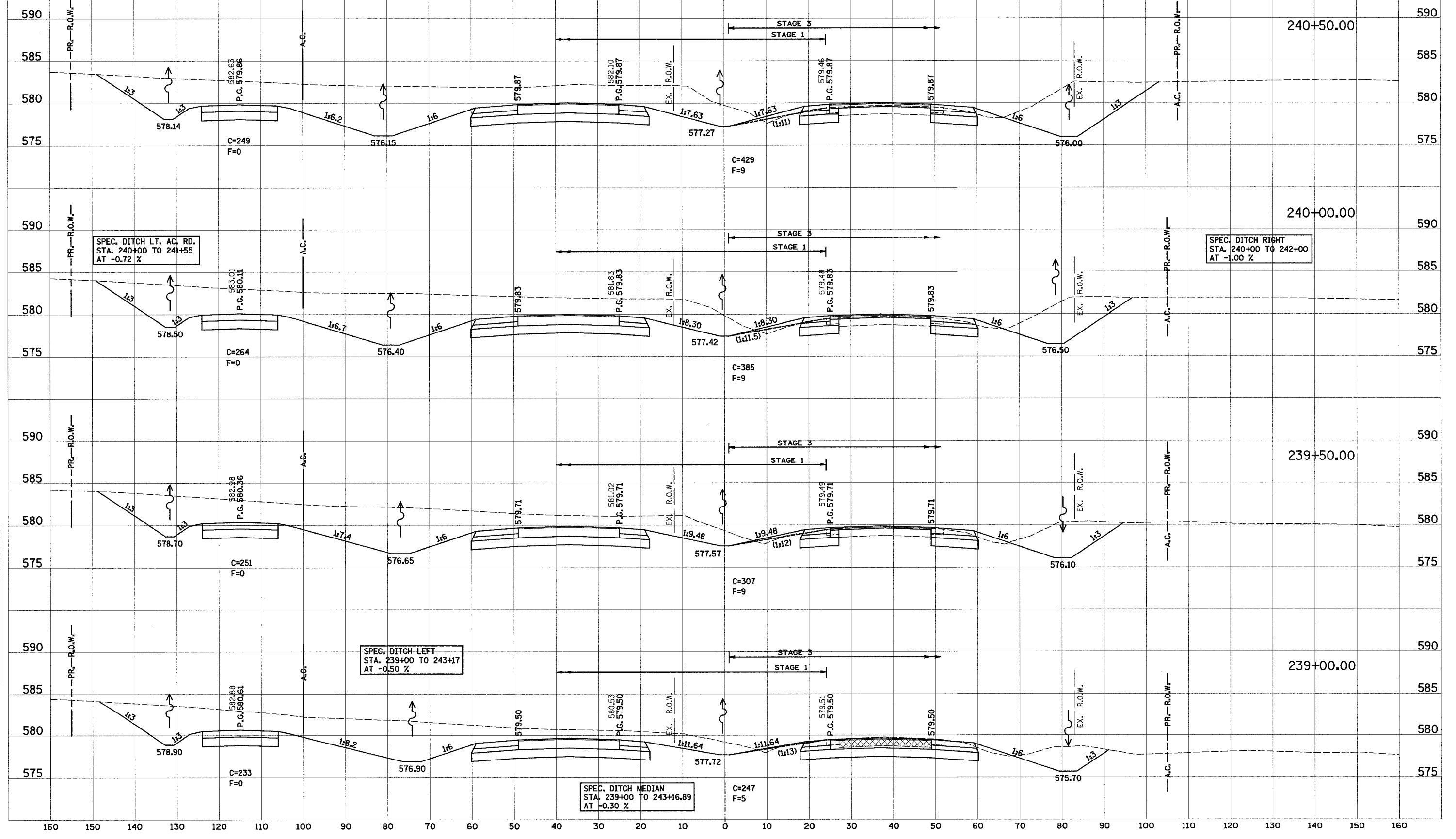

SPEC. DITCH MEDIAN
STA. 239+00 TO 243+16.89
AT -0.30 %

SPEC. DITCH LEFT
STA. 239+00 TO 243+17
AT -0.50 %

SPEC. DITCH LT. AC. RD.
STA. 240+00 TO 241+55
AT -0.72 %

SPEC. DITCH RIGHT
STA. 240+00 TO 242+00
AT -1.00 %