

PROP. ACCESS ROAD

F.A. RTE.	SECTION	COUNTY	TOTAL SHEETS	SHEET NO.
103	27-1R	ST. CLAIR	382	347A
STA.		TO STA.		
FED. ROAD DIST. NO.		ILLINOIS FED. AID PROJECT		
CONTRACT NO. 76300				

FINAL SURVEY	DATE
SURVEYED	BY
NOTE BOOK	
NO.	
AREAS CHECKED	

ORIGINAL SURVEY	DATE
SURVEYED	BY
NOTE BOOK	
NO.	
AREAS CHECKED	

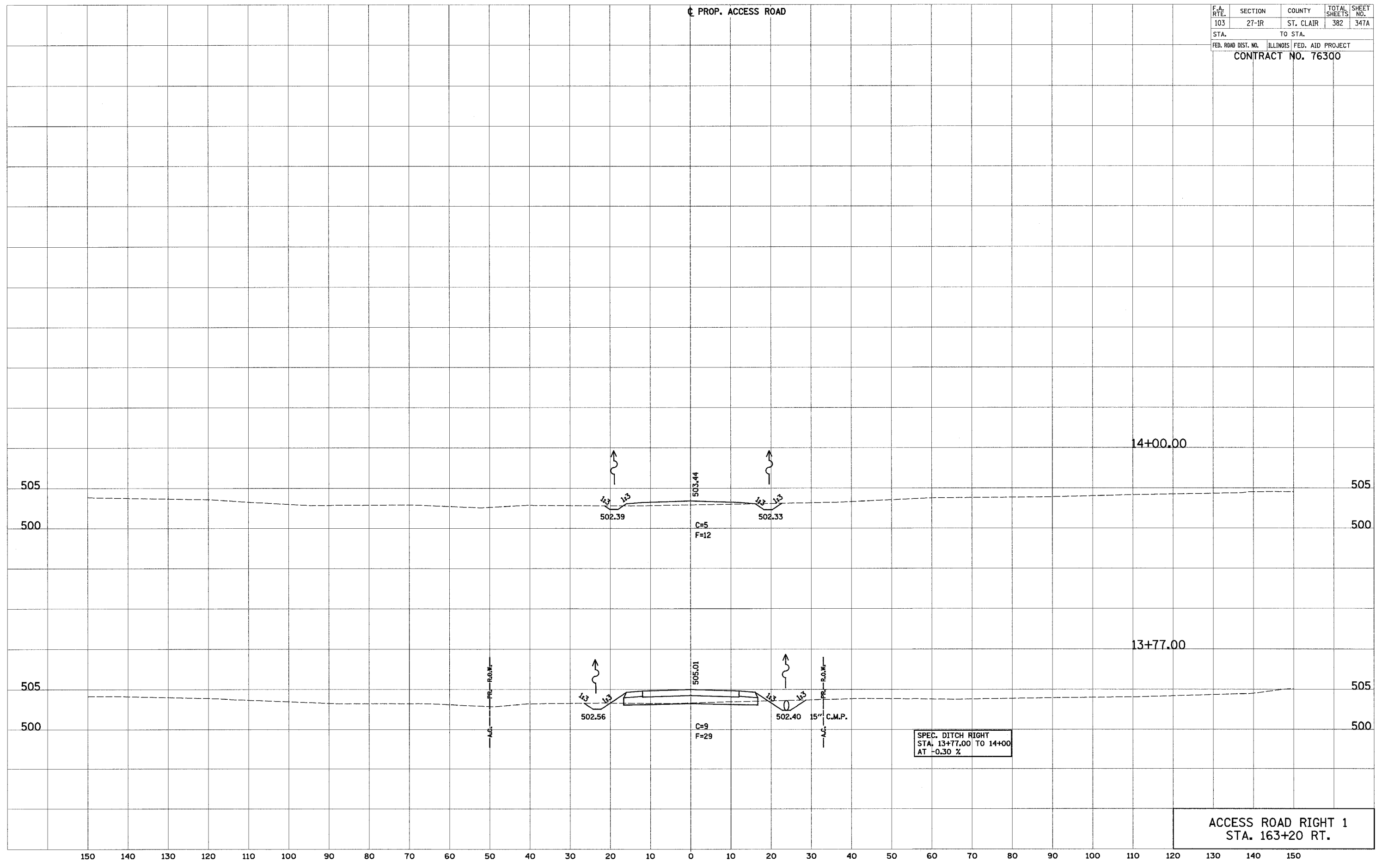

ACCESS ROAD RIGHT 1
STA. 163+20 RT.