

F.A.U. RTE.	SECTION	COUNTY	TOTAL SHEETS	SHEET NO.
9251	28-3BR-I	ST. CLAIR	101	42
STA.		TO STA.		
FED. ROAD DIST. NO.		ILLINOIS	FED. AID PROJECT	

D.M. 88 Spine in 24' dia.
 24' dia. of 246' x 28' dia. 460.62
 Existing Structure R.C. thru girder
 1 Span @ 38' - Roadway 20'
 R.C. Closed Abutments.
 Contractor shall remove existing
 superstructure portions of substructure
 that interfere with new construction.
 No Salvage.

STATE OF ILLINOIS
 DEPARTMENT OF PUBLIC WORKS & BUILDINGS
 DIVISION OF HIGHWAYS

DATE	BY	CHECKED	DATE	BY
15	332	St. Clair	16	5

2 SHEETS

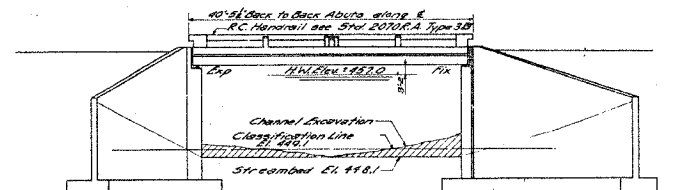

ELEVATION
 Scale 1/2" = 1'-0"

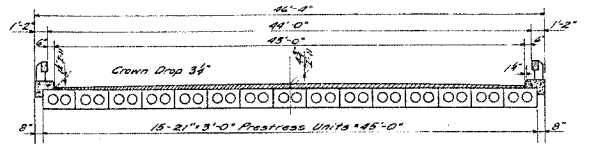

CROSS SECTION

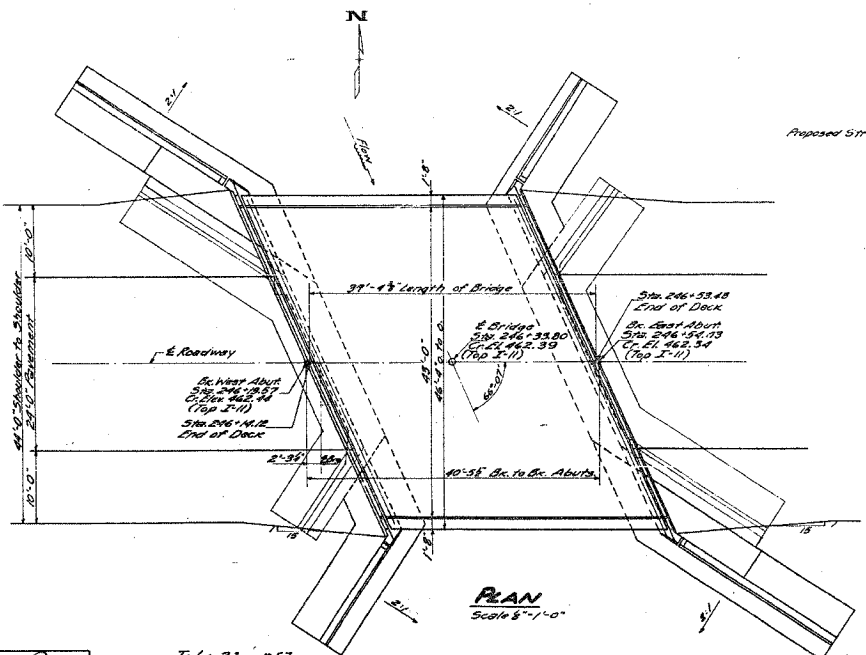

PLAN
 Scale 1/2" = 1'-0"

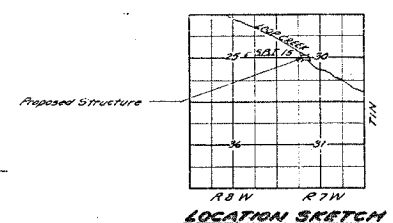

LOCATION SKETCH

GENERAL NOTES

Class X Concrete shall be used thruout except as noted. Handrail Concrete shall be used in Abutment and Posts. Handrail Concrete in the Back Area and Railing shall be poured in two separate operations.

For Item "Precast Prestressed Concrete Bridge Deck" see Special Provisions.

Strand used as prestressing element shall be non-galvanized high strength stress-relieved 7 wire strand. The nominal diameter of the strand shall not exceed 3/4" and the nominal cross-sectional area shall be 0.88 square inch.

Concrete that receive transverse tie bars in the outside beams shall be filled with grout after transverse tie assembly is in place. Rockets on outside beams not having ties shall also be grouted. Cast for filling sockets shall be incidental to the Unit Price bid for "Precast Prestressed Concrete Bridge Deck".

The 1/2" dia. bars cast in outside beams shall be included in the Unit Price Bid for "Precast Prestressed Concrete Bridge Deck".

The Roadway Expansion Guard cast in beams shall be included in the Unit Price Bid for "Precast Prestressed Concrete Bridge Deck".

The Roadway Expansion Guard in approach slab shall be fabricated to fit the roadway. It shall be paid for as Structural Steel, Estimated 1411.670 lbs.

All surfaces of the Expansion Guard in approach slab and in the beams which are inaccessible after erection shall receive two shop coats of red lead paint except the 2" x 2" struts. The struts shall not be painted.

Structural Steel shall receive one shop coat of red lead paint and two field coats of aluminum paint except as otherwise provided. See Division 58.1 to 58.6 inclusive of the Standard Specifications.

All paint shall be furnished by the contractor.

The 3/8" x 1/2" x 1/2" cast in beams shall be included in the Unit Price Bid for "Precast Prestressed Concrete Bridge Deck".

The base of the proposed abutments and wing walls from the top of the approach notch or top of the earth fill to the top of the footing shall be water-impervious in accordance with Article 501 of the Standard Specifications.

The 1" x 8" bolts in the transverse tie assembly shall be tightened to a snug fit entire threads set.

STATION 246+53.0
 BUILT 195 BY
 STATE OF ILLINOIS
 S.E.C. 27.15 SEC. 28 BY
 P.A. 082-380 (2)
 LOADING H20-31E
WAVE PLATE
 See Spcl 2115

TOTAL BILL OF MATERIAL

ITEM	SUPER	SUB	TOTAL
Precast Prestressed Conc Bridge Deck Slab	166.2		166.2
Class X Concrete	Cu. Yds.	5.0	228.6
Handrail Concrete	Cu. Yds.	2.0	2.0
Reinforcement Bars	Lbs.	1010	16,770
Structural Steel	Lbs.	1,570	1,570
Class II Excavation for Structures (W)		470	470
Class II Excavation for Structures (S)		260	260
Channel Excavation	Cu. Yds.	150	150
Wave Plates	Ea.	1	1
Expansion Bolts	Ea.	68	68
Concrete Removal	Cu. Yds.	54	6.60

WATERWAY INFORMATION

Damage Area ----- 2070 Acres
 Character -- Level, Rolling, Clay, Cultivated
 Flood Opening -- (30% Frequency) -- 256' x 1'
 Present Opening ----- 256' x 1'
 Proposed Opening ----- 256' x 1'
 Ordinary Flow ----- El. 448.6
 Low Water Flow ----- El. 448.1
 High Water Flow ----- El. 452.0

DESIGN STRESSES

PRECAST UNITS FIELD UNITS
 Fc = 5000 p.s.i. Fc = 14000 p.s.i. (Supac)
 Ft = 4000 p.s.i. Ft = 8000 p.s.i. (Sub)
 Fc = 25000 p.s.i. (Cable) Ft = 20,000 p.s.i. (Raint)
 Ft = 180,000 p.s.i. (Cable) N = 10

GENERAL PLAN ELEVATION
BRIDGE OVER LOOP CREEK
S.E.C. 27.15 - SEC. 28 BY
ST. CLAIR COUNTY
STATION 246+53.0

DESIGNED: G.H. Kelly
 CHECKED: J. Kelly
 DRAWN: B.W. Brown
 DATE: July 23, 1957
 EXAMINED: M. R. ...
 APPROVED: G.R. ...

Loading H20-31E

FOR INFORMATION ONLY

REVISIONS	
NAME	DATE

ILLINOIS DEPARTMENT OF TRANSPORTATION
EXISTING STRUCTURE PLANS
 FAU ROUTE 9251
 SECTION 28-3BR-I
 ST. CLAIR COUNTY
 SN 082-0057(E) 0398(P)

PLOT DATE = 2/6/2006
 FILE NAME = c:\vpc\projects\2408\plan\p1\054.dwg
 PLOT SCALE = 50.0000 / 1" IN.
 REFERENCE = BREF#