

F.A.P. RTE.	SECTION	COUNTY	TOTAL SHEETS	SHEET NO.
600	30-ITS-1	MADISON	17	5
STA.		TO STA.		
FED. ROAD DIST. NO.	ILLINOIS	FED. AID PROJECT		

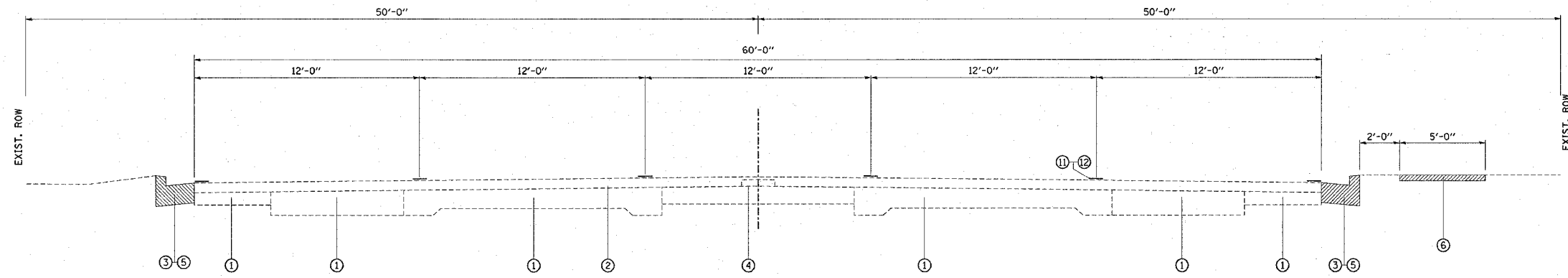

IL 159 TYPICAL SECTION
STA 607+90 TO STA 611+75

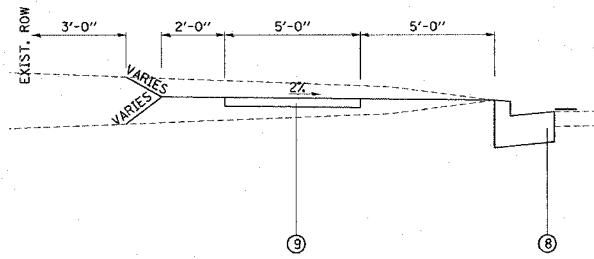

LEFT SIDE
STA 608+09 TO STA 609+75

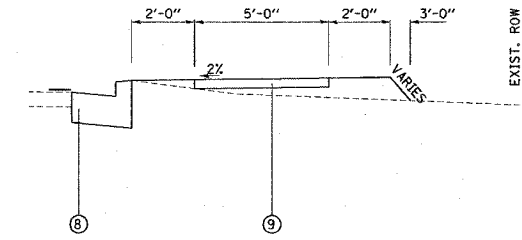

RIGHT SIDE
STA 608+04 TO STA 608+18
STA. 609+38 TO STA. 609+75

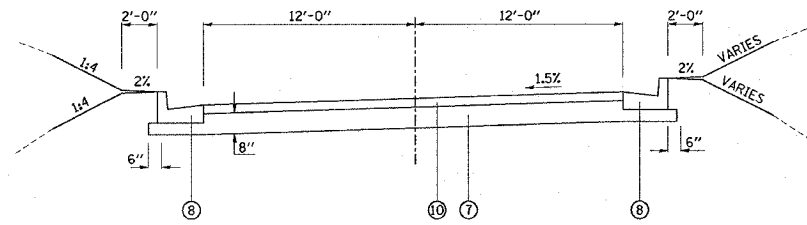

RELOCATED ENTRANCE
STA. 12+00 TO STA. 12+30

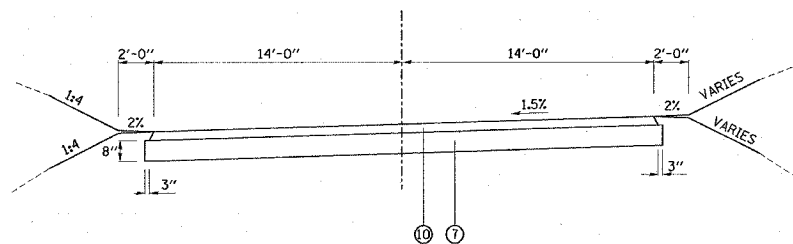

RELOCATED ENTRANCE
STA. 12+30 TO STA. 13+13

- LEGEND
- ① EXISTING PAV'T STRUCTURE
 - ② EXISTING RESURFACING - ±3/4" (ESTIMATED)
 - ③ EXISTING CURB & GUTTER
 - ④ EXISTING P.C.C. MEDIAN
 - ⑤ PROPOSED COMBINATION CURB & GUTTER REMOVAL
 - ⑥ PROPOSED SIDEWALK REMOVAL
 - ⑦ PROPOSED AGGREGATE BASE COURSE T-B 8"
 - ⑧ PROPOSED COMBINATION CURB & GUTTER T-B 6.24
 - ⑨ PROPOSED PORTLAND CEMENT CONCRETE SIDEWALK 4"
 - ⑩ PROPOSED INCIDENTAL BITUMINOUS 3"
 - ⑪ PROPOSED PAVEMENT MARKING REMOVAL
 - ⑫ PROPOSED PAINT PAVEMENT MARKING

REVISIONS	
NAME	DATE

ILLINOIS DEPARTMENT OF TRANSPORTATION
TYPICAL SECTIONS
FAP ROUTE 600 (IL 159)
SECTION 30-ITS-1
MADISON COUNTY

SCALE: VERT. _____
HORIZ. _____
DATE _____ DRAWN BY _____
CHECKED BY _____

PLOT DATE = #DATE#
PLOT SCALE = #SCALE#
REFERENCE = #REF#