

F.A.P. RTE.	SECTION	COUNTY	TOTAL SHEETS	SHEET NO.
592	1211-1	ST. CLAIR	16	7
STA. 276+15.58		TO STA. 280+80		
FED. ROAD DIST. NO.		ILLINOIS FED. AID PROJECT		

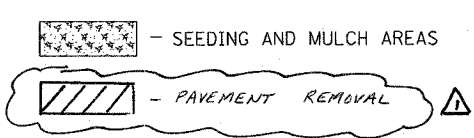

PROP. CURVE 157-2  
 PI STA. = 278+70.25  
 $\Delta = 4^\circ 23' 30''$  (LT)  
 $D = 0^\circ 47' 28''$   
 $R = 7,242.01'$   
 $T = 277.69'$   
 $L = 555.10'$   
 $E = 5.32'$   
 $\theta = \text{-----}$   
 $T.R. = \text{-----}$   
 $S.E. RUN = \text{-----}$   
 $P.C. STA = 275+92.56$   
 $P.T. STA = 281+47.67$

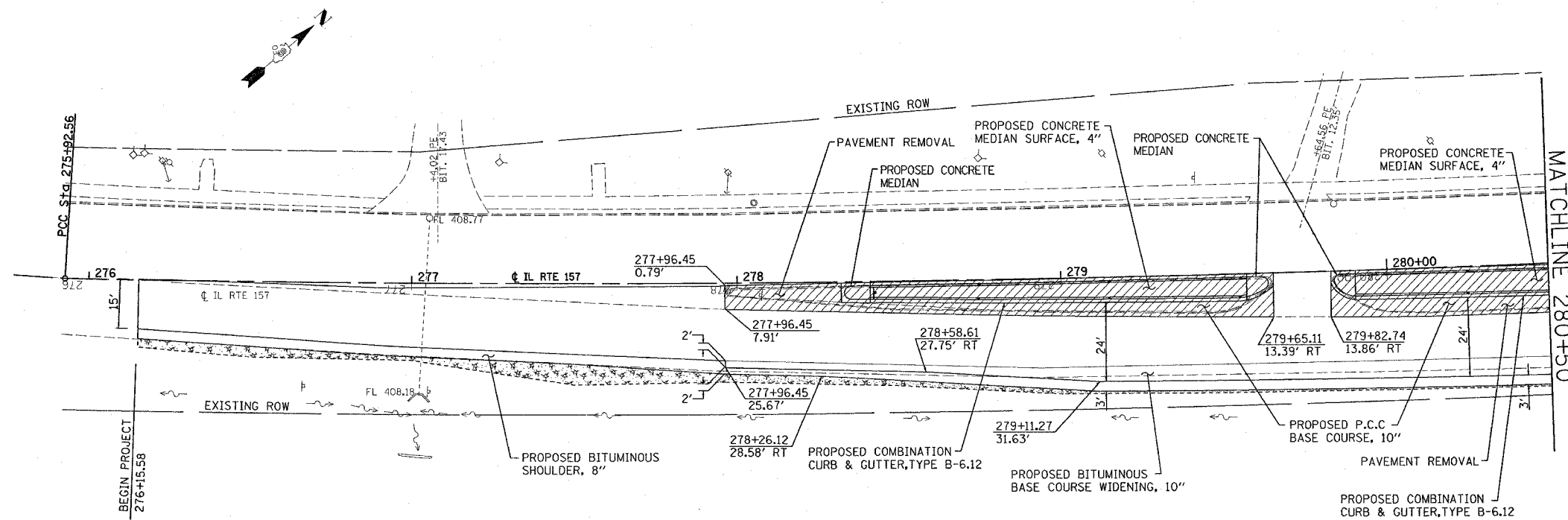
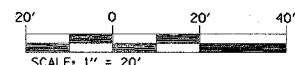

REVISIONS	
NAME	DATE

ILLINOIS DEPARTMENT OF TRANSPORTATION

**PLAN VIEW**

FAP ROUTE 592  
 SECTION 1211-1  
 ST. CLAIR COUNTY

SCALE: VERT. \_\_\_\_\_  
 HORIZ. \_\_\_\_\_

DRAWN BY \_\_\_\_\_  
 CHECKED BY \_\_\_\_\_

Rev. 4-11-06

PLOT DATE = 2/9/2006  
 PLOT SCALE = 20,000.00 / IN.  
 USER NAME = bmgnd