

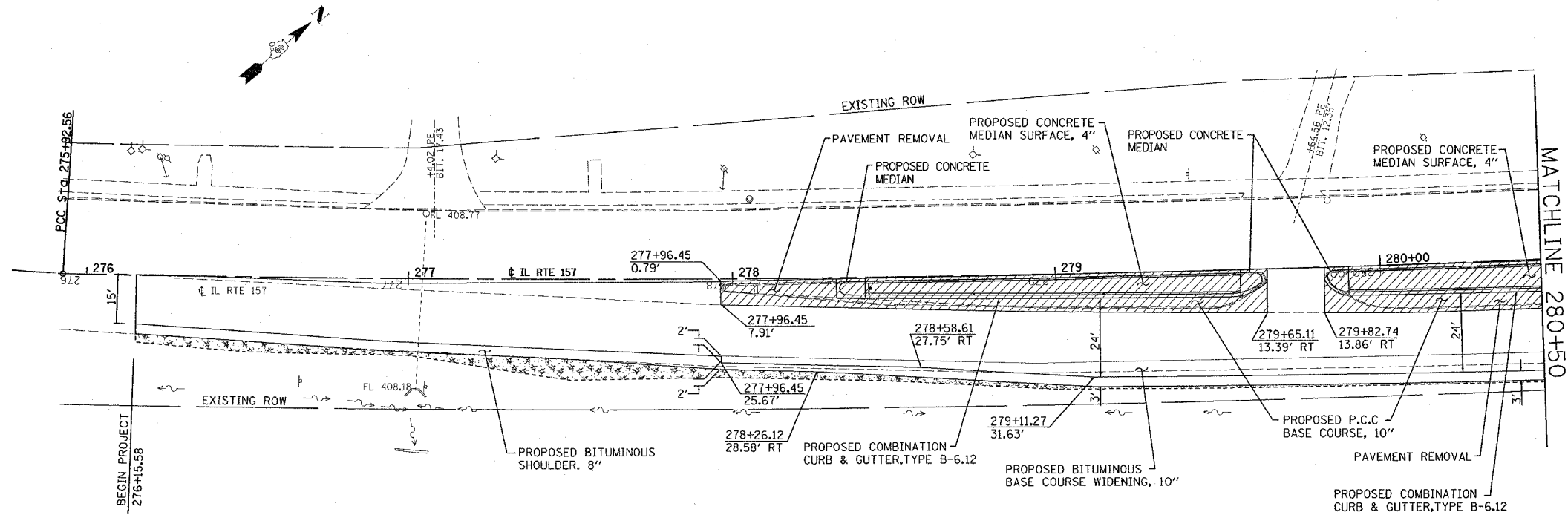

F.A.P. RTE.	SECTION	COUNTY	TOTAL SHEETS	SHEET NO.
592	121I-1	ST. CLAIR	16	7
STA. 276+15.58		TO STA. 280+80		
FED. ROAD DIST. NO.		ILLINOIS	FED. AID PROJECT	



PROP. CURVE 157-2
 PI STA. = 278+70.25
 $\Delta = 4^\circ 23' 30''$ (LT)
 $D = 0^\circ 47' 28''$
 $R = 7,242.01'$
 $T = 277.69'$
 $L = 555.10'$
 $E = 5.32'$
 $e = \text{-----}$
 $T.R. = \text{-----}$
 $S.E. \text{ RUN} = \text{-----}$
 $P.C. \text{ STA} = 275+92.56$
 $P.T. \text{ STA} = 281+47.67$

 SEEDING AND MULCH AREAS

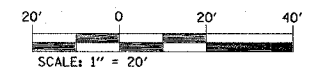

PLOT DATE = 2/9/2006
 FILE NAME = c:\projects\121I-1\121I-1.dgn
 PLOT SCALE = 20.0000 / 1 IN.
 USER NAME = bergnd

REVISIONS	
NAME	DATE

ILLINOIS DEPARTMENT OF TRANSPORTATION

PLAN VIEW

FAP ROUTE 592
 SECTION 121I-1
 ST. CLAIR COUNTY

SCALE: VERT. _____
 HORIZ. _____

DATE _____ DRAWN BY _____
 CHECKED BY _____