

F.A.P. RTE.	SECTION	COUNTY	TOTAL SHEETS	SHEET NO.
592	1211-1	ST. CLAIR	16	1

STATE OF ILLINOIS
DEPARTMENT OF TRANSPORTATION
DIVISION OF HIGHWAYS

**PROPOSED
HIGHWAY PLANS**

FAP ROUTE 592 (ILL.ROUTE 157)
SECTION 1211-1
PROJECT: HS-0592(047)
ST. CLAIR COUNTY
RIGHT TURN LANE AT
IL 157 AND IL 163
C-98-124-05

FOR INDEX OF SHEETS, SEE SHEET NO. 2

TRAFFIC DATA

	2005 ADT	2025 ADT	MU	SU
IL 157	10600	12200	1.3	4
IL 163	3900	4500	3.7	1.6
IL 157/163	9000	10350	3.9	1.0

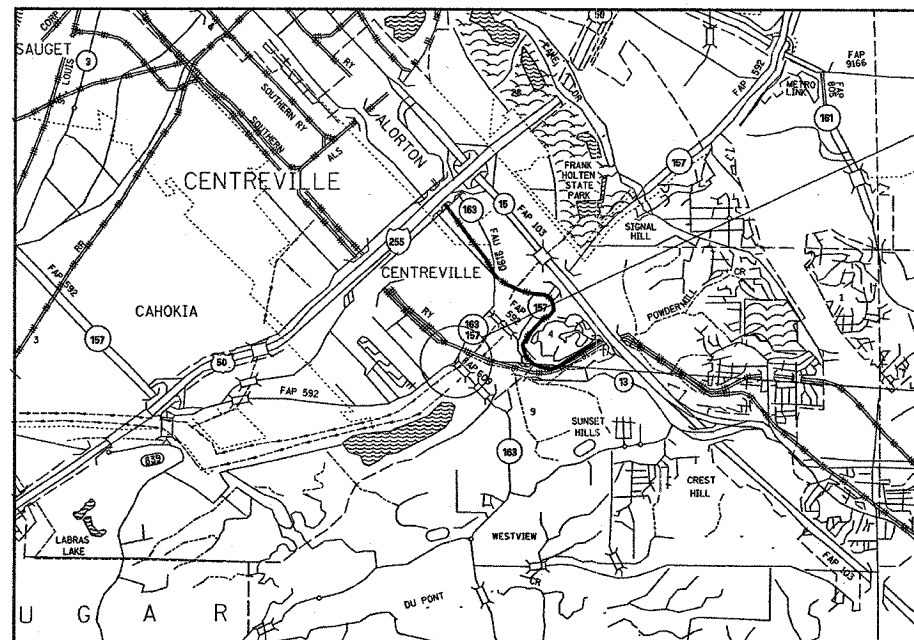
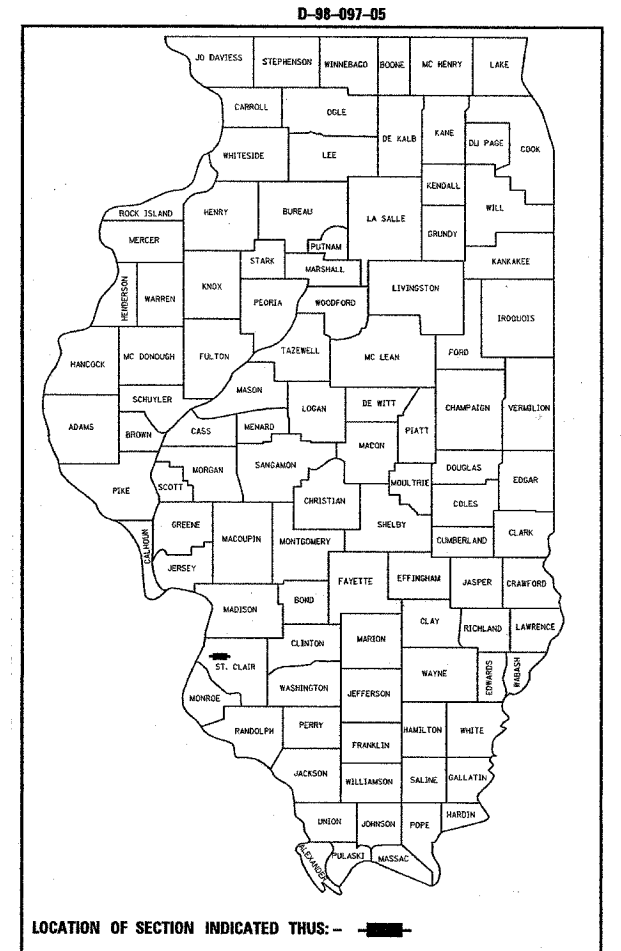

END STA 285+03.88
LAT:38.55737
LONG:-90.10938

BEGIN STA 276+15.58
LAT:38.55527
LONG:-90.11146

MICROFILMED _____
REEL NUMBER _____
AWARDED _____
RESIDENT ENGINEER _____
AS BUILT CHANGES WERE MADE
ON THE FOLLOWING SHEETS

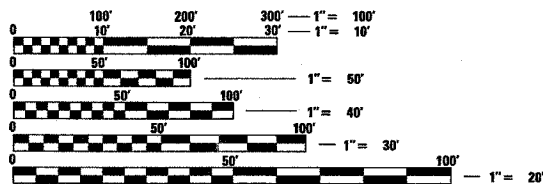

FULL SIZE PLANS HAVE BEEN PREPARED USING STANDARD ENGINEERING SCALES. REDUCED SIZED PLANS WILL NOT CONFORM TO STANDARD SCALES. IN MAKING MEASUREMENTS ON REDUCED PLANS, THE ABOVE SCALES MAY BE USED.

J.U.L.I.E.
JOINT UTILITY LOCATION INFORMATION FOR EXCAVATION
1-800-892-0123

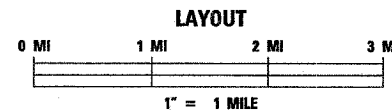

GROSS LENGTH = 888.30 FT (0.168 MI)
NET LENGTH = 888.30 FT (0.168 MI)

STATE OF ILLINOIS
DEPARTMENT OF TRANSPORTATION
DIVISION OF HIGHWAYS

SUBMITTED Feb-10, 2006

May Chami
DEPUTY DIRECTOR OF HIGHWAYS
REGION FIVE ENGINEER

March 24, 2006
Mike Reno
ENGINEER OF DESIGN AND ENVIRONMENT

March 24, 2006
Melton R. Sess P.E.
DIRECTOR, DIVISION OF HIGHWAYS

**PRINTED BY THE AUTHORITY
OF THE STATE OF ILLINOIS**

PROJECT ENGINEER: PATTI EBEAU (618) 346-3179
SQUAD LEADER: CHERYL KEPLAR (618) 346-3186

CONTRACT NO. 76956

GENERAL NOTES

CONTRACT NO. 76956

F.A.P. RTE.	SECTION	COUNTY	TOTAL SHEETS	SHEET NO.
592	1211-1	ST. CLAIR	16	2
STA.		TO STA.		
FED. ROAD DIST. NO.		ILLINOIS FED. AID PROJECT		

- IF ANY SECTION OR SUB-SECTION MONUMENTS ARE ENCOUNTERED, THE ENGINEER SHALL BE NOTIFIED BEFORE SUCH MONUMENTS ARE REMOVED OR RESURFACED OVER. THE CONTRACTOR SHALL PROTECT AND CAREFULLY PRESERVE ALL PROPERTY MARKERS AND MONUMENTS UNTIL THE OWNER, AN AUTHORIZED SURVEYOR, OR AGENT HAS WITNESSED OR OTHERWISE REFERENCED THEIR LOCATION.
- EXCEPT WHERE DESIGNATED OTHERWISE, THE LOCATIONS AND/OR DEPTHS OF UNDERGROUND UTILITIES SHOWN HAVE BEEN TAKEN FROM OFFICE RECORD INFORMATION FURNISHED BY THE UTILITY OWNERS AND MUST BE CONSIDERED APPROXIMATE.
- ILLINOIS STATE LAW REQUIRES A 48-HOUR NOTICE TO BE GIVEN TO UTILITIES BEFORE DIGGING. FIELD MARKING OF FACILITIES MAY BE OBTAINED BY CONTACTING J.U.L.I.E. OR FOR NON-MEMBERS, THE UTILITY COMPANY DIRECTLY. AGENCIES KNOWN TO HAVE FACILITIES WITHIN THE PROJECT AREA ARE AS FOLLOWS:

UTILITY	ABOVE GROUND	BELOW GROUND
*AMERENIP		X
*AMEREN-UE	X	X
*CHARTER COMMUNICATIONS, INC.	X	X
*COMMONFIELDS OF CAHOKIA PUBLIC WATER DISTRICT		X
*ILLINOIS AMERICAN WATER CO.		X
*MCI NETWORK SERVICES, INC.		X
*NETWORKS, 360	X	X
*SBC	X	X
*VERIZON NORTH, INC.	X	X

MEMBERS OF J.U.L.I.E. (800)-892-0123 ARE INDICATED BY *. NON J.U.L.I.E. MEMBERS MUST BE NOTIFIED INDIVIDUALLY.

- THE CONTRACTOR SHALL BE AWARE THAT THERE ARE MANHOLES & VALVES LOCATED WITHIN THE RESURFACING LIMITS. CARE SHALL BE TAKEN IN THESE LOCATIONS DURING MILLING OPERATIONS.
- THE THICKNESS OF THE BITUMINOUS MIXTURE SHOWN ON THE PLANS IS THE NOMINAL THICKNESS. DEVIATIONS FROM THE NOMINAL THICKNESS WILL BE PERMITTED WHEN SUCH DEVIATIONS OCCUR DUE TO IRREGULARITIES IN THE EXISTING SURFACE OR BASE ON WHICH THE BITUMINOUS MIXTURE IS PLACED.
- SHORT-TERM PAVEMENT MARKING SHALL BE APPLIED TO THE MILLED, PRIMED AND FINAL BITUMINOUS SURFACE. A QUANTITY FOR TEMPORARY PAVEMENT MARKING EQUAL TO THE AMOUNT OF PERMANENT MARKING HAS BEEN ADDED TO THE PLANS.
- THE FOLLOWING MIXTURE REQUIREMENTS ARE APPLICABLE FOR THIS PROJECT:

ROUTE	IL 157
SECTION	1211-1
COUNTY	Randolph
CONTRACT	76956

DESCRIPTION: Construction of RTL on IL 157 @ IL 163 - Centreville

ADT (Construction Yr)	10600
MU%:	1.3
SUZ:	4
20 YR. ESAL'S:	1.37

MIXTURE USE	SURFACE	LEVEL BINDER	Binder / Widening	INCIDENTAL SURF	Partial Depth Patch
AC/PG	PG 64-22	PG 64-22	PG 64-22	PG 64-22	PG 64-22
RAP % (MAX)	10%	10%	15%	10%	10%
DESIGN AIR VOIDS	4.0% @ Ndes=70	4.0% @ Ndes=70	4.0% @ Ndes=70	4.0% @ Ndes=70	4.0% @ Ndes=70
MIX COMPOSITION (GRADATION MIXTURE)					
FRICITION AGG	Mixture "D"	MIXTURE "C"	MIXTURE "B"	MIXTURE "C"	MIXTURE "C"

MIXTURE USE	SHOULDERS	TOP LIFT SHOULDERS
AC/PG	PG 58-22	PG 58-22
RAP % (MAX)	30%	30%
DESIGN AIR VOIDS	2.0% @ Ndes=30	**2.0% @ Ndes=30
MIX COMPOSITION (GRADATION MIXTURE)		
FRICITION AGG	BAM	BAM

** Top Lift Shoulders - Design this mix at 2.0% voids and add asphalt to reduce voids to 1.5%.
Plan quantities for Bituminous Concrete Surface Course Items are calculated using a unit weight of 112 lb/sq yd/in (59.8 kg/sq m/25 mm thickness).

- ALL EROSION CONTROL PRODUCTS FURNISHED SHALL BE SPECIFICALLY RECOMMENDED BY THE MANUFACTURER FOR THE USE SPECIFIED IN THE EROSION CONTROL PLANS. PRIOR TO THE APPROVAL AND USE OF THE PRODUCT, THE CONTRACTOR SHALL SUBMIT TO THE ENGINEER A NOTARIZED CERTIFICATE BY THE PRODUCER STATING THE INTENDED USE OF THE PRODUCT AND THAT THE PHYSICAL PROPERTIES REQUIRED FOR THIS APPLICATION ARE MET OR EXCEEDED. THE CONTRACTOR SHALL PROVIDE THE MANUFACTURER RECOMMENDED INSTALLATION PROCEDURES TO FACILITATE THE ENGINEER IN CONSTRUCTION INSPECTION.
- NO OVERNIGHT LANE CLOSURES WILL BE ALLOWED.
- ROAD CONSTRUCTION AHEAD SIGNS SHALL BE PLACED AT THE BEGINNING AND END OF THE PROJECT PLUS THE INTERSECTING SIDE ROADS, AND WILL BE INCLUDED IN THE TRAFFIC CONTROL PAY ITEMS. ALL CONSTRUCTION SIGNS SHALL BE FLUORESCENT ORANGE.
- FLAGMEN SHALL BE PRESENT DURING ALL CLOSURE HOURS, INCLUDING LUNCH HOUR, AND NO ADDITIONAL COMPENSATION SHALL BE APPLIED.
- ALL TRAFFIC CONTROL DEVICES SHALL BE SKID MOUNTED
- EXCAVATION ADJACENT TO EDGE OF PAVEMENT SHALL BE PROTECTED WITH EXTENDED LEG BARRICADES WITH APPROPRIATE LIGHTS.
- ANY SIGNS DISTURBED DURING CONSTRUCTION SHALL BE PROTECTED AND RESTORED ACCORDING TO ARTICLE 107.25 OF THE STANDARD SPECIFICATIONS.
- THE CONTRACTOR SHALL VERIFY ALL DIMENSIONS AND CONDITIONS IN THE FIELD PRIOR TO CONSTRUCTION AND ORDERING OF MATERIALS.
- ALL SAW CUTTING FOR REMOVAL ITEMS SHALL BE INCLUDED IN THE COST OF THE REMOVAL ITEM. ALL SAWCUTS SHALL BE FULL DEPTH IN ORDER TO PREVENT DAMAGE TO THE PAVEMENT REMAINING IN PLACE. THIS COST IS INCLUDED IN THE REMOVAL ITEM.
- AREAS PAID FOR AS "PAVEMENT REMOVAL" SHALL INCLUDE THE REMOVAL OF CURB AND GUTTER, AGGREGATE, AND ANY OTHER MATERIALS WITHIN THE REMOVAL LIMITS SHOWN IN THE PLANS. NO ADDITIONAL COMPENSATION SHALL BE ALLOWED.
- AN ESTIMATED 90 TONS OF BITUMINOUS SURFACE WILL BE REMOVED DURING MILLING OPERATIONS.
- ALL NUTRIENTS REQUIRED FOR "SEEDING, CLASS 2A" SHALL BE INCLUDED IN THE COST OF "SEEDING, CLASS 2A" AND NO ADDITIONAL COMPENSATION SHALL BE ALLOWED.
- IF AT ANY POINT DURING THE MILLING OPERATION THE CONCRETE BASE IS ENCOUNTERED, THE MILLING DEPTH SHALL BE REDUCED SO THAT THE CONCRETE BASE IS NOT DISTURBED.
- IF THE MILLING OPERATION DOES NOT REMOVE ALL CONFLICTING EXISTING PAVEMENT MARKING, THE REQUIRED REMOVAL SHALL BE PAID FOR AS "WORK ZONE PAVEMENT MARKING REMOVAL". AN ADDITIONAL 80 SQ. FT. HAS BEEN INCLUDED IN THE PLANS.

STANDARDS

- 482001
- 482011-01
- 606001-02
- 630001-06
- 701006-02
- 701011-01
- 701201-02
- 701301-02
- 701306-01
- 701311-02
- 701326-02
- 701501-03
- 702001-06
- 780001-01
- 781001-02
- 000001-04
- 001001
- 001006

INDEX OF SHEETS

- COVER SHEET
- INDEX OF SHEETS, GENERAL NOTES STANDARDS & COMMITMENTS
- SUMMARY OF QUANTITIES
- MISCELLANEOUS SCHEDULES
- 6. TYPICAL SECTIONS
- 8. PLAN VIEW
- PAVEMENT MARKING
- 11. DETAILS
- 16. CROSS SECTIONS

COMMITMENTS

COMMITMENTS FOR THIS PROJECT ARE AS FOLLOWS:
NONE

REVISIONS	
NAME	DATE

ILLINOIS DEPARTMENT OF TRANSPORTATION
GENERAL NOTES, INDEX OF SHEETS
STANDARDS & COMMITMENTS
FAP ROUTE 592
SECTION 1211-1
ST. CLAIR COUNTY

SCALE: VERT. _____
HORIZ. _____
DATE _____ DRAWN BY _____
CHECKED BY _____

PLOT DATE = 2/9/2006
FILE NAME = c:\projects\add8705\plan\plan0705a.dgn
PLOT SCALE = 1/8" = 1'-0"
REFERENCE = REF#

SUMMARY OF QUANTITIES

F.A.P. RTE.	SECTION	COUNTY	TOTAL SHEETS	SHEET NO.
592	1211-1	ST. CLAIR	16	3
STA.		TO STA.		
FED. ROAD DIST. NO.		ILLINOIS FED. AID PROJECT		

SUMMARY OF QUANTITIES			CONSTRUCTION TYPE CODE			
CODE NO	ITEM	UNIT	TOTAL QUANTITIES	URBAN 90% FED 10% STATE 1000-1A	-----	-----
20200100	EARTH EXCAVATION	CU YD	232	232		
25000210	SEEDING, CLASS 2A	ACRE	0.1	0.1		
25100115	MULCH, METHOD 2	ACRE	0.1	0.1		
28000250	TEMPORARY EROSION CONTROL SEEDING	POUND	10	10		
31101200	SUB-BASE GRANULAR MATERIAL, TYPE B 4"	SQ YD	71	71		
35101400	AGGREGATE BASE COURSE, TYPE B	TON	460	460		
35400500	PORTLAND CEMENT CONCRETE BASE COURSE WIDENING 10"	SQ YD	247	247		
40600200	BITUMINOUS MATERIALS (PRIME COAT)	TON	0.7	0.7		
40600300	AGGREGATE (PRIME COAT)	TON	3	3		
40600990	TEMPORARY RAMP	SQ YD	71	71		
44000030	BITUMINOUS SURFACE REMOVAL (VARIABLE DEPTH)	SQ YD	1971	1971		
44000100	PAVEMENT REMOVAL	SQ YD	406	406		
44003100	MEDIAN REMOVAL	SQ FT	648	648		
44004250	PAVED SHOULDER REMOVAL	SQ YD	160	160		
44200172	PAVEMENT PATCHING, TYPE III, 14 INCH	SQ YD	16	16		
44300200	STRIP REFLECTIVE CRACK CONTROL TREATMENT	FOOT	739	739		
48202600	BITUMINOUS SHOULDERS SUPERPAVE 8"	SQ YD	157	157		
60603800	COMBINATION CONCRETE CURB AND GUTTER, TYPE B-6.12	FOOT	468	468		
60618300	CONCRETE MEDIAN SURFACE, 4 INCH	SQ FT	1116	1116		
60619600	CONCRETE MEDIAN, TYPE SB-6.12	SQ FT	209	209		
63300900	VERTICAL ADJUSTMENT OF GUARD RAIL	FOOT	24	24		
63300930	VERTICAL ADJUSTMENT OF TRAFFIC BARRIER TERMINAL, TYPE 1A	EACH	1	1		
67000400	ENGINEER'S FIELD OFFICE, TYPE A	CAL MO	5	5		
67100100	MOBILIZATION	L SUM	1	1		
70100450	TRAFFIC CONTROL AND PROTECTION, STANDARD 701201	L SUM	1	1		
70100460	TRAFFIC CONTROL AND PROTECTION, STANDARD 701306	L SUM	1	1		
70100500	TRAFFIC CONTROL AND PROTECTION, STANDARD 701326	L SUM	1	1		
70103815	TRAFFIC CONTROL SURVEILLANCE	CAL DA	20	20		
70300100	SHORT-TERM PAVEMENT MARKING	FOOT	405	405		
70300210	TEMPORARY PAVEMENT MARKING - LETTERS AND SYMBOLS	SQ FT	93	93		
70300220	TEMPORARY PAVEMENT MARKING - LINE 4"	FOOT	3082	3082		
70300260	TEMPORARY PAVEMENT MARKING - LINE 12"	FOOT	224	224		
70301000	WORK ZONE PAVEMENT MARKING REMOVAL	SQ FT	1324	1324		

SUMMARY OF QUANTITIES			CONSTRUCTION TYPE CODE			
CODE NO	ITEM	UNIT	TOTAL QUANTITIES	URBAN 90% FED 10% STATE 1000-1A	-----	-----
* 72000100	SIGN PANEL - TYPE 1	SQ FT	9	9		
* 73000100	WOOD SIGN SUPPORT	FOOT	29	29		
* 78000100	THERMOPLASTIC PAVEMENT MARKING - LETTERS AND SYMBOLS	SQ FT	93	93		
* 78000200	THERMOPLASTIC PAVEMENT MARKING - LINE 4"	FOOT	3082	3082		
* 78000600	THERMOPLASTIC PAVEMENT MARKING - LINE 12"	FOOT	224	224		
* 78000650	THERMOPLASTIC PAVEMENT MARKING - LINE 24"	FOOT	26	26		
* 78100100	RAISED REFLECTIVE PAVEMENT MARKER	EACH	34	34		
* 78200300	PRISMATIC CURB REFLECTOR	EACH	24	24		
X3560140	BITUMINOUS CONCRETE BASE COURSE WIDENING, SUPERPAVE 10 INCH	SQ YD	127	127		
X4066528	POLYMERIZED BITUMINOUS CONCRETE SURFACE COURSE, SUPERPAVE, MIX "D", N90	TON	166	166		
* X7800100	PAINT PAVEMENT MARKING - RAISED MEDIAN	SQ FT	219	219		
* X7800200	PAINT PAVEMENT MARKING CURB	FOOT	124	124		
*SPECIALTY ITEMS						

PLOT DATE = 2/9/2006
 FILE NAME = c:\pcc\mca\ed9705\plan\p108705.dgn
 PLOT SCALE = 1/8" = 1'-0"
 REFERENCE = #REF#

F.A.P. RTE.	SECTION	COUNTY	TOTAL SHEETS	SHEET NO.
592	121I-1	ST. CLAIR	16	4
STA.		TO STA.		
FED. ROAD DIST. NO.		ILLINOIS FED. AID PROJECT		

RESURFACING SCHEDULE

LOCATION	BIT. MAT'L PRIME COAT (TON)	AGGREGATE PRIME COAT (TON)	SURFACE COURSE (TON)	PAVED SHOULDER REMOVAL (SQ YD)	BITUMINOUS SURFACE REMOVAL (VARIABLE DEPTH) (SQ YD)	BITUMINOUS BASE COURSE WIDENING 10" (SQ YD)	AGGREGATE BASE COURSE TYPE B (SQ YD)	BITUMINOUS SHOULDER 8" (SQ YD)	STRIP REFLECTIVE CRACK CONTROL TREATMENT (FOOT)	TEMPORARY RAMPS (SQ YD)
STA TO STA										
IL 157										
276+15.58 TO 277+50.21	0.07	0.36	20.41	44.88	265.52			44		8.33
277+50.21 TO 277+96.45	0.04	0.17	9.30	15.41	117.45			17		
277+96.45 TO 278+32.40	0.03	0.15	8.61	11.98	102.18	7.98	27.68	12	203.95	
278+32.40 TO 278+58.61	0.02	0.09	5.09	8.74	61.16	5.82	27.11	7	26.21	
278+58.61 TO 279+11.27	0.04	0.2	11.07	17.55	131.65	17.4	55.39	17	52.66	
279+11.27 TO 279+65.11	0.05	0.22	12.3	17.95	134.60	26.23	110	18	53.84	
279+65.11 TO 279+82.74	0.02	0.1	5.37	5.88	63.92	9.01	212.75	6	17.63	
279+82.74 TO 280+94.37	0.10	0.45	25.18	37.21	260.47	61	27.03	36	258.89	
280+94.37 TO 281+30.00	0.02	0.12	6.47		71.50					19.78
281+30.00 TO 284+00.00	0.17	0.82	45.79		548.40				92.16	34.66
284+00.00 TO 285+03.88	0.06	0.31	17.48		213.76				32.92	7.55
TOTAL =	0.7	3	166	160	1971	127	460	157	739	71

MEDIAN SCHEDULE

LOCATION	PAVEMENT REMOVAL (SQ YD)	SUB-BASE GRANULAR MATERIAL TYPE B 4" (SQ YD)	P. C. C. BASE COURSE WIDENING, 10" (SQ YD)	COMBINATION CURB & GUTTER (FOOT)	CONCRETE MEDIAN SURFACE 4" (SQ FT)	CONCRETE MEDIAN (SQ FT)	MEDIAN REMOVAL (SQ FT)
277+96.45 TO 279+65.11	188.00		91.73	231.15	447.00	107.00	
279+82.74 TO 281+30.00	217.30		87.36	235.95	669.00	102.00	
281+96.56 TO 282+17.59		12.50	11.50				103.50
282+72.84 TO 282+94.47		13.24	12.24				108.50
283+48.79 TO 283+96.29		26.35	25.33				228.00
284+62.35 TO 284+95.27		18.80	18.80				207.50
TOTALS	406	71	247	468	1116	209	648

PAVEMENT MARKING

LOCATION	THERMOPLASTIC PAVEMENT MARKING										RAISED REFLECTIVE PAVEMENT MARKERS		PRISMATIC CURB REFLECTORS	PAINT PAVEMENT MARKING-RAISED MEDIAN	PAINT PAVEMENT MARKING CURB	
	4"										LETTERS & SYMBOLS	ONE WAY CRYSTAL				ONEWAY AMBER
	SOLID YELLOW EDGE LINE	SOLID WHITE LANE LINE	SOLID WHITE EDGE LINE	SOLID WHITE DASHED	SOLID DOUBLE YELLOW LANE - MEDIAN	SOLID YELLOW DIAGONAL	RAILROAD GRADE-CROSSING	LEFT TURN ARROW	FOOT	FOOT						
IL 157																
276+16 TO 276+50			34	22												
276+50 TO 277+00			50	26												
277+00 TO 277+50			50	26	77	1							2			
277+50 TO 278+00			50		200	7							4			
278+00 TO 278+50			50		136	6							2		30.5	8.5
278+50 TO 279+00	100		50										2		44	44
279+00 TO 279+50	100	39	50							15.6	2		2		43.5	25
279+50 TO 280+00		50	50								3		8		66	44
280+00 TO 280+50	100	50	50								2		2		44	44
280+50 TO 281+00	100	50	50							15.6	2		4		42	42
281+00 TO 281+50	37	5	3								3		3		27.5	12
281+50 TO 282+00			13		4											
282+00 TO 282+50			50		100	41							2			
282+50 TO 283+00			50		200	38							4			
283+00 TO 283+50			50		200	25	13		61.2				2			
283+50 TO 284+00			50		200	31	13						2			
284+00 TO 284+50			50		200	38							2			
284+50 TO 285+00			50		180	37							4			
285+00 TO 285+04			4													
SUB-TOTALS	513	194	804	74	1497	224	26	92.4	10	24	24	24	124	219		
TOTALS			3082			224	26	93	34	24	24	24	124	219		

EROSION CONTROL SCHEDULE

LOCATION	TEMP. EROSION CONTROL SEEDING (lb)	SEEDING CL 2 (cc)	NITROGEN FERTILIZER NUTRIENT (lb)	PHOSPHORUS FERTILIZER NUTRIENT (lb)	POTASSIUM FERTILIZER NUTRIENT (lb)	MULCH METHOD 2 (cc)
276+15 TO 276+50	1.06	0.01	0.21	0.21	0.21	0.01
276+50 TO 277+00	1.13	0.01	0.23	0.23	0.23	0.01
277+00 TO 277+50	1.90	0.01	0.38	0.38	0.38	0.01
277+50 TO 278+00	2.00	0.01	0.40	0.40	0.40	0.01
278+00 TO 278+50	0.71	0.01	0.14	0.14	0.14	0.01
278+50 TO 279+00	0.69	0.01	0.14	0.14	0.14	0.01
279+00 TO 279+50	0.54	0.01	0.11	0.11	0.11	0.01
279+50 TO 280+00	0.37	0.01	0.07	0.07	0.07	0.01
280+00 TO 280+50	0.43	0.01	0.09	0.09	0.09	0.01
280+50 TO 281+00	0.49	0.01	0.10	0.10	0.10	0.01
TOTAL =	10	0.10	2*	2*	2*	0.10

* SEE GENERAL NOTE #19 ON SHEET NO. 2

EARTHWORK SCHEDULE

STA	to	STA	UNADJUSTED EXCAVATION (CU YD)	EARTH EXCAVATION ADJUSTED FOR 25% SHINKAGE (CU YD)	EMBANKMENT (CU YD)	EARTHWORK BALANCE WASTE (+) OR SHORTAGE (-) (CU YD)
276+15.58	to	276+50.00	0.0	0.0	0.3	-0.3
276+50.00	to	277+00.00	1.9	1.4	0.4	1.0
277+00.00	to	277+50.00	6.6	5.0	0.0	5.0
277+50.00	to	278+00.00	16.4	12.3	0.0	12.3
278+00.00	to	278+50.00	23.2	17.4	0.1	17.3
278+50.00	to	279+00.00	26.3	19.7	0.2	19.5
279+00.00	to	279+50.00	32.3	24.2	0.1	24.1
279+50.00	to	280+00.00	36.6	27.5	0.0	27.5
280+00.00	to	280+50.00	38.4	28.8	0.0	28.8
280+50.00	to	281+00.00	36.7	27.5	0.1	27.4
281+00.00	to	281+30.00	12.7	9.5	0.0	9.5
SUB-TOTAL			232	174	2	173

REVISIONS		ILLINOIS DEPARTMENT OF TRANSPORTATION
NAME	DATE	
		SCHEDULES FAP ROUTE 592 SECTION 121I-1 ST. CLAIR COUNTY SCALE: VERT. _____ HORIZ. _____ DATE _____

PLOT DATE = 2/10/2006
 FILE NAME = c:\p\projects\480795\plan\plan8785.dgn
 PLOT SCALE = 50.0000 / IN.
 REFERENCE = SHEET #

F.A.P. RTE.	SECTION	COUNTY	TOTAL SHEETS	SHEET NO.
592	1211-1	ST. CLAIR	16	5
STA.		TO STA.		
FED. ROAD DIST. NO.		ILLINOIS FED. AID PROJECT		

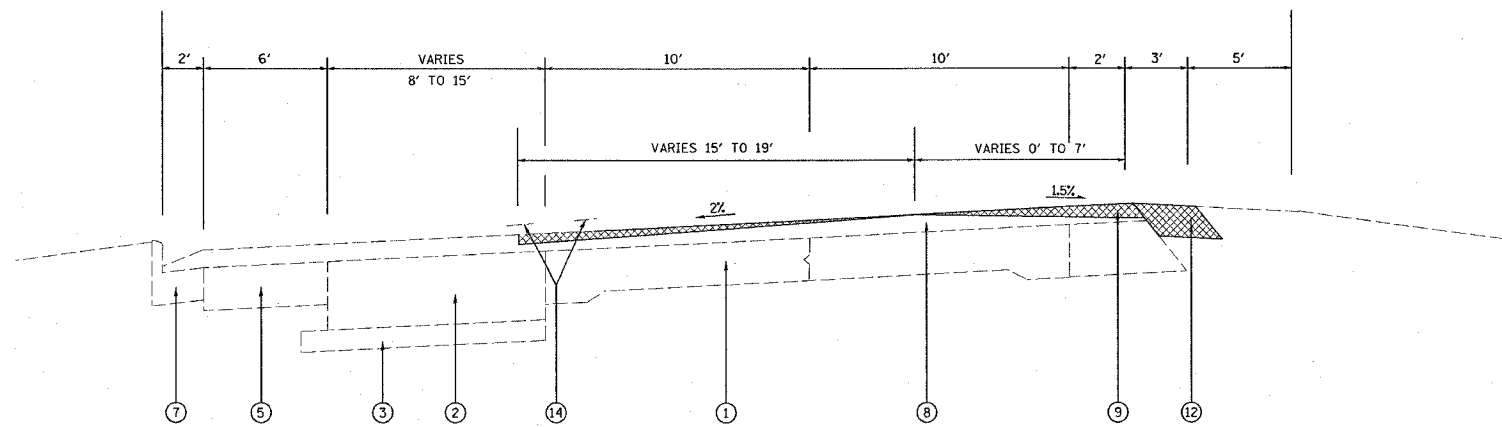

EXISTING TYPICAL SECTION
STA. 276+15.6 TO STA. 277+96.5

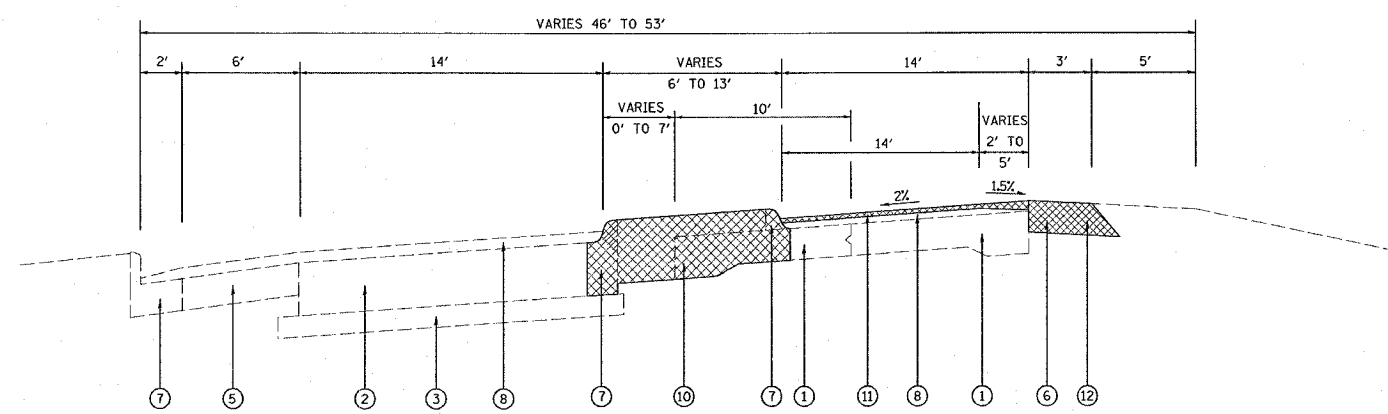

EXISTING TYPICAL SECTION
STA. 277+96.5 TO STA. 280+98.5

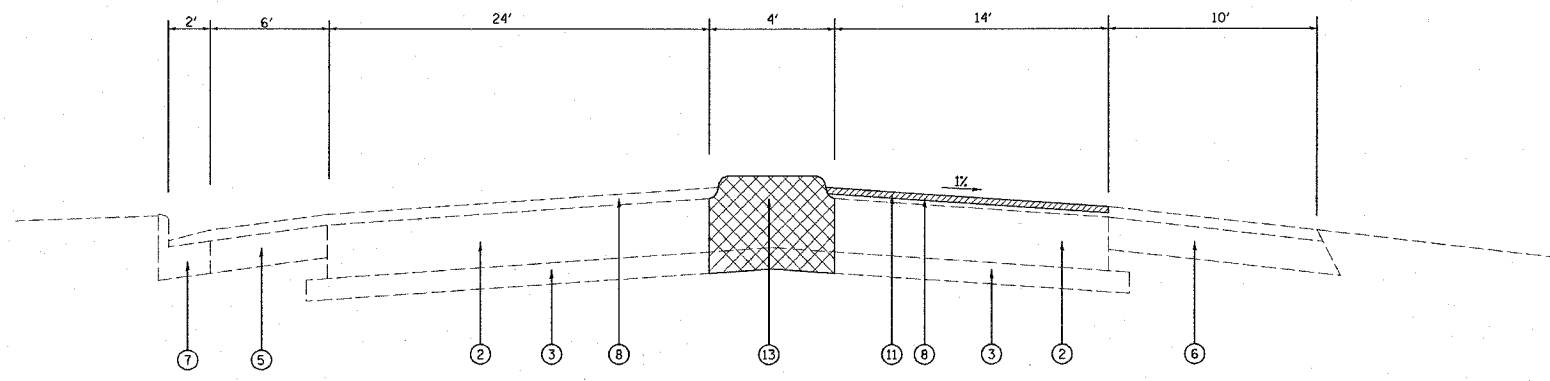

EXISTING TYPICAL SECTION
STA. 280+98.5 TO STA. 285+03.9

- LEGEND**
- ① EXISTING P.C.C. PAVEMENT, 9"6"9"
 - ② EXISTING P.C.C. PAVEMENT, 10"
 - ③ EXISTING GRANULAR SUB-BASE
 - ④ EXISTING BITUMINOUS WIDENING, 10 3/4"
 - ⑤ EXISTING AGGREGATE SHOULDER WITH BITUMINOUS SURFACE TREATMENT
 - ⑥ EXISTING BITUMINOUS SHOULDER
 - ⑦ EXISTING COMBINATION CONCRETE CURB & GUTTER
 - ⑧ EXISTING BITUMINOUS RESURFACING
 - ⑨ EXISTING AGGREGATE SHOULDERS, 6"
 - ⑩ PROPOSED PAVEMENT REMOVAL
 - ⑪ PROPOSED BITUMINOUS SURFACE REMOVAL VARIABLE DEPTH
 - ⑫ PROPOSED BITUMINOUS SHOULDER REMOVAL
 - ⑬ PROPOSED CONCRETE MEDIAN REMOVAL
 - ⑭ PROPOSED PAVEMENT MARKING REMOVAL*

* SEE GENERAL NOTE #21 ON SHEET NO. 2

PLOT DATE = 2/9/2006
FILE NAME = c:\pwork\mst\ad85785\plan\p1n08705a.dgn
PLOT SCALE = 5/8"=1'-0" / IN.
REFERENCE = #REF#

REVISIONS		ILLINOIS DEPARTMENT OF TRANSPORTATION	
NAME	DATE		

TYPICAL SECTIONS
FAP ROUTE 592 (IL 157)
SECTION 1211-1
ST. CLAIR COUNTY

SCALE: VERT. _____
HORIZ. _____
DATE _____

DRAWN BY _____
CHECKED BY _____

F.A.P. RTE.	SECTION	COUNTY	TOTAL SHEETS	SHEET NO.
592	1211-1	ST. CLAIR	16	6
STA. TO STA.				
FED. ROAD DIST. NO. ILLINOIS FED. AID PROJECT				

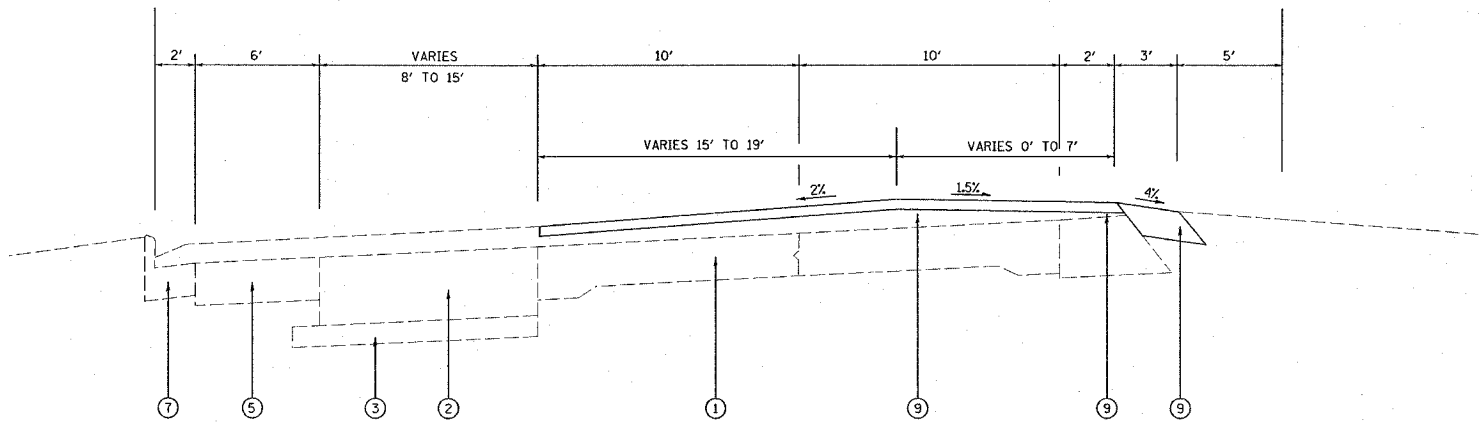

PROPOSED TYPICAL SECTION
STA. 276+15.6 TO STA. 277+96.5

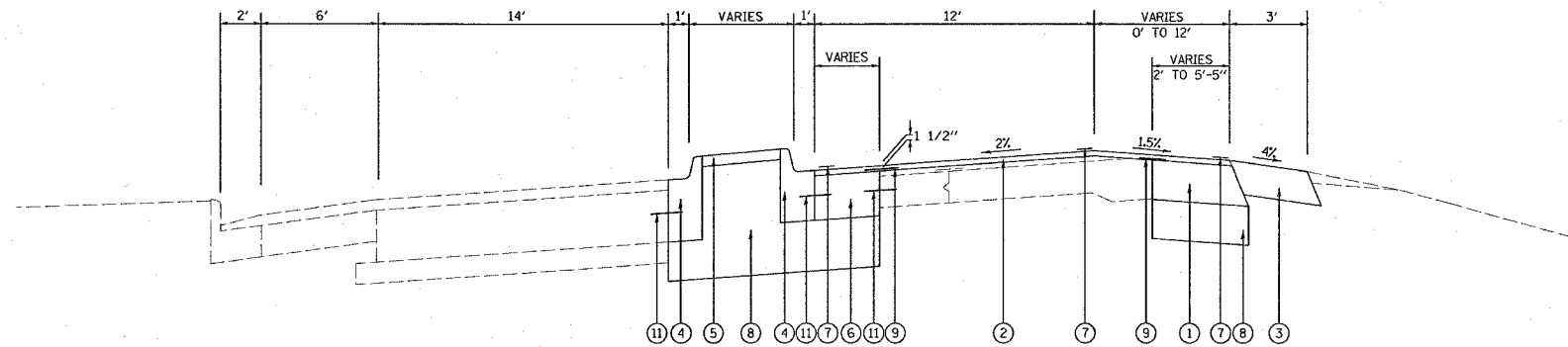

PROPOSED TYPICAL SECTION
STA. 278+10.00 TO STA. 281+28.00

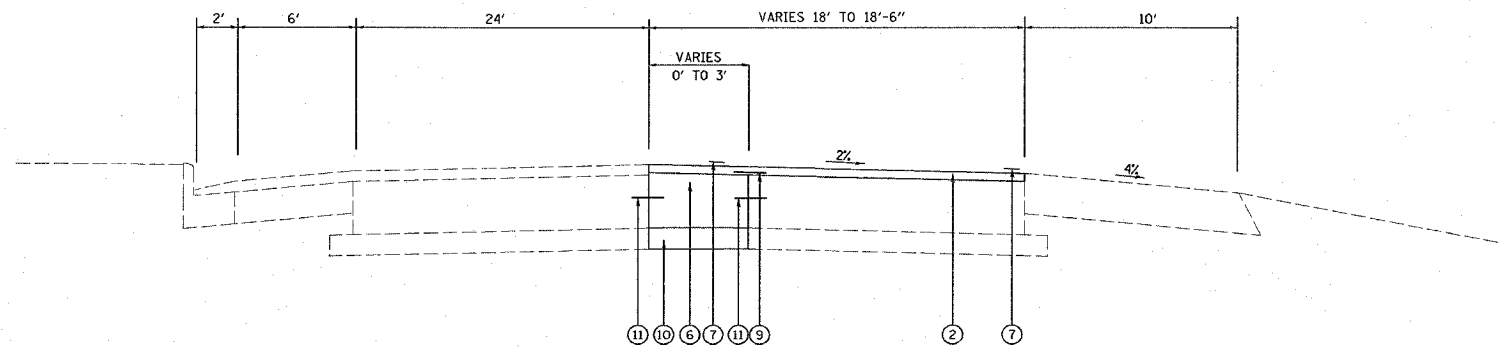

PROPOSED TYPICAL SECTION
STA. 281+28.00 TO STA. 285+03.88

LEGEND

- ① PROPOSED BITUMINOUS BASE COURSE WIDENING, 10"
- ② PROPOSED BITUMINOUS SURFACE COURSE 1 1/2"
- ③ PROPOSED BITUMINOUS SHOULDER, 8"
- ④ PROPOSED COMBINATION CONCRETE CURB AND GUTTER, TYPE B-6.12
- ⑤ PROPOSED CONCRETE MEDIAN SURFACE, 4"
- ⑥ PROPOSED P.C.C. BASE COURSE, 10"^{WIDENING}
- ⑦ PROPOSED THERMOPLASTIC PAVEMENT MARKING, 4"
- ⑧ PROPOSED AGGREGATE BASE COURSE, TYPE B*
- ⑨ PROPOSED STRIP REFLECTIVE CRACK CONTROL TREATMENT
- ⑩ PROPOSED SUB-BASE GRANULAR MATERIAL TYPE B
- ⑪ PROPOSED #20 TIE BARS, 36" @ 15" CENTERS

* AGGREGATE BASE COURSE SHALL BE 12" MINIMUM DEPTH

PLOT DATE = 2/9/2006
FILE NAME = c:\pave\meta\483785\plan\081705a.dgn
PLOT SCALE = 50,0000' / IN.
REFERENCE = #REF#

REVISIONS		ILLINOIS DEPARTMENT OF TRANSPORTATION
NAME	DATE	
		TYPICAL SECTIONS FAP ROUTE 592 (IL 157) SECTION 1211-1 ST. CLAIR COUNTY SCALE: VERT. _____ HORIZ. _____ DATE _____

Rev.

DRAWN BY
CHECKED BY

F.A.P. RTE.	SECTION	COUNTY	TOTAL SHEETS	SHEET NO.
592	121I-1	ST. CLAIR	16	7
STA. 276+15.58		TO STA. 280+80		
FED. ROAD DIST. NO.		ILLINOIS	FED. AID PROJECT	

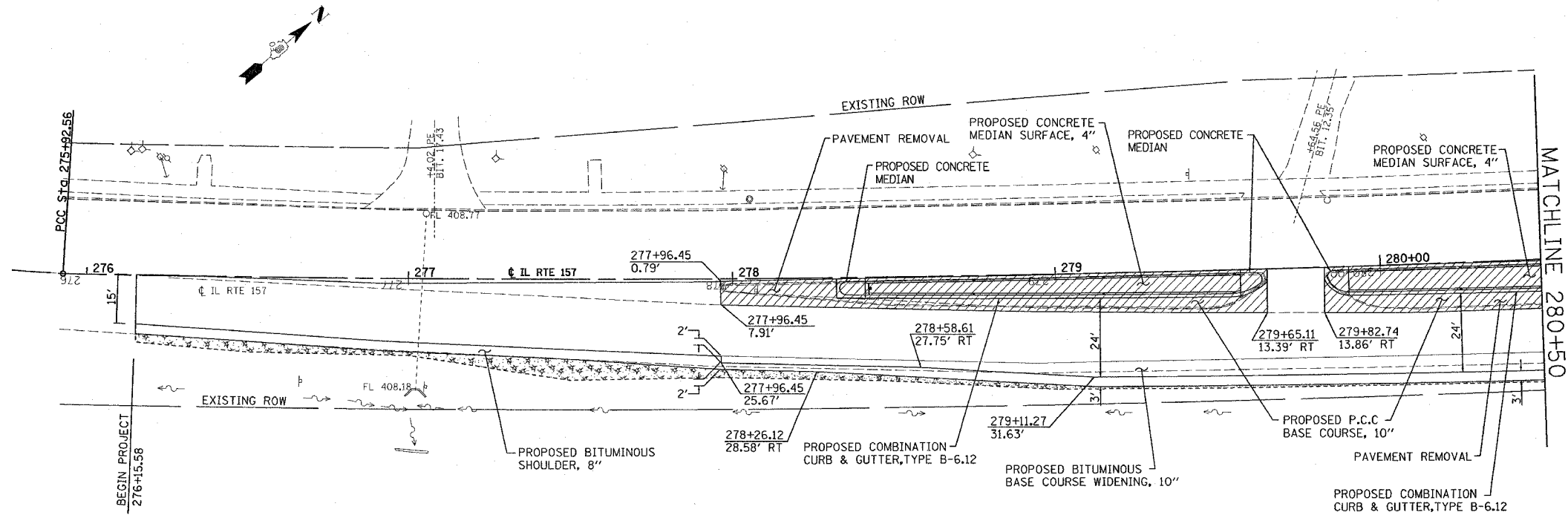

PROP. CURVE 157-2
 PI STA. = 278+70.25
 $\Delta = 4^\circ 23' 30''$ (LT)
 $D = 0^\circ 47' 28''$
 $R = 7,242.01'$
 $T = 277.69'$
 $L = 555.10'$
 $E = 5.32'$
 $e = \text{-----}$
 $T.R. = \text{-----}$
 $S.E. \text{ RUN} = \text{-----}$
 $P.C. \text{ STA} = 275+92.56$
 $P.T. \text{ STA} = 281+47.67$

 SEEDING AND MULCH AREAS

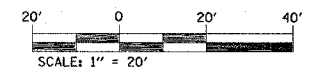

PLOT DATE = 2/9/2006
 FILE NAME = c:\projects\121I-1\121I-1.dgn
 PLOT SCALE = 20.0000 / 1 IN.
 USER NAME = bergnd

REVISIONS	
NAME	DATE

ILLINOIS DEPARTMENT OF TRANSPORTATION
PLAN VIEW
 FAP ROUTE 592
 SECTION 121I-1
 ST. CLAIR COUNTY

SCALE: VERT. _____
 HORIZ. _____
 DATE _____

DRAWN BY _____
 CHECKED BY _____

F.A.P. RTE.	SECTION	COUNTY	TOTAL SHEETS	SHEET NO.
592	1211-1	ST. CLAIR	16	8
STA. 280+50		TO STA. 285+03.88		
FED. ROAD DIST. NO.		ILLINOIS FED. AID PROJECT		

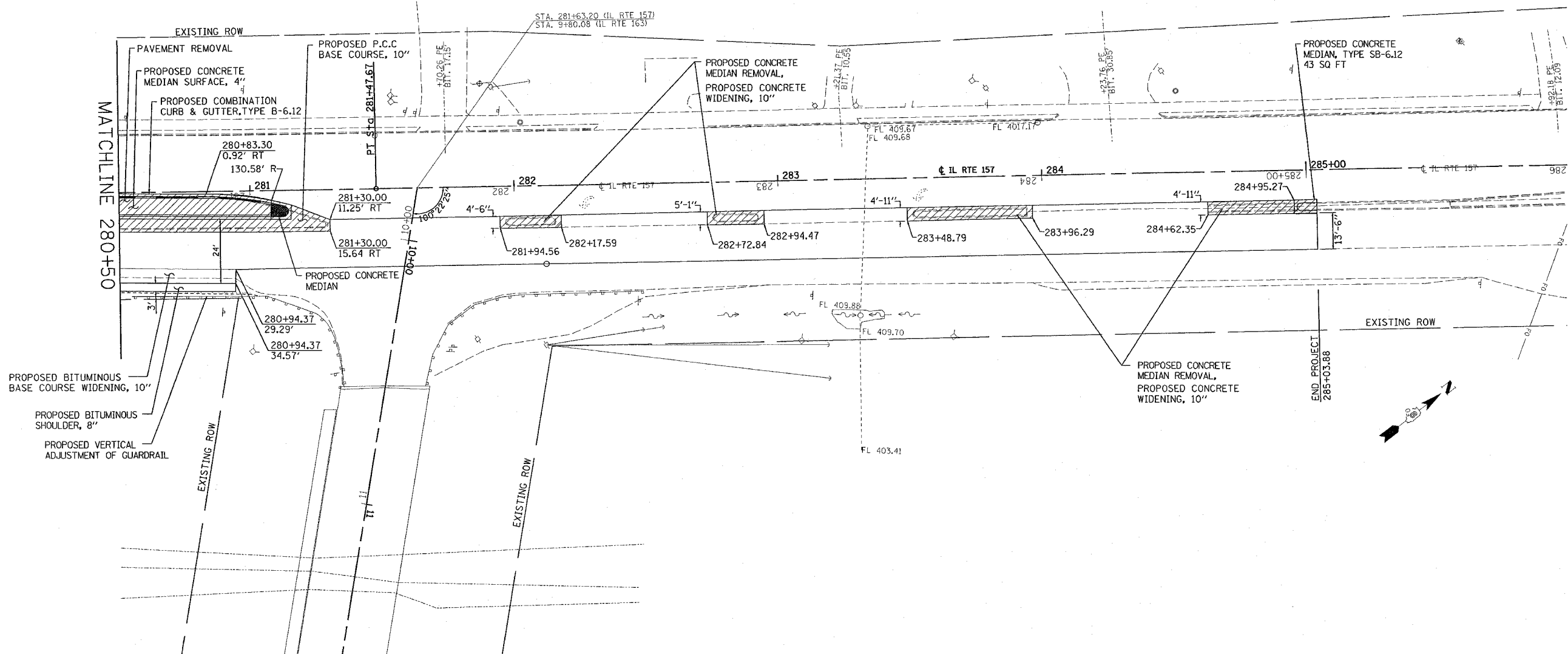

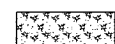
 - SEEDING AND MULCH AREAS

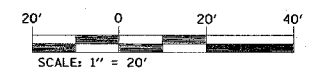

REVISIONS	
NAME	DATE

ILLINOIS DEPARTMENT OF TRANSPORTATION

PLAN VIEW

FAP ROUTE 592
SECTION 1211-1
ST. CLAIR COUNTY

SCALE: VERT. _____
HORIZ. _____

DATE _____ DRAWN BY _____
CHECKED BY _____

PLOT DATE = 2/9/2006
 PLOT SCALE = 20,000/1
 USER NAME = bengard

F.A.P. SECTION	COUNTY	TOTAL SHEETS	SHEET NO.
592 1211-1	ST. CLAIR	16	9
STA. 276+15.58 TO STA. 280+50			
FED. ROAD DIST. NO. ILLINOIS FED. AID PROJECT			

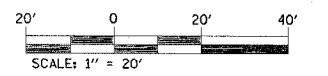
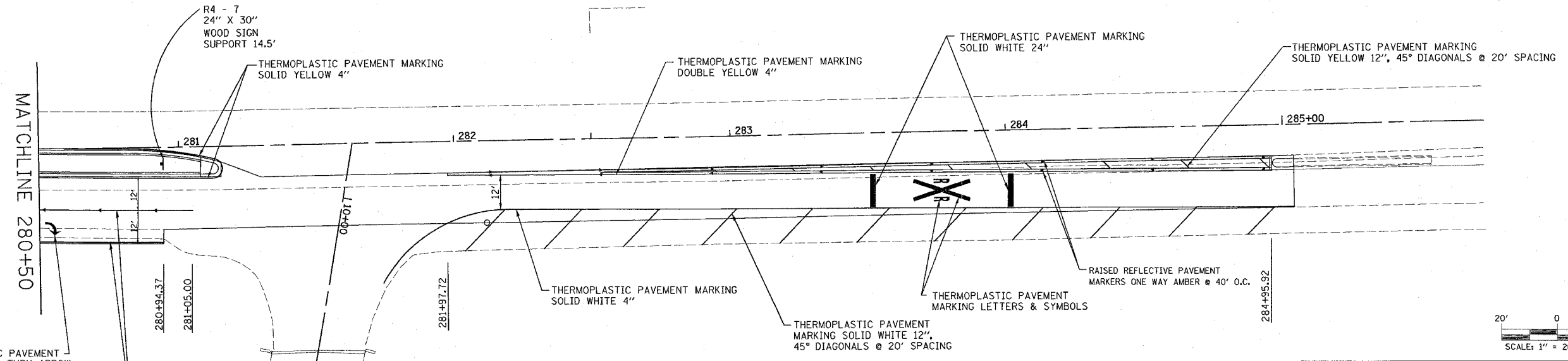
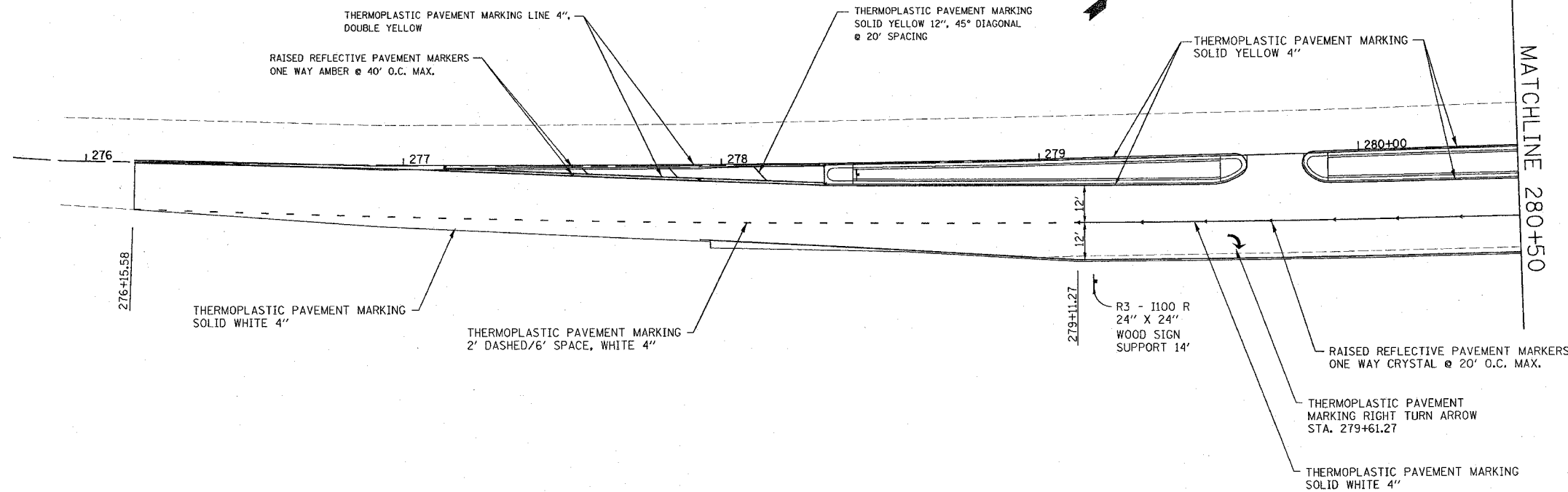

REVISIONS	
NAME	DATE

ILLINOIS DEPARTMENT OF TRANSPORTATION
PAVEMENT MARKING
 FAP ROUTE 592
 SECTION 1211-1
 ST. CLAIR COUNTY
 SCALE: VERT. 1" = 20'
 HORIZ. 1" = 40'
 DATE: DRAWN BY: CHECKED BY:

PLOT DATE = 2/7/2006
 FILE NAME = \\s01\p1\99785\plan\p1\99785.dgn
 PLOT SCALE = 20/1000 = 1/50
 USER NAME = dntelmen,jr

F.A.P. RTE.	SECTION	COUNTY	TOTAL SHEETS	SHEET NO.
609	1211-1	ST. CLAIR	16	11
STA. 280+50		TO STA. 285+03.88		
FED. ROAD DIST. NO.	ILLINOIS	FED. AID PROJECT		

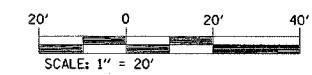
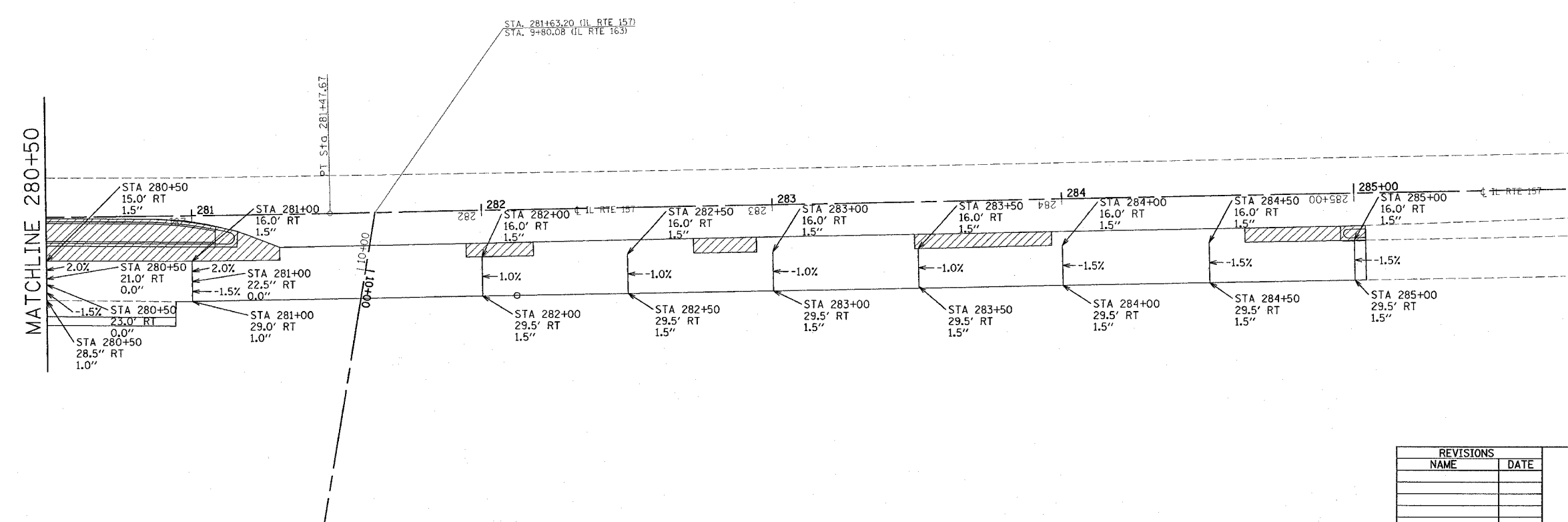
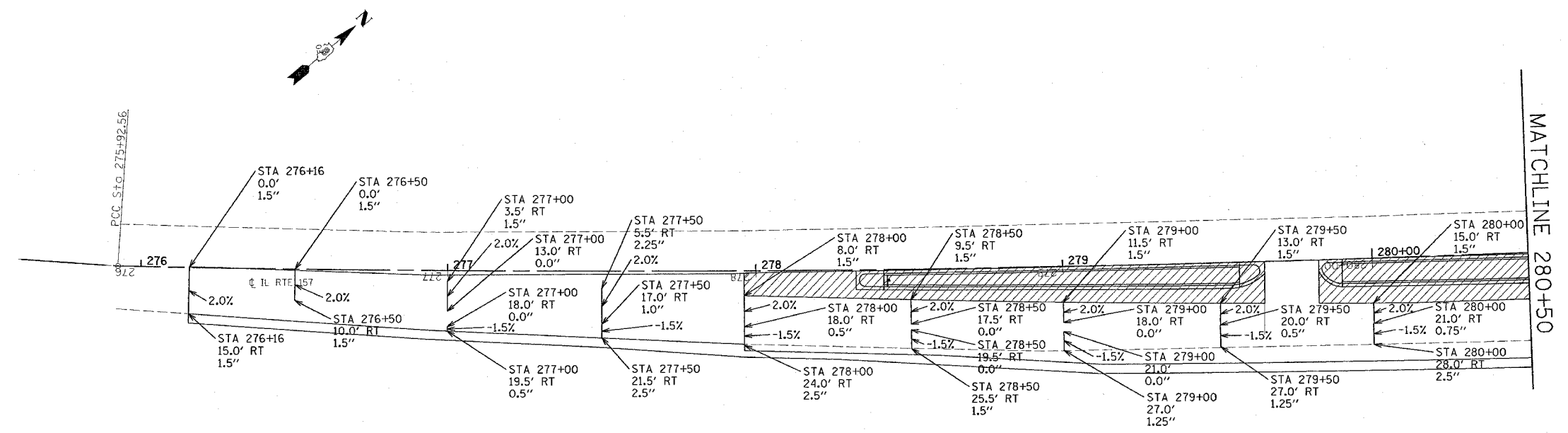

PLOT DATE = 2/9/2005
 FILE NAME = c:\projects\76956\plan\p11.dwg
 PLOT SCALE = 20.0000 / 1.00
 USER NAME = bergind

REVISIONS	
NAME	DATE

ILLINOIS DEPARTMENT OF TRANSPORTATION
**MILLING
 DETAILS**
 FAP ROUTE 592
 SECTION 1211-1
 ST. CLAIR COUNTY
 SCALE: VERT. _____
 DATE _____ HORIZ. _____
 DRAWN BY _____
 CHECKED BY _____

CONTRACT NO. 76956				
F.A. RTE.	SECTION	COUNTY	TOTAL SHEETS	SHEET NO.
592	1211-1	ST. CLAIR	16	12
STA. 276+15.58		TO STA. 277+00.00		
FED. ROAD DIST. NO. ILLINOIS FED. AID PROJECT				

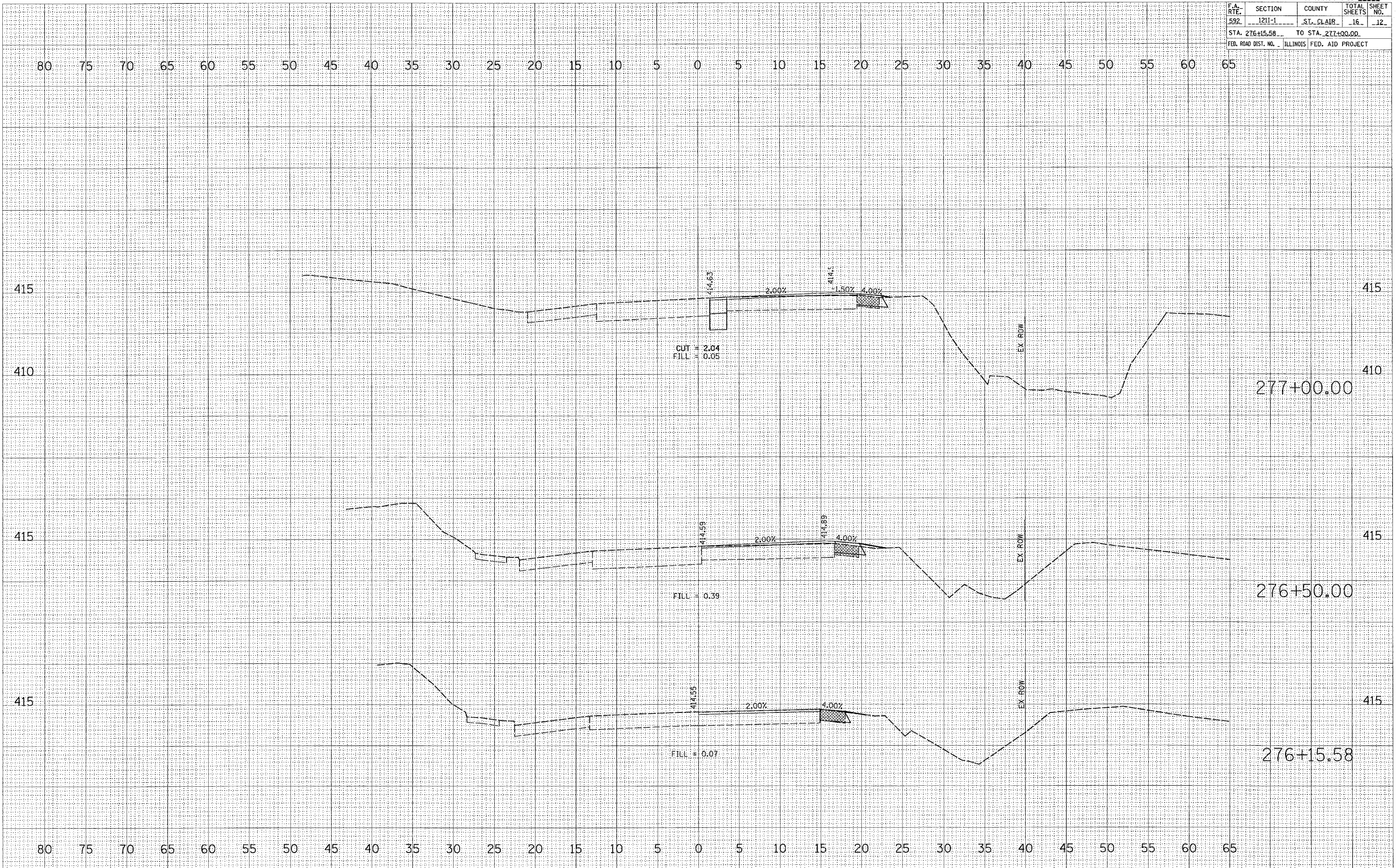

FINAL SURVEY SURVEYED BY DATE
 SURVEY PLOTTED BY DATE
 NOTE BOOK NO.
 AREAS CHECKED

ORIGINAL SURVEY SURVEYED BY DATE
 SURVEY PLOTTED BY DATE
 NOTE BOOK NO.
 AREAS CHECKED

PLOT DATE = 2/2/2006
 FILE NAME = \\server\projects\and\07705\plan\wash\1211\p12.dwg
 PLOT SCALE = 5/8" = 1' IN.
 USER NAME = dmccain

F.A. RTE.	SECTION	COUNTY	TOTAL SHEETS	SHEET NO.
592	1211-1	ST. CLAIR	15	13
STA. 277+50.00 TO STA. 279+00.00				
FED. ROAD DIST. NO. ILLINOIS FED. AID PROJECT				

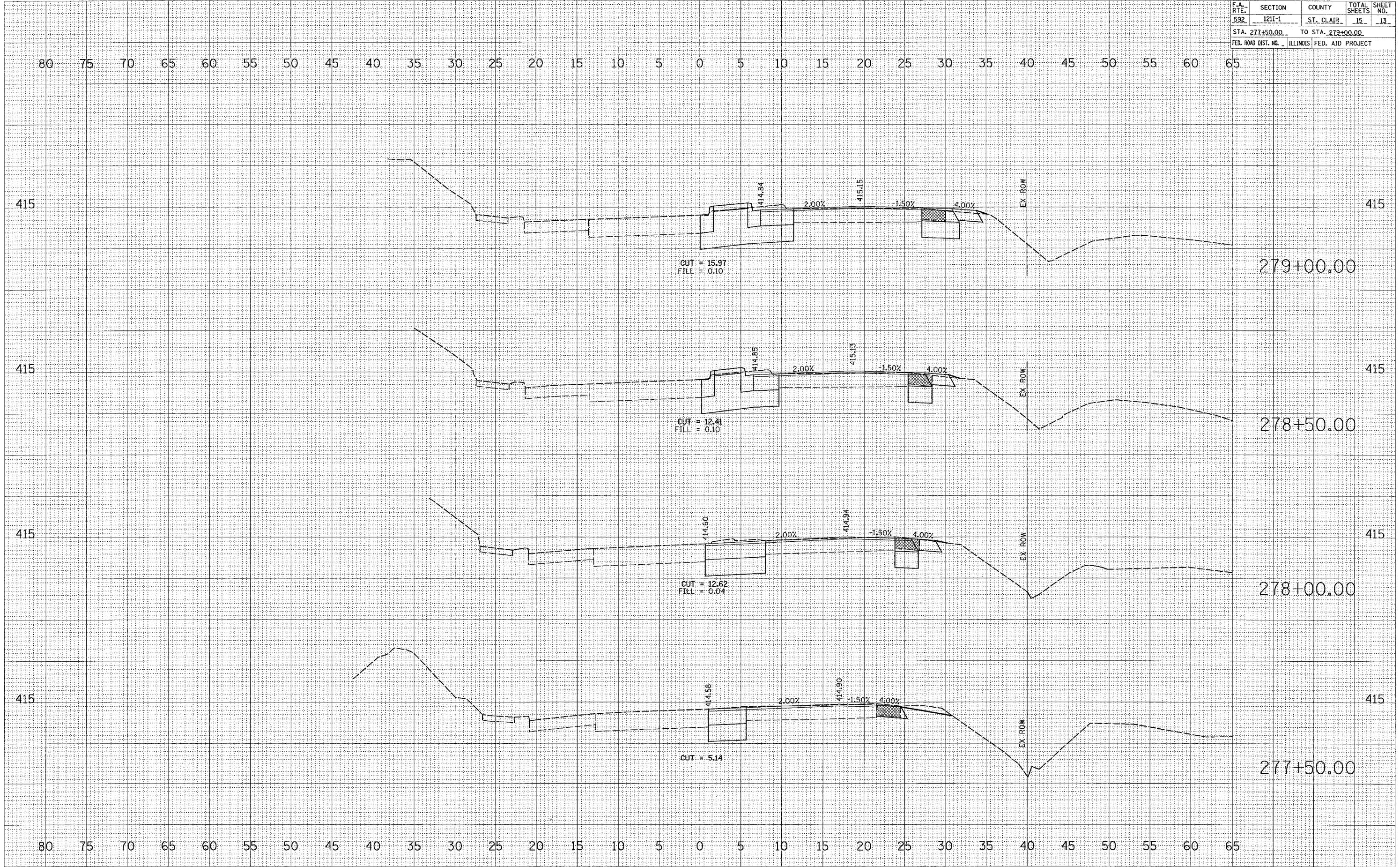

BY _____ DATE _____
 REVISIONS
 SUBMITTED
 PLOTTED
 TEMPLATE
 AREAS
 CHECKED
 NO. _____

ORIGINAL
 SURVEY
 PLOTTED
 TEMPLATE
 AREAS
 CHECKED
 NO. _____

PLOT DATE = 2/9/2006
 FILE NAME = c:\projects\76956\plan\sheet\76956.dwg
 PLOT SCALE = 5,0000 / IN.
 USER NAME = bmgind

F.A. RTE.	SECTION	COUNTY	TOTAL SHEETS	SHEET NO.
592	1211-1	ST. CLAIR	16	14
STA. 279+50.00		TO STA. 281+00.00		
FED. ROAD DIST. NO. ILLINOIS FED. AID PROJECT				

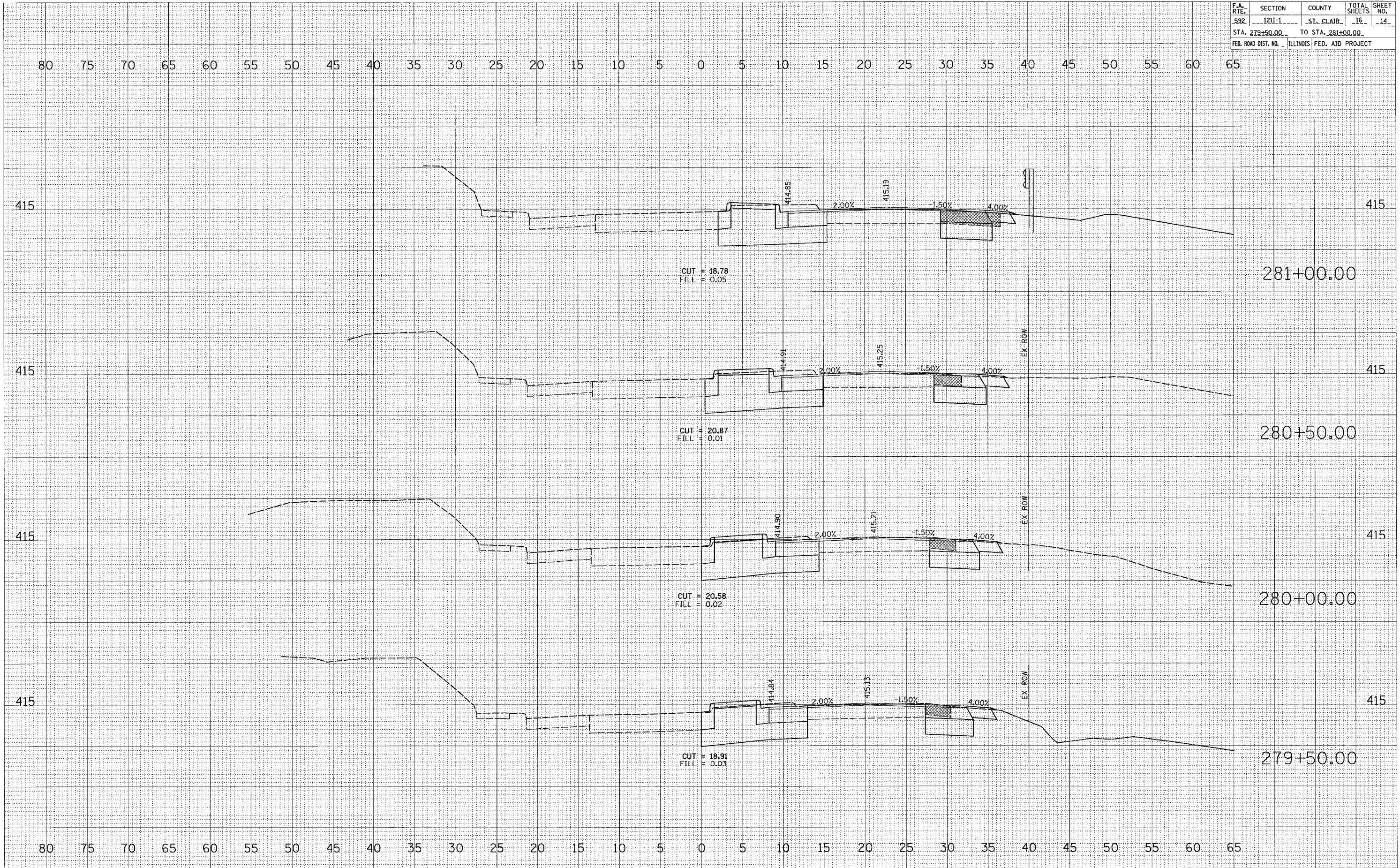

DATE: _____
 BY: _____
 SURVEYED: _____
 PLOTTED: _____
 NOTE BOOK: _____
 NO. _____
 AREAS CHECKED: _____

DATE: _____
 BY: _____
 ORIGINAL SURVEY: _____
 PLOTTED: _____
 TEMPLATE: _____
 NO. _____
 AREAS CHECKED: _____

PLOT DATE = 2/9/2006
 PLOT SCALE = 5/8" = 1' IN
 USER NAME = bmgand

F.A. RTE.	SECTION	COUNTY	TOTAL SHEETS	SHEET NO.
592	1211-1	ST. CLAIR	16	15
STA. 282+00.00		TO STA. 283+50.00		
FED. ROAD DIST. NO.		ILLINOIS	FED. AID PROJECT	

FINAL SURVEY DATE
 SURVEYED BY
 SURVEY NO.
 NOTE BOOK NO.

ORIGINAL SURVEY DATE
 SURVEYED BY
 SURVEY NO.
 NOTE BOOK NO.

PLOT DATE = 2/9/2006
 FILE NAME = c:\p\ro\meta\869785\869785\sheet15.dwg
 PLOT SCALE = 5.0000' / IN.
 USER NAME = bergud

