

F.A.U. RTE.	SECTION	COUNTY	TOTAL SHEETS	SHEET NO.
---	00-P4003-00-BT	WILL	57	13
STA.	120+00	TO STA.	131+70.99	
FED. ROAD DIST. NO. 1 ILLINOIS FED. AID PROJECT				

SEE SHEET 11

CONTRACT NO. 83532

SCALE 1" = 50'

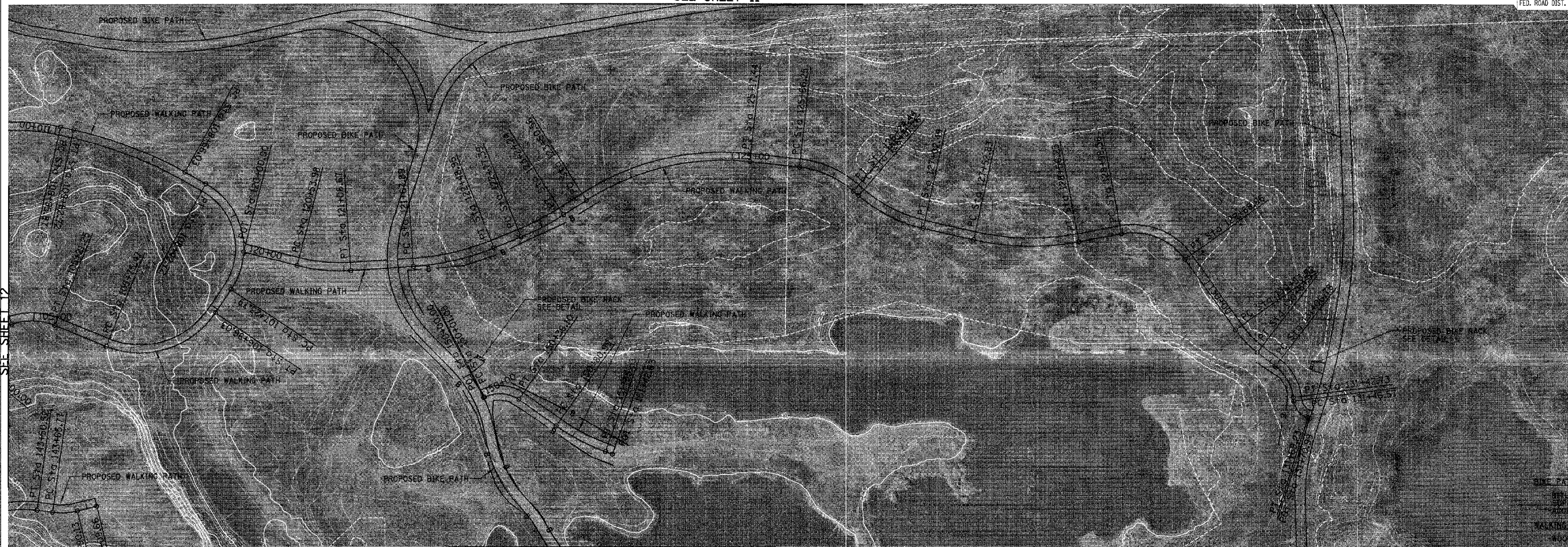

**BIKE PATH:**  
 BITUMINOUS CONCRETE SURFACE COURSE,  
 ASPHALT SURFACE COURSE, MIXTURE C, NS0-2"  
 SUBGRADE BASE COURSE TYPE B 8"

**WALKING PATH:**  
 6" ROAD CHIPS 6"

SEE SHEET 14

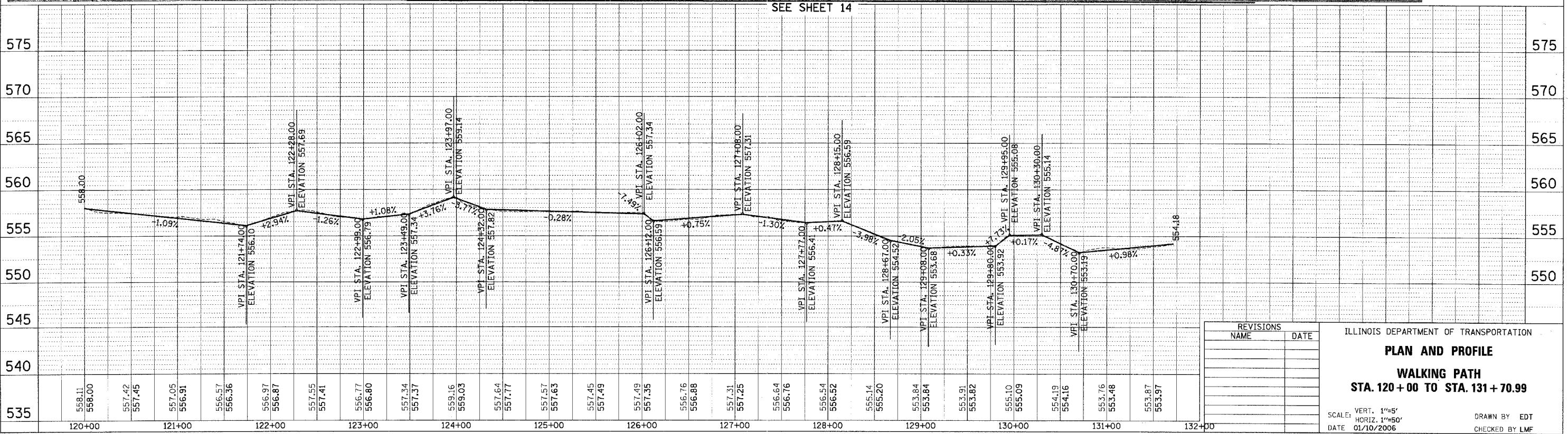

REVISIONS	
NAME	DATE

ILLINOIS DEPARTMENT OF TRANSPORTATION

**PLAN AND PROFILE**

**WALKING PATH**

**STA. 120+00 TO STA. 131+70.99**

SCALE: VERT. 1"=5'  
 HORIZ. 1"=50'  
 DATE 01/10/2006

DRAWN BY EDT  
 CHECKED BY LMF

PLAN  
 DRAWN BY  
 CHECKED BY  
 DATE

PROFILE  
 DRAWN BY  
 CHECKED BY  
 DATE

01/10/2006

N:\lockport\01-25\05\GN\0125-WPP02.pn