

F&M ROUTE	SECTION	COUNTY	TOTAL SHEETS	SHEET NO.
0306	*	WILL	118	50
FHWA REGION NO.	ILLINOIS	PROJECT M-8003(200)	CONTRACT NO. 83825	
* 01-00029-00-FP				

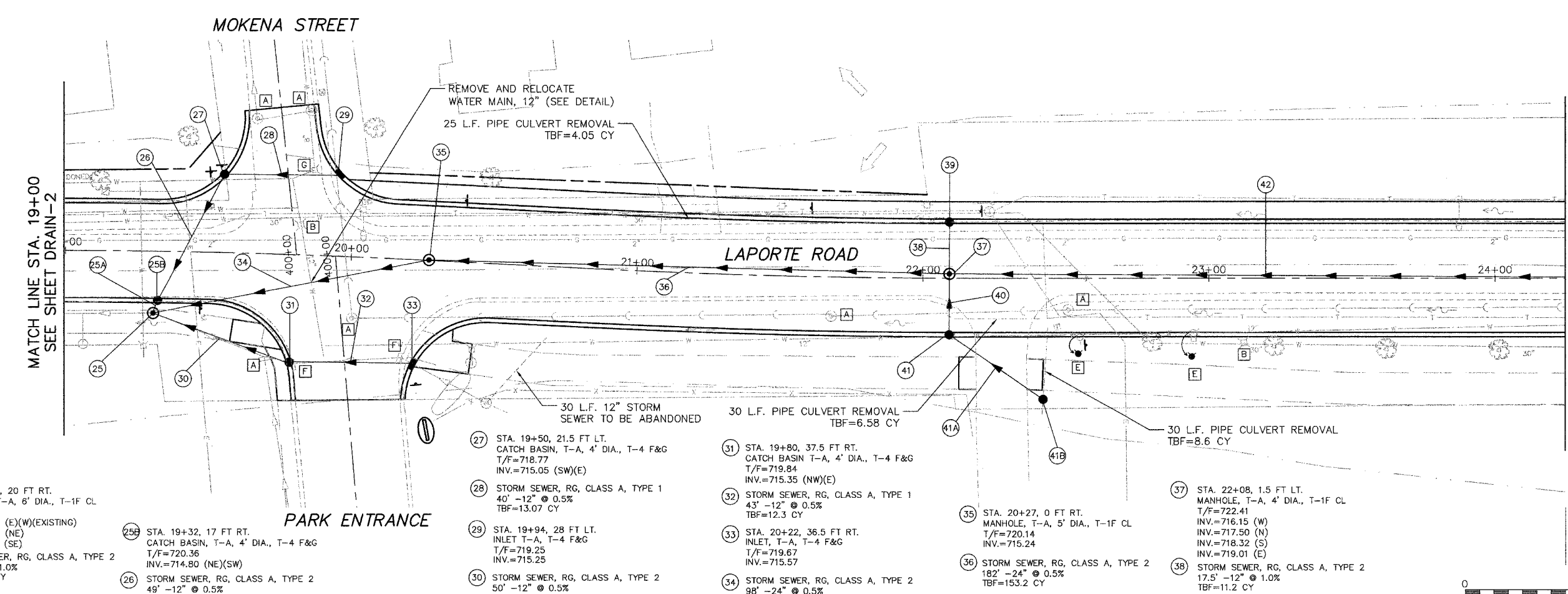

- [A] SANITARY MANHOLES TO BE ADJUSTED
 - [B] VALVE VAULTS TO BE ADJUSTED
 - [C] INLETS TO BE ADJUSTED
 - [D] CATCH BASINS TO BE ADJUSTED
 - [E] FIRE HYDRANTS TO BE RELOCATED
 - [F] REMOVING CATCH BASINS
 - [G] VALVE BOXES TO BE ADJUSTED
 - [H] REMOVING MANHOLES
- 39 STA. 22+08, 1.5 FT LT. CATCH BASIN, T-A, 4' DIA., T-4 F&G T/F=722.06 INV.=717.68
 - 40 STORM SEWER, RG, CLASS A, TYPE 2 21' -12" @ 1.0% TBF=13.1 CY
 - 41 STA. 22+08, 1.5 FT LT. CATCH BASIN, T-A, 4' DIA., T-4 F&G T/F=722.06 INV.=718.53 (N)(SE)
 - 41A STORM SEWER, RG, CLASS A, TYPE 2 40' -12" @ 1.0% TBF=11.1 CY
 - 41B STA. 22+08, 1.5 FT LT. CATCH BASIN, T-A, 4' DIA., T-8 F&G T/F=722.43 INV.=718.93
 - 42 STORM SEWER, RG, CLASS A, TYPE 2 224' -18" @ 0.5% TBF=156.7 CY

- 25 STA. 19+34, 20 FT RT. MANHOLE, T-A, 6' DIA., T-1F CL T/F=720.36 INV.=714.75 (E)(W)(EXISTING) INV.=714.75 (NE) INV.=715.10 (SE)
- 25A STORM SEWER, RG, CLASS A, TYPE 2 5' -12" @ 1.0% TBF=3.95 CY

- 25B STA. 19+32, 17 FT RT. CATCH BASIN, T-A, 4' DIA., T-4 F&G T/F=720.36 INV.=714.80 (NE)(SW)
- 26 STORM SEWER, RG, CLASS A, TYPE 2 49' -12" @ 0.5% TBF=31.29 CY

- 27 STA. 19+50, 21.5 FT LT. CATCH BASIN, T-A, 4' DIA., T-4 F&G T/F=718.77 INV.=715.05 (SW)(E)
- 28 STORM SEWER, RG, CLASS A, TYPE 1 40' -12" @ 0.5% TBF=13.07 CY
- 29 STA. 19+94, 28 FT LT. INLET T-A, T-4 F&G T/F=719.25 INV.=715.25
- 30 STORM SEWER, RG, CLASS A, TYPE 2 50' -12" @ 0.5% TBF=17.7 CY

- 31 STA. 19+80, 37.5 FT RT. CATCH BASIN T-A, 4' DIA., T-4 F&G T/F=719.84 INV.=715.35 (NW)(E)
- 32 STORM SEWER, RG, CLASS A, TYPE 1 43' -12" @ 0.5% TBF=12.3 CY
- 33 STA. 20+22, 36.5 FT RT. INLET, T-A, T-4 F&G T/F=719.67 INV.=715.57
- 34 STORM SEWER, RG, CLASS A, TYPE 2 98' -24" @ 0.5% TBF=76.0 CY

- 35 STA. 20+27, 0 FT RT. MANHOLE, T-A, 5' DIA., T-1F CL T/F=720.14 INV.=715.24
- 36 STORM SEWER, RG, CLASS A, TYPE 2 182' -24" @ 0.5% TBF=153.2 CY

- 37 STA. 22+08, 1.5 FT LT. MANHOLE, T-A, 4' DIA., T-1F CL T/F=722.41 INV.=716.15 (W) INV.=717.50 (N) INV.=718.32 (S) INV.=719.01 (E)
- 38 STORM SEWER, RG, CLASS A, TYPE 2 17.5' -12" @ 1.0% TBF=11.2 CY



DRAIN-3

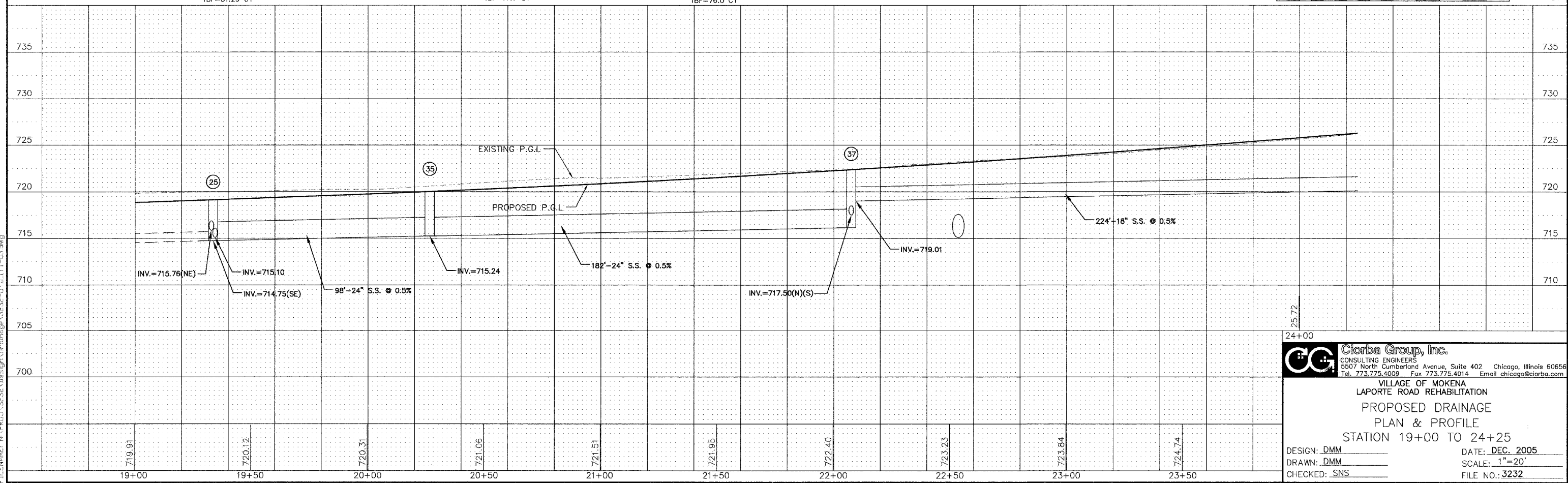

PLOT DATE: Dec 22, 2005 - 4:03pm
 FILENAME: N:\PROJ\3232\Design\Drainage\3232-UTILITY-03.dwg

25.72
 24+00

Giorba Group, Inc.
 CONSULTING ENGINEERS
 6307 North Cumberland Avenue, Suite 402 Chicago, Illinois 60656
 Tel. 773.775.4008 Fax 773.775.4014 Email chicago@giorba.com

VILLAGE OF MOKENA
 LAPORTE ROAD REHABILITATION
 PROPOSED DRAINAGE
 PLAN & PROFILE
 STATION 19+00 TO 24+25

DESIGN: DMM	DATE: DEC. 2005
DRAWN: DMM	SCALE: 1"=20'
CHECKED: SNS	FILE NO.: 3232