

FEAL ROUTE	SECTION	COUNTY	TOTAL SHEETS	SHEET NO.
0306	*	WILL	118	52
FWHA REGION NO.	ILLINOIS	PROJECT M-8003(200)	CONTRACT NO. 83825	
* 01-00029-00-FP				

- 61 STA. 31+00, 0 FT RT. MANHOLE, T-A, 4' DIA., T-1F CL  
T/F=733.96  
INV.=726.84 (W)  
INV.=729.30 (N)  
INV.=730.19 (S)
- 62 STORM SEWER, RG, CLASS A, TYPE 2  
19' -12" @ 1.0%  
TBF=7.2 CY
- 63 STA. 31+00, 19 FT LT. CATCH BASIN, T-A, 4' DIA., T-4 F&G  
T/F=733.58  
INV.=729.49
- 64 STORM SEWER, RG, CLASS A, TYPE 2  
19' -12" @ 1.0%  
TBF=7.2 CY
- 65 STA. 31+00, 19 FT RT. CATCH BASIN, T-A, 4' DIA., T-4 F&G  
T/F=733.58  
INV.=730.38
- 66 STA. 35+39, 112 FT LT. PRECAST REINFORCED CONCRETE FLARED END SECTION W/GRATE -18"  
INV.=731.60
- 67 PIPE CULVERT, CLASS A, TYPE 1  
50' -18" @ 0.2%  
TBF=4.1 CY
- 68 STA. 35+48, 19 FT LT. CATCH BASIN T-A, 4' DIA., T-4 F&G  
T/F=733.94  
INV.=731.70
- 69 STORM SEWER, RG, CLASS A, TYPE 1  
48' -18" @ 0.2%  
TBF=12.9 CY
- 70 STA. 35+14, 19 FT LT. CATCH BASIN, T-A, 4' DIA., T-4 F&G  
T/F=736.15  
INV.=731.80
- 71 STORM SEWER, RG, CLASS A, TYPE 2  
19' -18" @ 0.2%  
TBF=12.1 CY
- 72 STA. 35+14, 0 FT LT. CATCH BASIN, T-A, 4' DIA., T-4 F&G  
T/F=736.53  
INV.=731.83 (N)(E)  
INV.=732.26 (S)
- 73 STORM SEWER, RG, CLASS A, TYPE 2  
19' -12" @ 0.47%  
TBF=6.6 CY
- 74 STA. 35+14, 19 FT LT. CATCH BASIN, T-C, T-4 F&G  
T/F=736.15  
INV.=734.28
- 75 PIPE CULVERT, RG, CLASS A, TYPE 1  
54' -12" @ 0.5%  
TBF=11.2 CY
- 76 STA. 35+87, 42 FT LT. PRECAST REINFORCED CONCRETE FLARED END SECTION W/GRATE -12"  
INV.=731.97
- 77 STORM SEWER, RG, CLASS A, TYPE 1  
87' -18" @ 0.2%  
TBF=31.8 CY
- 78 STA. 36+02, 0 FT RT. MANHOLE T-A, 5' DIA., T-1F CL  
T/F=735.43  
INV.=732.01
- 79 STORM SEWER, RG, CLASS A, TYPE 1  
19' -12" @ 0.5%  
TBF=4.9 CY
- 80 STA. 36+02, 19 FT RT. CATCH BASIN, T-C, T-4 F&G  
T/F=735.05  
INV.=732.10
- 81 STORM SEWER, RG, CLASS A, TYPE 1  
20' -12" @ 0.5%  
TBF=5.2 CY
- 82 STA. 35+95, 19 FT RT. CATCH BASIN, T-C, T-4 F&G  
T/F=735.13  
INV.=732.11
- 83 STORM SEWERS, TYPE 1, RCEP S23 R14, RUBBER GASKET  
57' @ 0.2%  
TBF=14.1 CY

- A SANITARY MANHOLES TO BE ADJUSTED
- B VALVE VAULTS TO BE ADJUSTED
- C INLETS TO BE ADJUSTED
- D CATCH BASINS TO BE ADJUSTED
- E FIRE HYDRANTS TO BE RELOCATED
- F REMOVING CATCH BASINS
- G VALVE BOXES TO BE ADJUSTED
- H REMOVING MANHOLES

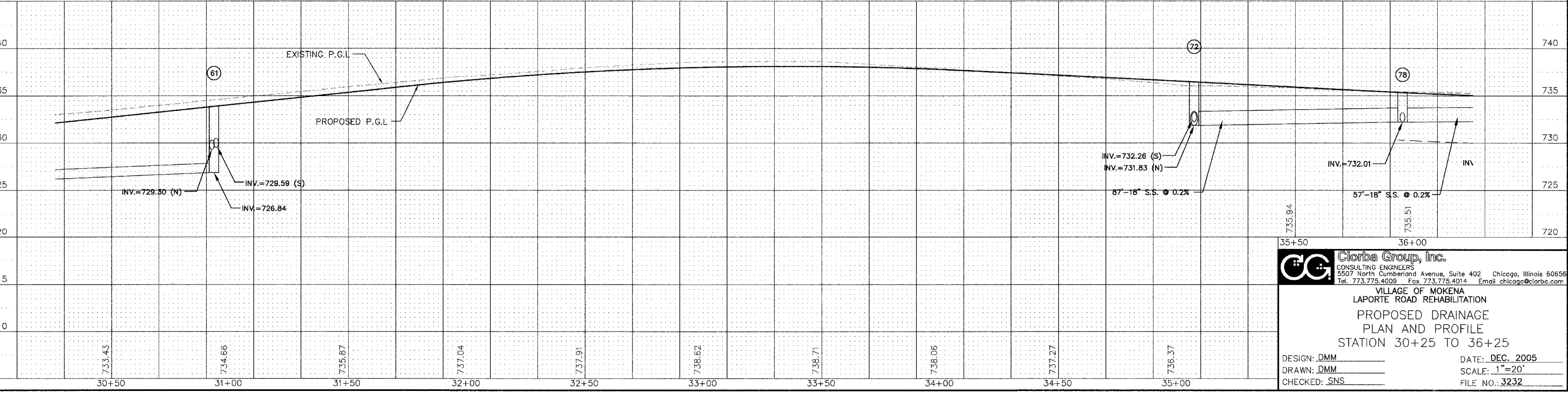
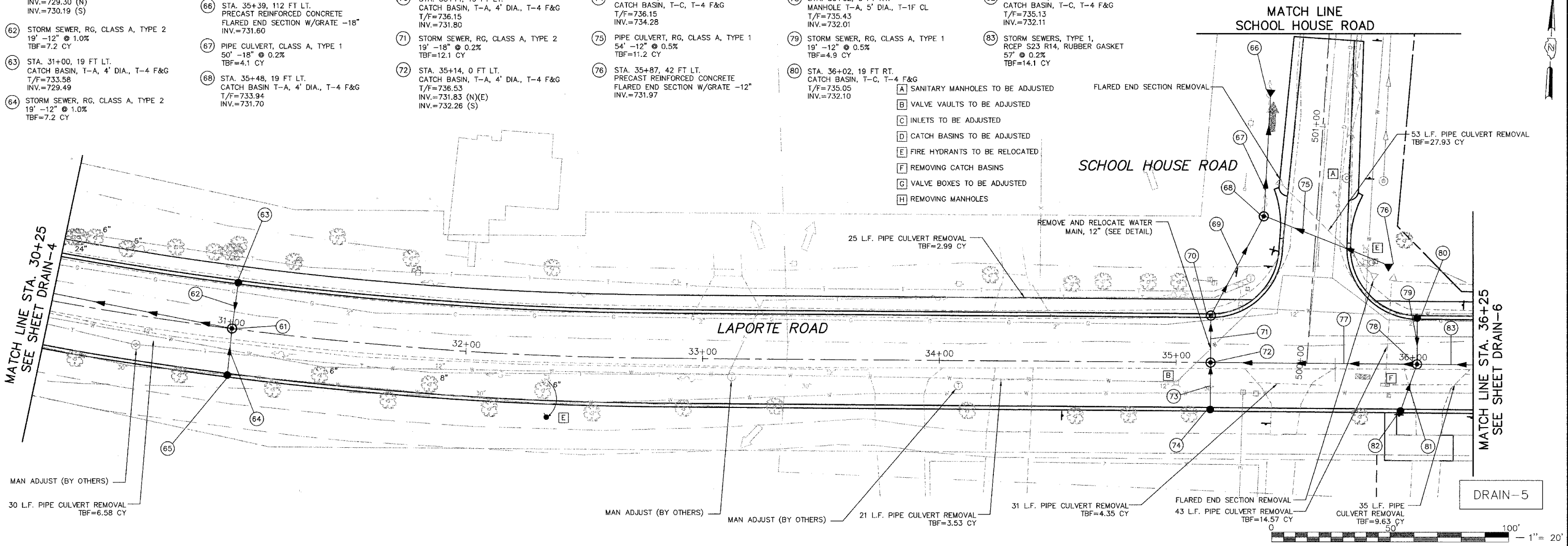

**Clorba Group, Inc.**  
CONSULTING ENGINEERS  
5507 North Cumberland Avenue, Suite 402 Chicago, Illinois 60656  
Tel. 773.775.4009 Fax 773.775.4014 Email chicago@clorba.com

VILLAGE OF MOKENA  
LAPORTE ROAD REHABILITATION  
PROPOSED DRAINAGE  
PLAN AND PROFILE  
STATION 30+25 TO 36+25

DESIGN: DMM  
DRAWN: DMM  
CHECKED: SNS

DATE: DEC. 2005  
SCALE: 1"=20'  
FILE NO.: 3232

FILE: D:\131 Dec 22, 2005 4:10 PM  
FILENAME: N:\PROJECTS\3232\Design\Drainage\3232-DTL11V-05.dwg