

- A SANITARY MANHOLES TO BE ADJUSTED
- B VALVE VAULTS TO BE ADJUSTED
- C INLETS TO BE ADJUSTED
- D CATCH BASINS TO BE ADJUSTED
- E FIRE HYDRANTS TO BE RELOCATED
- F REMOVING CATCH BASINS
- G VALVE BOXES TO BE ADJUSTED
- H REMOVING MANHOLES

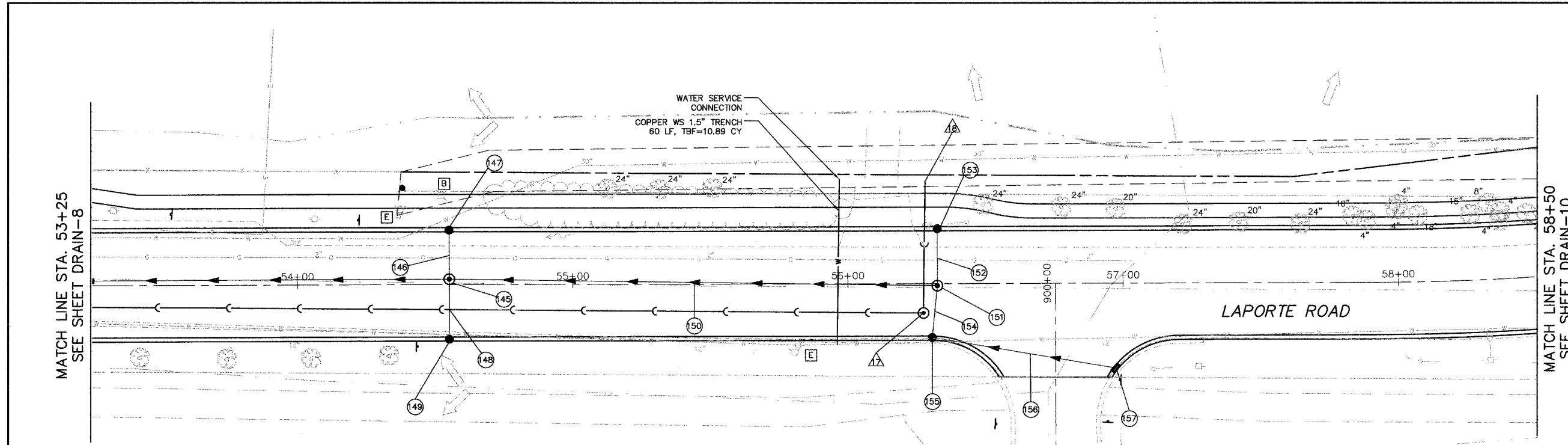

- 145 STA 54+55, 2 FT LT. MANHOLE, T-A, 4'DIA, T-1F CL T/F=733.30 INV.=729.14(E)(W) INV.=730.26(S)
- 146 STORM SEWER, RG, CLASS A TYPE 1 17'-12" @ 0.53% TBF=5.9 CY
- 147 STA 54+55, 19 FT LT. CATCH BASIN, T-A, T-4 F&G T/F=732.96 INV.=729.59
- 148 STORM SEWER, RG, CLASS A TYPE 1 21'-12" @ 0.43% TBF=7.1 CY
- 149 STA 54+55, 19 FT RT. CATCH BASIN, T-C, T-4 F&G T/F=732.96 INV.=730.36
- 150 STORM SEWER, RG, CLASS A TYPE 2 17'-18" @ 0.3% TBF=114.0 CY
- 151 STA 56+32, 0 FT LT. MANHOLE, T-A, 4'DIA, T-1F CL T/F=734.67 INV.=729.67(E)(W) INV.=730.87(N) INV.=731.60(S)
- 152 STORM SEWER, RG, CLASS A TYPE 1 19'-12" @ 0.53% TBF=5.6 CY
- 153 STA 56+32, 19 FT LT. CATCH BASIN, T-A, T-4 F&G T/F=734.29 INV.=731.69
- 154 STORM SEWER, RG, CLASS A TYPE 1 19'-12" @ 0.53% TBF=5.6 CY
- 155 STA 56+32, 19 FT RT. CATCH BASIN, T-C, T-4 F&G T/F=734.29 INV.=731.69
- 156 STORM SEWER, RG, CLASS A TYPE 1 70'-12" @ 0.5% TBF=16.9 CY
- 157 STA 56+96, 32 FT RT. INLET, T-A, T-4 F&G T/F=734.10 INV.=731.32
- 158 STA 56+29, 10.5 FT RT. SANITARY MANHOLE, TYPE A, 5' DIAMETER, T-1F CL W/INTERIOR DROP T/F=734.51 INV.=724.88 INV.=727.71 (S) (6" SERVICE) DROP INV.=725.18 (S)
- 159 SANITARY SEWER SERVICE 6" 46' @ 1.0%, TBF=42.11 CY

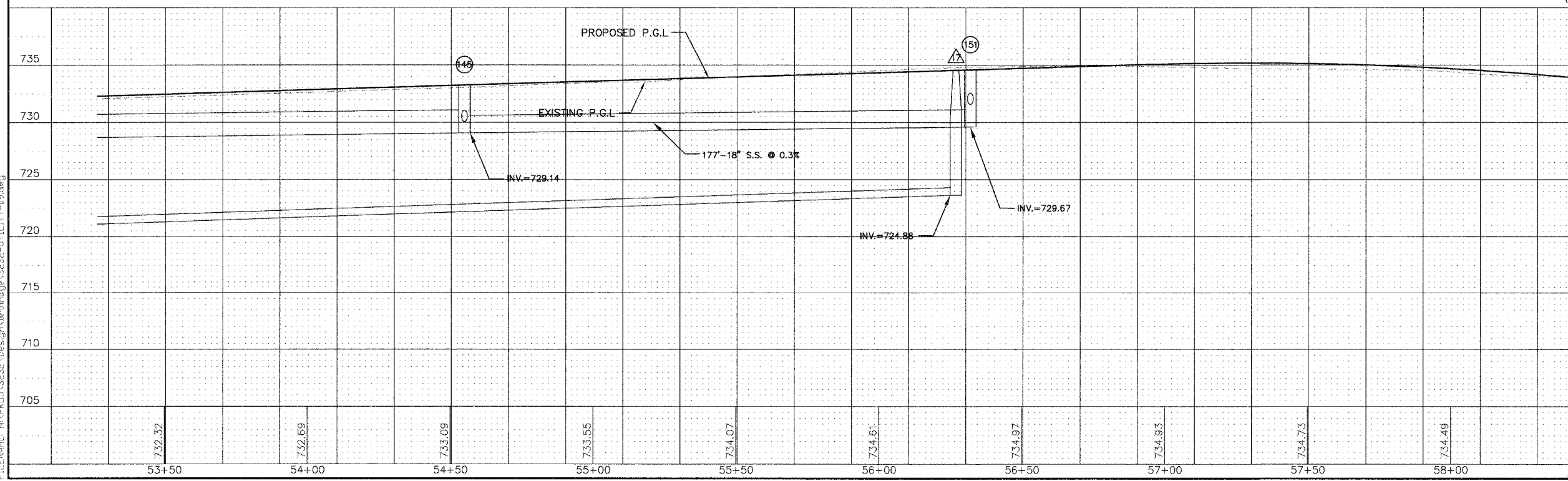

733.86

58+50

Ciorba Group, Inc.
CONSULTING ENGINEERS
5507 North Cumberland Avenue, Suite 402 Chicago, Illinois 60656
Tel. 773.775.4009 Fax 773.775.4014 Email chicagoc@ciorga.com

VILLAGE OF MOKENA
LAPORTE ROAD REHABILITATION
PROPOSED DRAINAGE
PLAN AND PROFILE
STATION 53+25 TO 58+50

DESIGN: DMM
DRAWN: DMM
CHECKED: SNS

DATE: DEC. 2005
SCALE: 1"=20'
FILE NO.: 3232

PLOT DATE: Dec 27, 2005 4:15pm
 FILENAME: N:\PRJ\A3232\Design\Drainage\3232-UTILITY-05.dwg