

MATCH LINE STA. 64+00
SEE SHEET DRAIN-10

END PROJECT
STATION 68+50

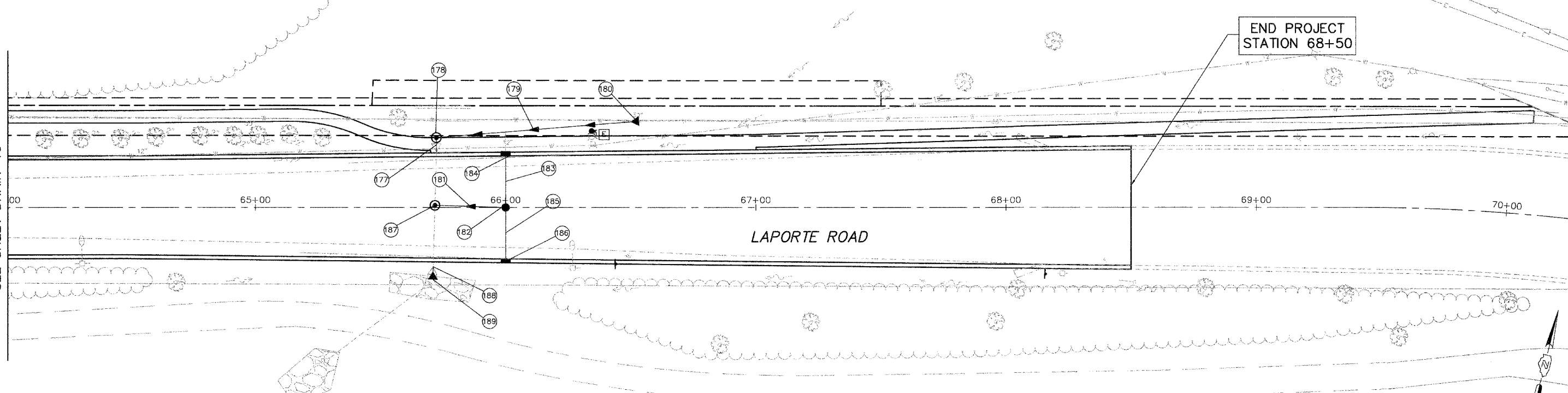

- (177) STORM SEWER, RG, CLASS A TYPE 1
6'-24" @ 0.5%
TBF=2.3 CY
- (178) STA 65+72, 28 FT LT.
MANHOLE, T-A, 4' DIA, T-1F CL
T/F=719.40
INV.=715.18
- (179) PIPE CULVERT, RG, CLASS A TYPE 1
79'-12" @ 2.3%
TBF=21.3 CY
- (180) STA 66+50, 34 FT LT.
PRECAST REINFORCED CONCRETE
FLARED END SECTION W/GRATE -12"
INV.=717.00
- (181) STORM SEWER, RG, CLASS A TYPE 2
28'-12" @ 0.5%
TBF=9.5 CY
- (182) STA 66+00, 0 FT LT.
CATCH BASIN, T-A, T-1F CL
T/F=719.25
INV.=715.29
- (183) STORM SEWER, RG, CLASS A TYPE 1
20'-12" @ 0.5%
TBF=6.2 CY
- (184) STA 66+00, 20.5 FT LT.
INLET, T-A, T-4 F&G
T/F=718.84
INV.=715.39
- (185) STORM SEWER, RG, CLASS A TYPE 1
20'-12" @ 0.5%
TBF=6.2 CY
- (186) STA 66+00, 20.5 FT RT.
INLET, T-A, T-4 F&G
T/F=718.84
INV.=715.39
- (187) STA 65+71, 0 FT RT.
MANHOLE, T-A, 4' DIA, T-1F CL
T/F=719.34
INV.=714.65 (NW)(SE)
INV.=715.15 (NE)
- (188) PIPE CULVERT, CLASS A TYPE 1
5'-24" @ 2.0%
TBF=0.3 CY
- (189) STA 65+71, 25.5 FT RT.
PRECAST REINFORCED CONCRETE
FLARED END SECTION W/GRATE -24"
INV.=714.09

- [A] SANITARY MANHOLES TO BE ADJUSTED
- [B] VALVE VAULTS TO BE ADJUSTED
- [C] INLETS TO BE ADJUSTED
- [D] CATCH BASINS TO BE ADJUSTED
- [E] FIRE HYDRANTS TO BE RELOCATED
- [F] REMOVING CATCH BASINS
- [G] VALVE BOXES TO BE ADJUSTED
- [H] REMOVING MANHOLES

DRAIN-11

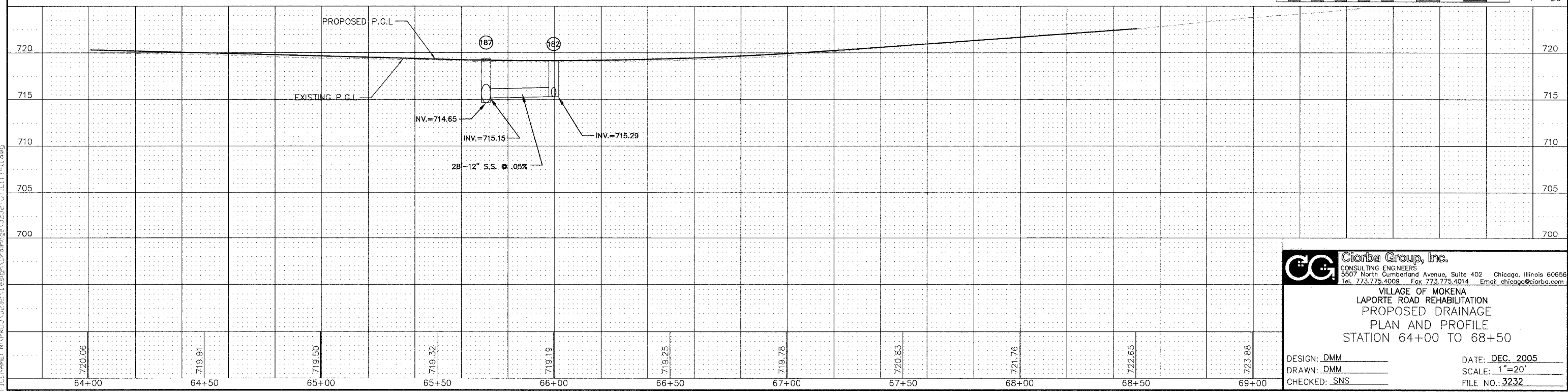

PLU: DATE: Dec 22, 2005 - 4:17 PM
FILENAME: N:\PREL\3232\Design\Drawings\3232-UTILITY-11.dwg

CG Ciorba Group, Inc.
CONSULTING ENGINEERS
5507 North Cumberland Avenue, Suite 402 Chicago, Illinois 60656
Tel. 773.775.4009 Fax 773.775.4014 Email chicagocg@ciorba.com

VILLAGE OF MOKENA
LAPORTE ROAD REHABILITATION
PROPOSED DRAINAGE
PLAN AND PROFILE
STATION 64+00 TO 68+50

DESIGN: DMM
DRAWN: DMM
CHECKED: SNS
DATE: DEC. 2005
SCALE: 1"=20'
FILE NO.: 3232