

PLAN ROUTE	SECTION	COUNTY	TOTAL SHEETS	SHEET NO.
0306	*	WILL	118	78
FHWA REGION NO.	ILLINOIS	PROJECT M-800.3(200)		
* 01-00029-00-FP			CONTRACT NO. 83825	

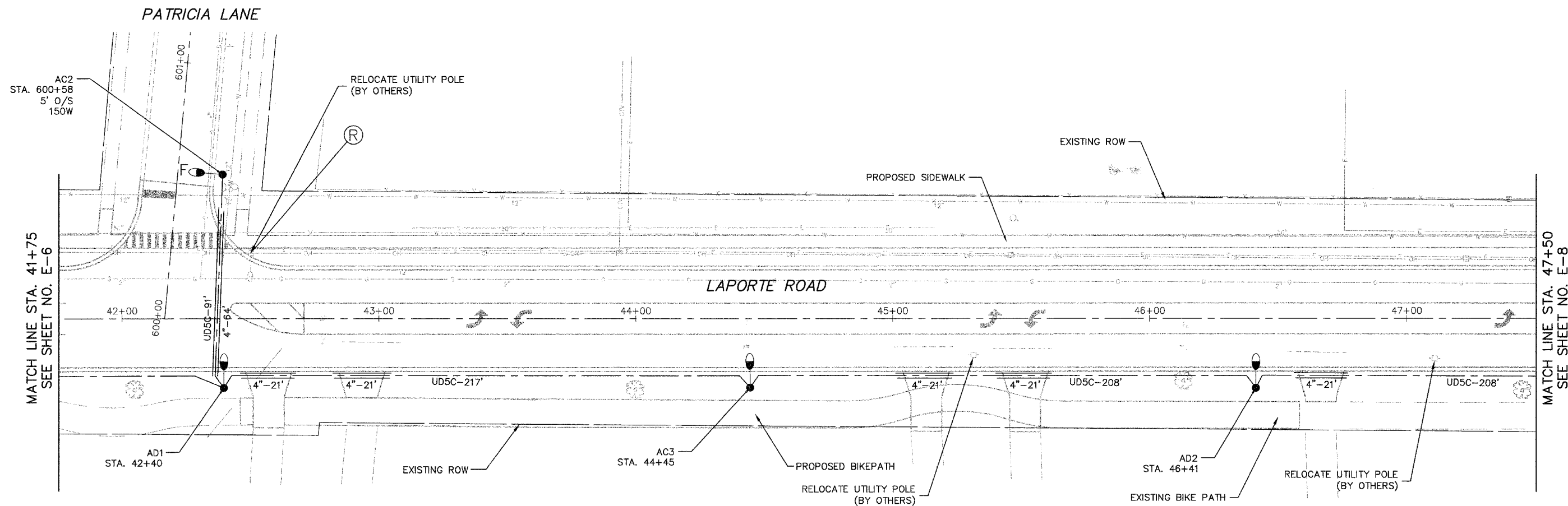

LEGEND

- LIGHT POLE, 35' M.H., 10' MAST ARM, AND LUMINAIRE, 200W, UNLESS OTHERWISE NOTED
- UTILITY POLE MOUNTED MAST ARM, LUMINAIRE TO BE REMOVED BY OTHERS
- EXISTING LIGHT POLE, SIZE AS NOTED
- UNIT DUCT WITH 4-1/C NO. 4 AND 1/C NO. 6 GROUND 600V (EPR-TYPE RHW) 1-1/2" POLYTHYLENE AND LENGTH AS NOTED
- GALVANIZED STEEL CONDUIT, PUSHED, DIAMETER AND LENGTH AS NOTED
- PROPOSED LIGHTING CONTROLLER, 120/240V, 100A
- PROPOSED SERVICE CONNECTION
- OFFSET FOUNDATION

NOTES

1. ALL POLES SHALL BE OFFSET 8' FROM EDGE OF PAVEMENT TO CENTER OF POLE, UNLESS OTHERWISE NOTED.
2. EXISTING UTILITY POLE MOUNTED LUMINAIRES SHALL REMAIN IN USE DURING CONSTRUCTION.

E-7

Clorba Group, Inc.
 CONSULTING ENGINEERS
 8507 North Cumberland Avenue, Suite 402 Chicago, Illinois 60656
 Tel. 773.775.4009 Fax 773.775.4014 Email chicago@clorba.com

VILLAGE OF MOKENA
 LAPORTE ROAD REHABILITATION
 LAPORTE ROAD IMPROVEMENTS
 LIGHTING PLAN
 STATION 41+75 TO 47+25

DESIGN: KDM
 DRAWN: KDM
 CHECKED: JMV

DATE: DEC. 2005
 SCALE: 1"=20'
 FILE NO.: 3232

PLU1 DATE: Dec 22, 2005 11:51am
 FILENAME: N:\PROJECTS\2005\Lighting\3232-LIGHT-07.dwg