

ALGONQUIN RD SIDEWALK IMPROVEMENTS		
HORIZ. SCALE: 1"=40'	FILE NAME	SHEET NO.
	SIGNALS.DWG	10 OF 20
<b>TRAFFIC SIGNAL PLAN</b>		
STA.		TO STA.
ROUTE NUMBER	SECTION NUMBER	COUNTY
339	02-00073-00-SW	COOK
CONTRACT NO. 83836		

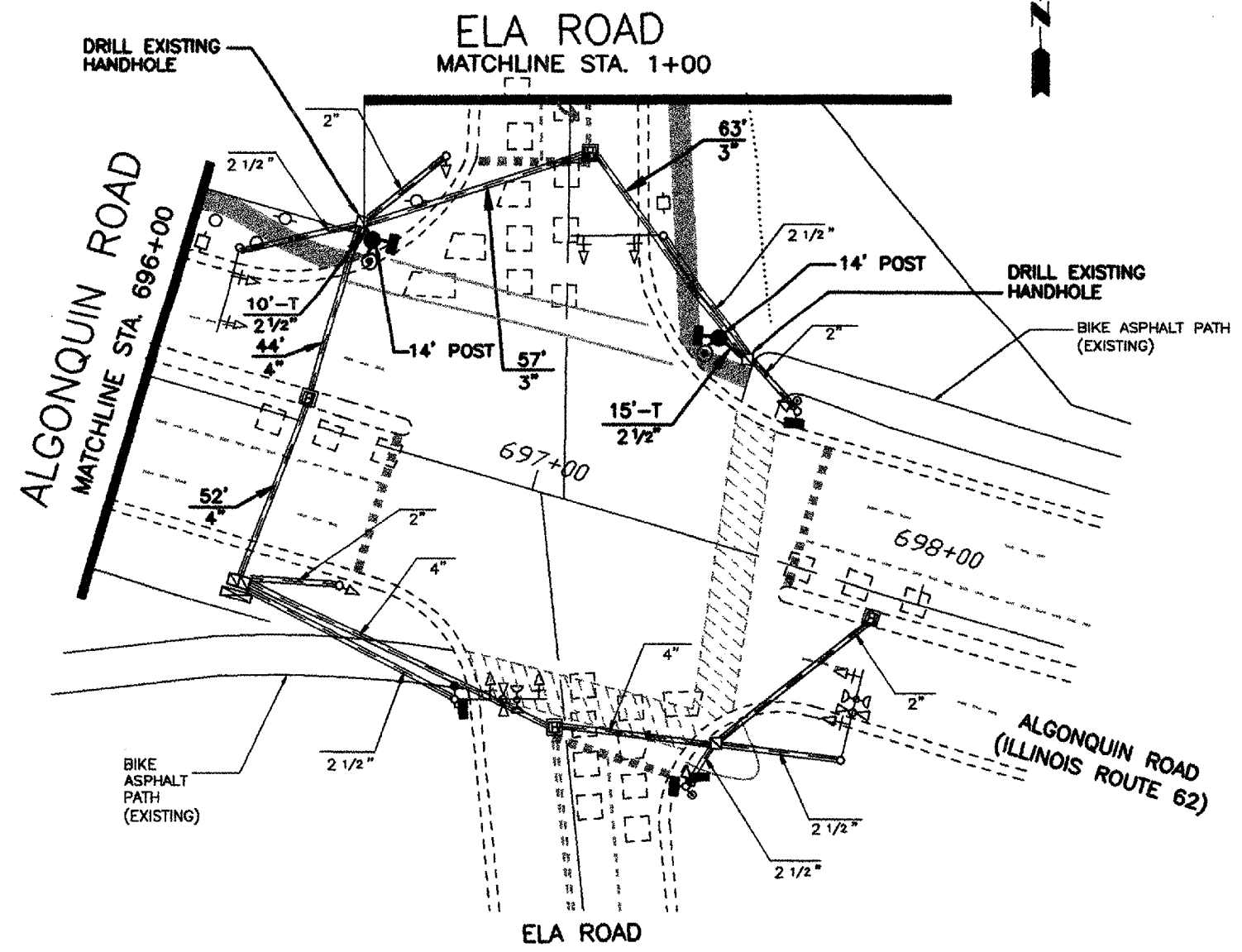

**TRAFFIC SIGNAL LEGEND**

EXISTING	PROPOSED
	CONTROLLER
	SIGNAL HEAD
	SIGNAL HEAD WITH BACKPLATE
	SIGNAL HEAD, PEDESTRIAN
	SIGNAL POST
	MAST ARM ASSEMBLY AND POLE, ALUMINUM
	CT COMMON TRENCH
	UD UNIT DUCT
	G.S. CONDUIT IN TRENCH OR PUSHED
	HANDHOLE
	HEAVY DUTY HANDHOLE
	DOUBLE HANDHOLE
	PEDESTRIAN PUSHBUTTON DETECTOR
	DETECTOR LOOP
	EMERGENCY VEHICLE SYSTEM DETECTOR
	CONFIRMATION BEACON

**NOTE:**  
 IN ADDITION TO INSTALLING TWO NEW PEDESTRIAN LED SIGNAL HEADS, THE FOUR EXISTING PEDESTRIAN SIGNAL HEADS WILL BE REPLACED WITH THE NEW INTERNATIONAL TYPE SIGNAL HEAD LED. CABLING FOR THE TWO PROPOSED PEDESTRIAN SIGNAL HEADS AND PUSH BUTTONS WILL UTILIZE THE EXISTING CONDUIT RUNS TO CONNECT TO THE CONTROLLER BOX.