

F.A. RTE.	SECTION	COUNTY	TOTAL SHEETS	SHEET NO.
2786	05-00078-00-RS	COOK	17	6
STA 22+80		TO STA 36+00		
FED. ROAD DIST. NO.	ILLINOIS	FED. AID PROJECT		
CONTRACT NUMBER: 83839				

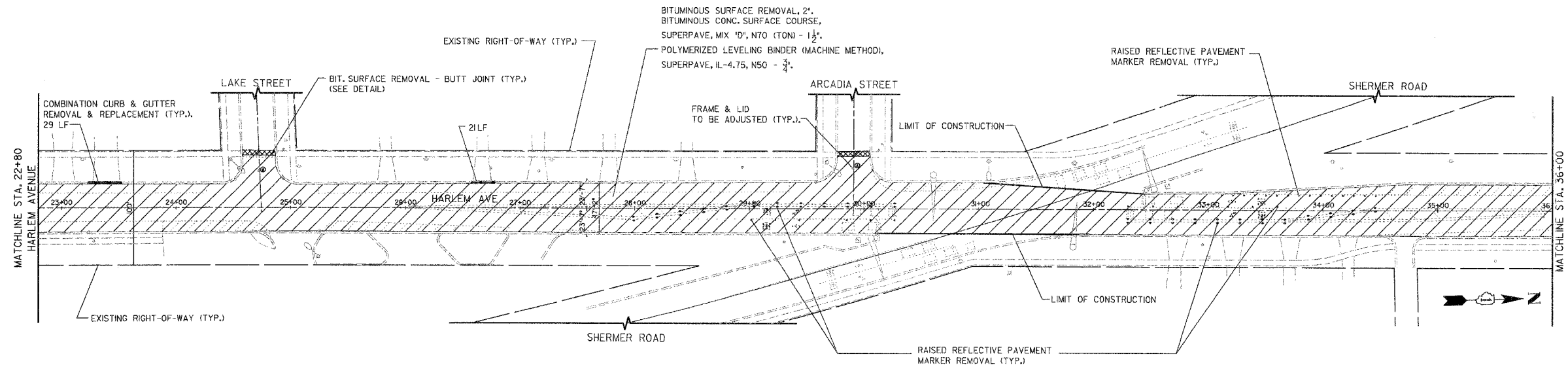

- NOTE:
1. FOR ALL SIDE STREETS, THE RESURFACING LIMITS WILL BE MARKED BY THE ENGINEER IN THE FIELD.
  2. CURB REMOVAL WILL BE MARKED BY THE ENGINEER IN THE FIELD, NOT TO EXCEED THE QUANTITY STATED IN THE SUMMARY OF QUANTITIES.
  3. STREET DIMENSIONS ARE TO EDGE-OF-PAVEMENT UNLESS OTHERWISE NOTED.

EXISTING CONDITIONS AND  
PROPOSED REMOVAL & REPLACEMENT

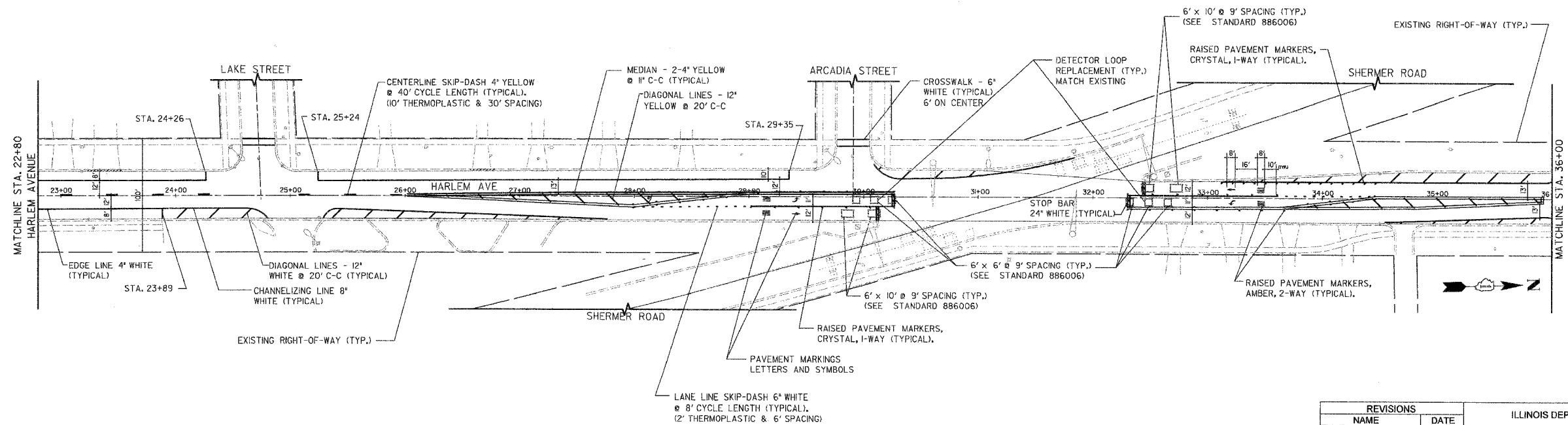

PROPOSED PAVEMENT MARKINGS

REVISIONS	
NAME	DATE

ILLINOIS DEPARTMENT OF TRANSPORTATION  
 VILLAGE OF MORTON GROVE  
 HARLEM AVENUE  
 ROADWAY PLANS  
 STA. 22+80 TO STA. 36+00  
 SCALE: VERT. 1"=8'  
 HORIZ. 1"=50'  
 DATE: 1/13/08  
 DRAWN BY: JFG  
 CHECKED BY: RCG