

F.A.U. RTE.	SECTION	COUNTY	TOTAL SHEETS	SHEET NO.
3873 00-00243-00-FP		MCHENRY	84	19
STA. 303+00	TO STA. 314+00	ILLINOIS HIGHWAY PROJECT		
FED. ROAD DIST. NO. 1		83840		

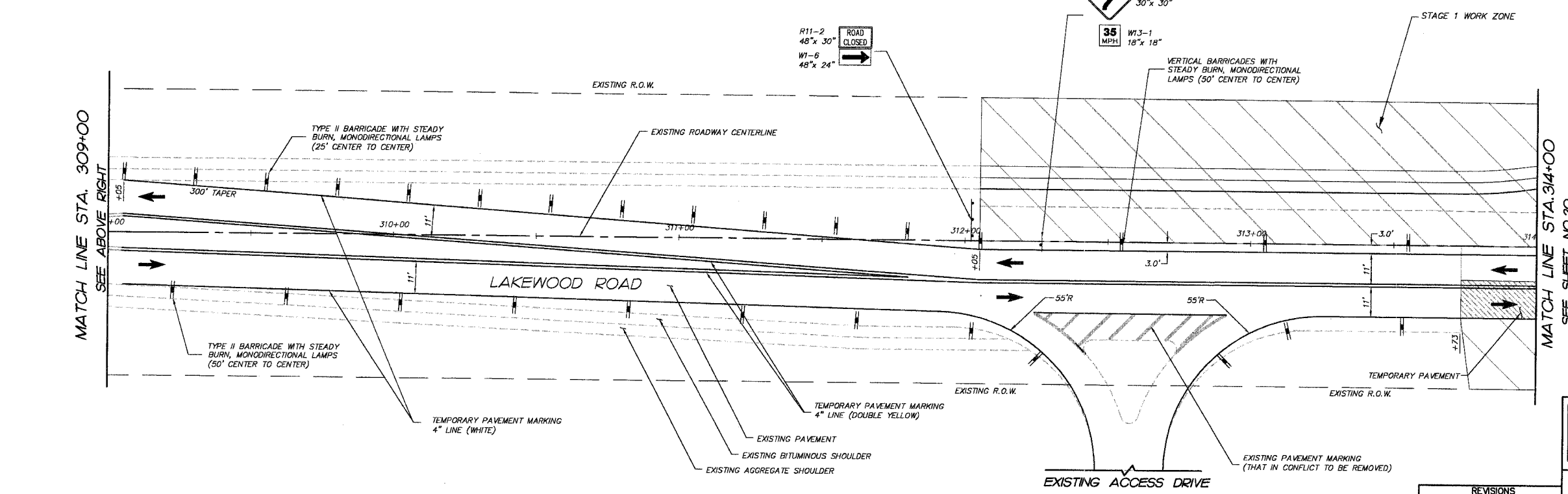
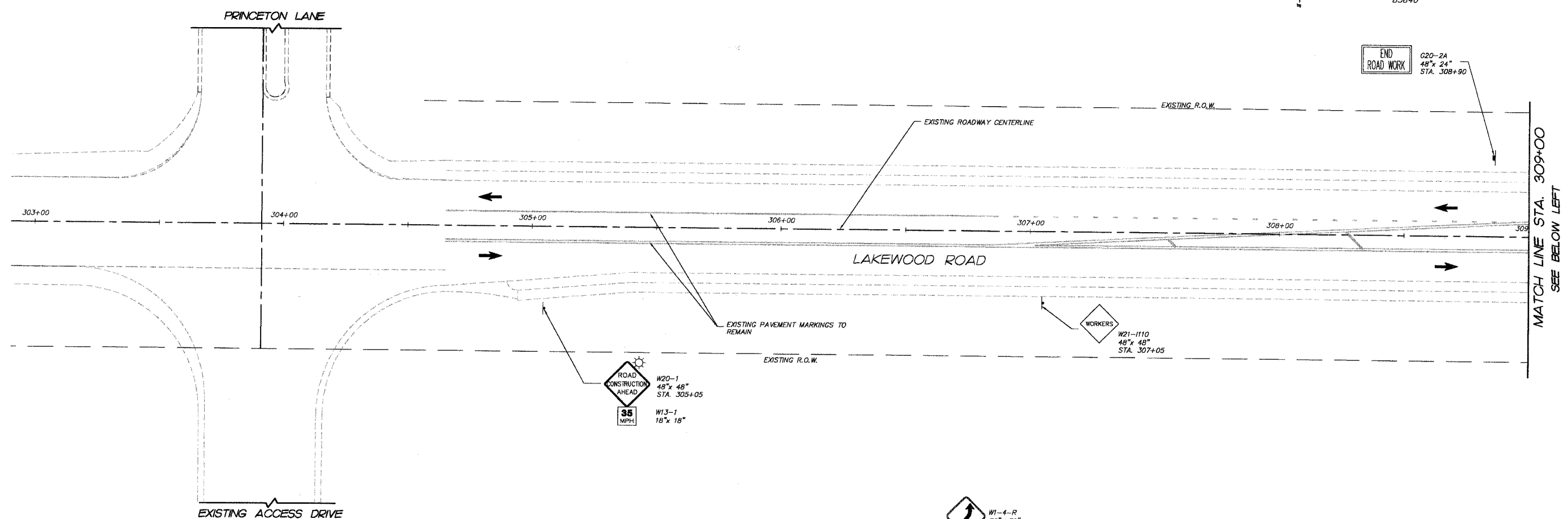

	DIRECTION OF TRAFFIC FLOW
	TYPE III BARRICADE WITH 2 FLASHING LIGHTS
	TEMPORARY PAVEMENT
	TEMPORARY ACCESS
	STAGE 1 WORK ZONE
	TEMPORARY SIGNAGE (SEE PLAN FOR TYPE, SIZE AND LOCATION)
	TYPE II BARRICADE WITH STEADY BURN, MONODIRECTIONAL LAMPS
	VERTICAL PANEL WITH STEADY BURN, MONODIRECTIONAL LAMPS
	DIRECTIONAL INDICATOR BARRICADE WITH STEADY BURN, MONODIRECTIONAL LAMPS (25' CENTER TO CENTER)
	STEADY BURNING AMBER BEACON

NO.	NAME	DATE
7.		
6.		
5.		
4.		
3.		
2.		
1.		

**SMITH ENGINEERING CONSULTANTS, INC.**  
 CIVIL/STRUCTURAL ENGINEERS AND SURVEYORS  
 4500 PRIME PARKWAY, SUITE 201  
 MCHENRY, ILLINOIS 60050  
 PH: 815-955-1775 FAX: 815-955-1781  
 www.smithengineering.com E-MAIL: see@smitheng.com  
 • MCHENRY • YORKVILLE  
 ILLINOIS PROFESSIONAL DESIGN FIRM # 184-000108

MCHENRY COUNTY DIVISION OF TRANSPORTATION  
 ACKMAN ROAD EXTENSION  
 SUGGESTED CONSTRUCTION STAGGING  
 FOR LAKEWOOD ROAD  
 STAGE I  
 SCALE: 1"=20'  
 DATE 10-05-2005  
 DRAWN BY DCJ  
 CHECKED BY CP

PLOT FILE STANDARD  
 VIEW STAGE 1A CE-19  
 COMP. FILE: 030210-61R1-1.dwg