

F.A.U. RTE.	SECTION	COUNTY	TOTAL SHEETS	SHEET NO.
3873 00-00243-00-FP		MCHENRY	84	21
STA. 303+00	TO STA. 314+00			
FED. ROAD DIST. NO. 1		ILLINOIS	HIGHWAY PROJECT	
83840				

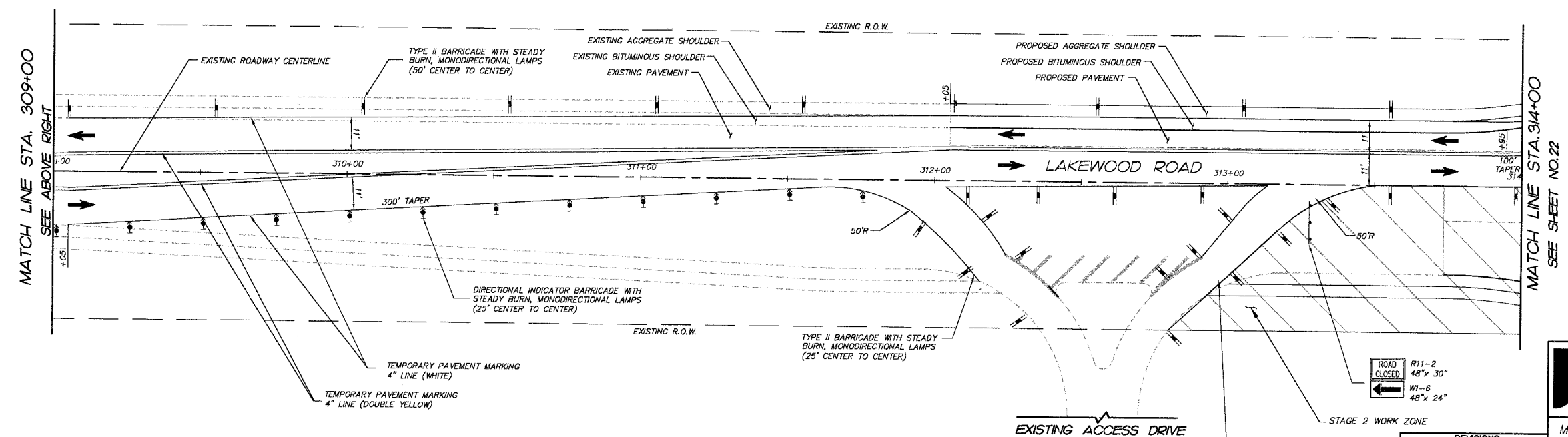
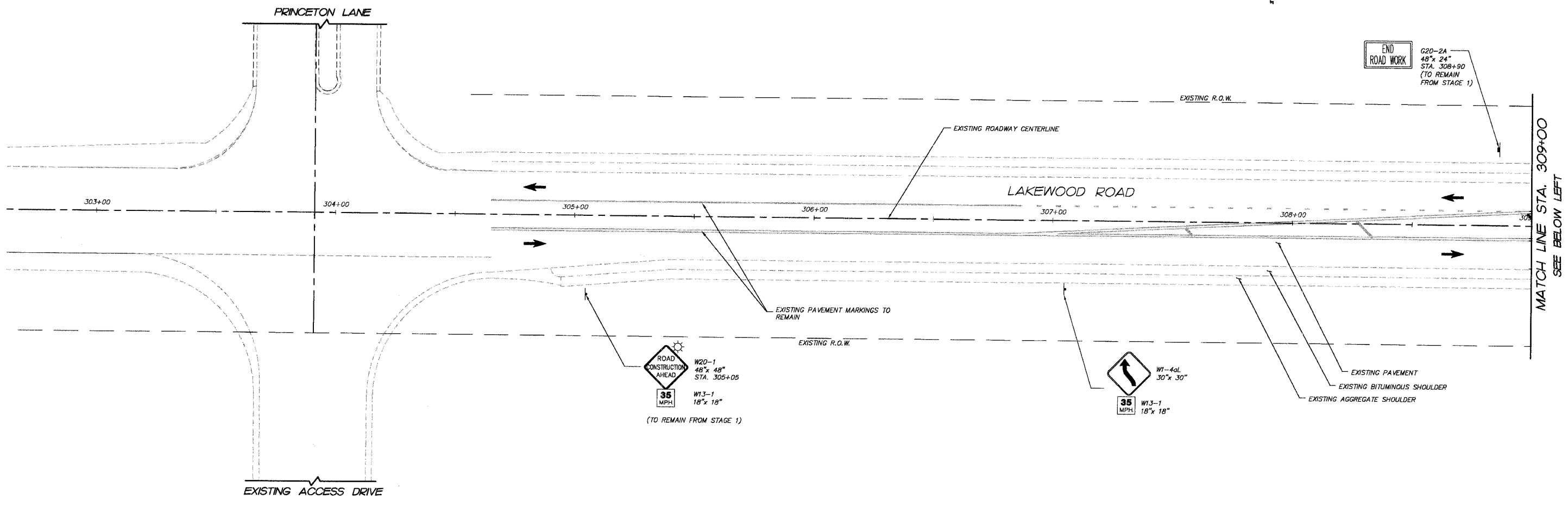

SYMBOL LEGEND	
	DIRECTION OF TRAFFIC FLOW
	TYPE III BARRICADE WITH 2 FLASHING LIGHTS
	TEMPORARY PAVEMENT
	TEMPORARY ACCESS
	STAGE 2 WORK ZONE
	TEMPORARY SIGNAGE (SEE PLAN FOR TYPE, SIZE AND LOCATION)
	TYPE II BARRICADE WITH STEADY BURN, MONODIRECTIONAL LAMPS
	VERTICAL PANEL WITH STEADY BURN, MONODIRECTIONAL LAMPS
	DIRECTIONAL INDICATOR BARRICADE WITH STEADY BURN, MONODIRECTIONAL LAMPS (25' CENTER TO CENTER)
	STEADY BURNING AMBER BEACON

REVISIONS		
NO.	NAME	DATE
7.		
6.		
5.		
4.		
3.		
2.		
1.		

SMITH ENGINEERING CONSULTANTS, INC.
 CIVIL/STRUCTURAL ENGINEERS AND SURVEYORS
 4500 PRIME PARKWAY, SUITE 201
 MCHENRY, ILLINOIS 60050
 PH: 815-385-1776 FAX: 815-385-1781
 www.smithengineering.com E-MAIL: sae@smithengineering.com
 MCHENRY HUNTLEY YORKVILLE
 ILLINOIS PROFESSIONAL DESIGN FIRM # 184-000108

McHENRY COUNTY DIVISION OF TRANSPORTATION
 ACKMAN ROAD EXTENSION

SUGGESTED CONSTRUCTION STAGING
 FOR LAKEWOOD ROAD
 STAGE 2

SCALE: 1"=20'
 DATE 10-05-2005

DRAWN BY DCJ
 CHECKED BY CP

PLOT FILE: STANDARD
 VIEW: STAGE 1A 05-21
 COMP. FILE: 03070-01A-1.dwg