

F.A.U. RTE.	SECTION	COUNTY	TOTAL SHEETS	SHEET NO.
3873	00.00243.00.FP	MCHENRY	84	46
STA.	TO STA.			
FED. ROAD DIST. NO. 1	ILLINOIS	HIGHWAY PROJECT		
83840				

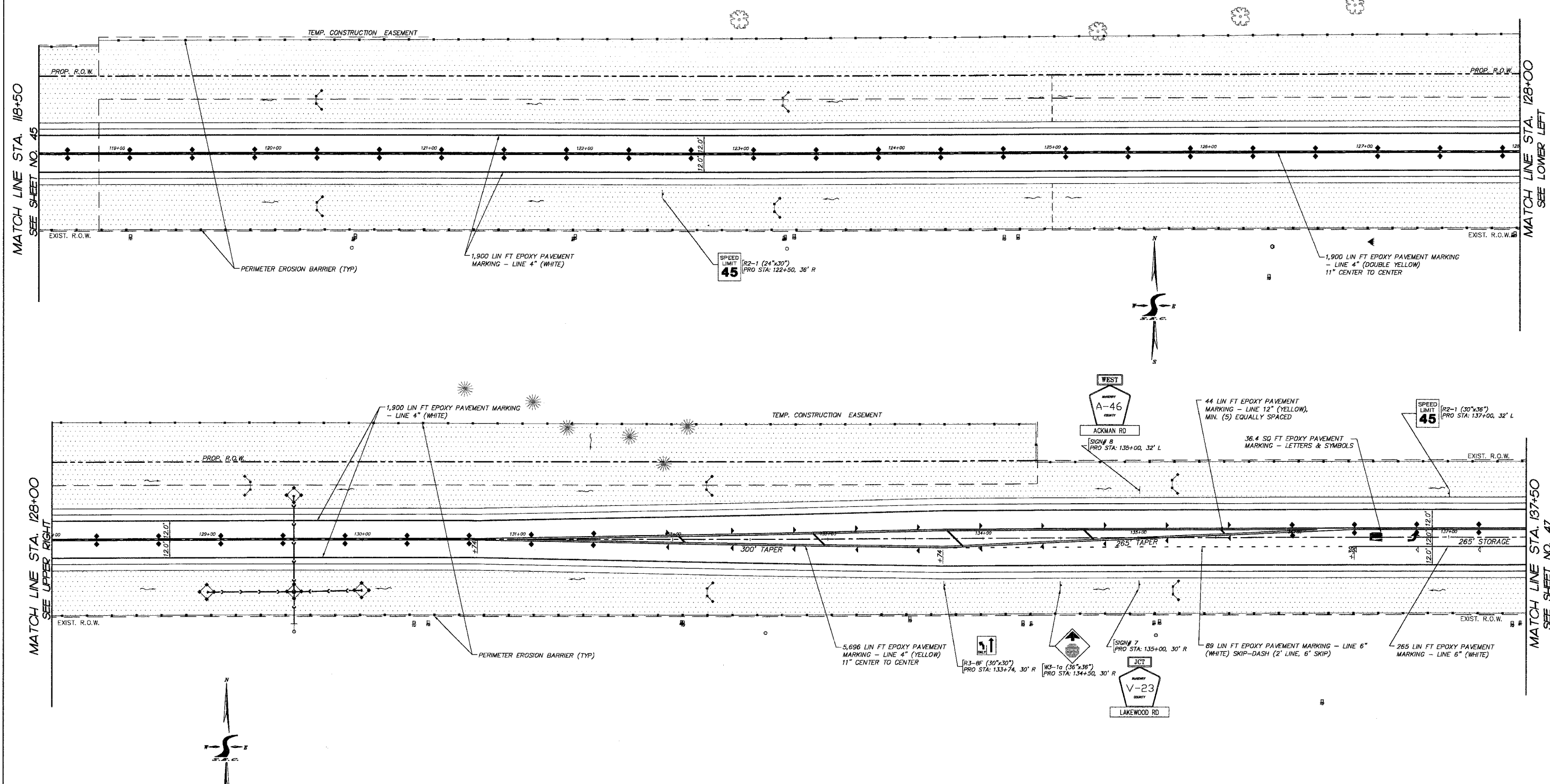

LEGEND

	FURNISH AND PLACE TOPSOIL 6" WITH SEEDING (SPECIAL) AND EROSION CONTROL BLANKET
	DENOTES PERIMETER EROSION BARRIER
	DENOTES TEMPORARY DITCH CHECK AND INLET AND PIPE PROTECTION

REVISIONS

NO.	NAME	DATE
7.		
6.		
5.		
4.		
3.		
2.		
1.		

SMITH ENGINEERING CONSULTANTS, INC.
 CIVIL/STRUCTURAL ENGINEERS AND SURVEYORS
 4000 PRIMES PARKWAY, SUITE 200
 MCHENRY, ILLINOIS 60050
 TEL: 815-385-1778 FAX: 815-385-1781
 www.smithengineering.com E-MAIL: seo@smithengineering.com
 MCHENRY HUNTLEY YORKVILLE
 ILLINOIS PROFESSIONAL DESIGN FIRM # 184-000108

McHENRY COUNTY DIVISION OF TRANSPORTATION
 ACKMAN ROAD EXTENSION
 PAVEMENT MARKING, SIGNING, EROSION
 CONTROL AND RESTORATION PLAN
 STA. 118+50 TO STA. 137+50

SCALE: 1"=30'
 DATE 10-05-2005
 DRAWN BY MDJ
 CHECKED BY TEH

PLOT FILE: PFMCHARD
 VIEW: CE 46
 COMP. FILE: 030210-StripingPlan.dwg