

F.A.U. RTE.	SECTION	COUNTY	TOTAL SHEETS	SHEET NO.
3873 00-00243-00-FP		MCHENRY	84	49
STA.	TO STA.			
FED. ROAD DIST. NO. 1	ILLINOIS	HIGHWAY PROJECT		
83840				

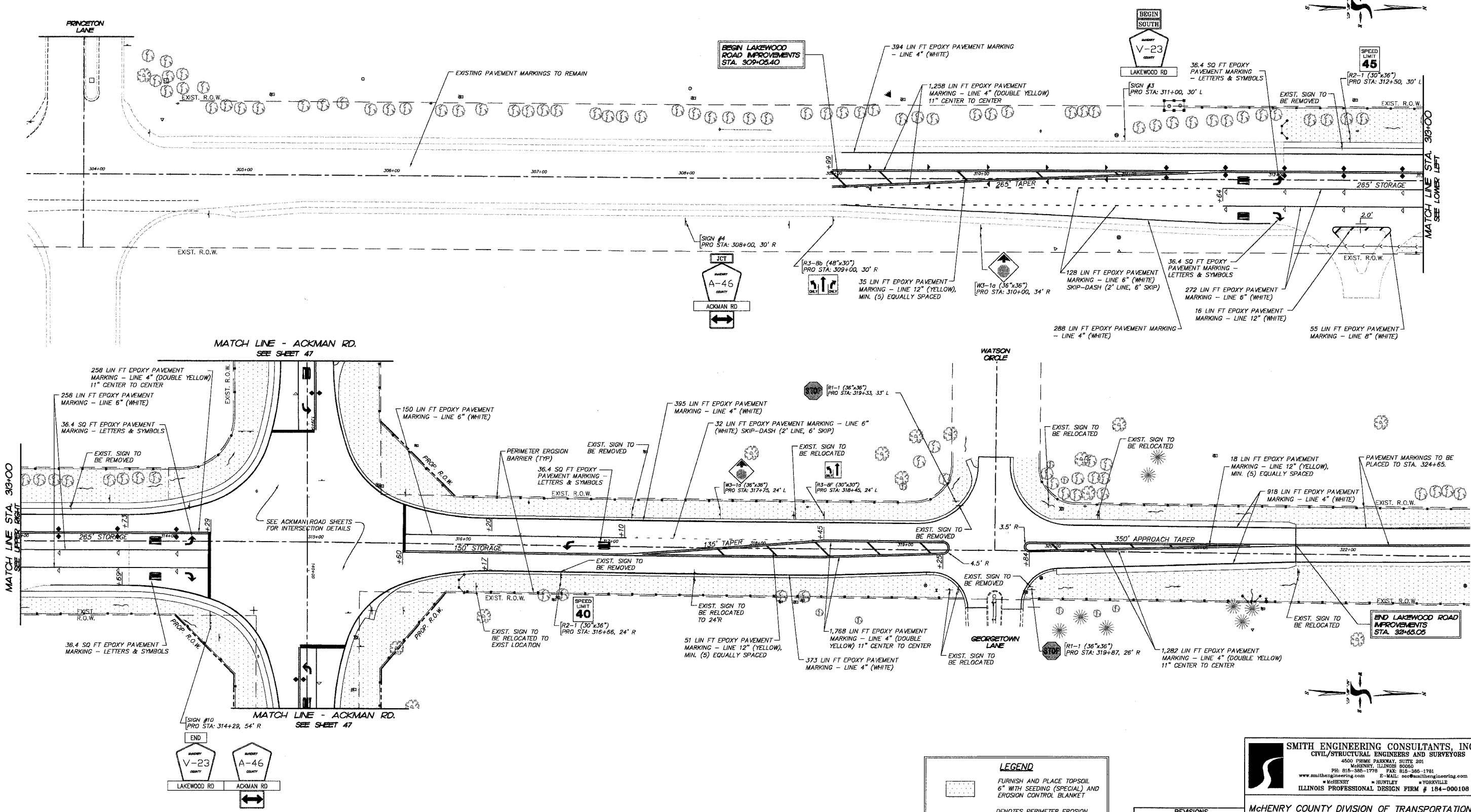

LEGEND

	FURNISH AND PLACE TOPSOIL 6" WITH SEEDING (SPECIAL) AND EROSION CONTROL BLANKET
	DENOTES PERIMETER EROSION BARRIER
	DENOTES TEMPORARY DITCH CHECK AND INLET AND PIPE PROTECTION

REVISIONS

NO.	NAME	DATE
7		
6		
5		
4		
3		
2		
1		

SMITH ENGINEERING CONSULTANTS, INC.
 CIVIL/STRUCTURAL ENGINEERS AND SURVEYORS
 4500 PRIME PARKWAY, SUITE 201
 MCHENRY, ILLINOIS 60050
 PH: 815-385-1770 FAX: 815-385-1781
 www.smithengineering.com E-MAIL: sec@smitheng.com
 * MCHENRY * HUNTER * YORKVILLE
 ILLINOIS PROFESSIONAL DESIGN FIRM # 184-000108

McHENRY COUNTY DIVISION OF TRANSPORTATION
ACKMAN ROAD EXTENSION
 PAVEMENT MARKING, SIGNING, EROSION CONTROL AND RESTORATION PLAN FOR LAKEWOOD ROAD

SCALE: 1"=30'
 DATE 10-05-2005
 DRAWN BY MDJ
 CHECKED BY TEH

PLOT FILE: STANDARD
 COMP. FILE: D30210-StripingPlan.dwg