

F.A.U. RTE.	SECTION	COUNTY	TOTAL SHEETS	SHEET NO.
3873 00-00243-00-FP		MCHENRY	84	78
STA.	210+00	TO STA.	214+00	
FED. ROAD DIST. NO. 1	ILLINOIS	HIGHWAY PROJECT		

83840

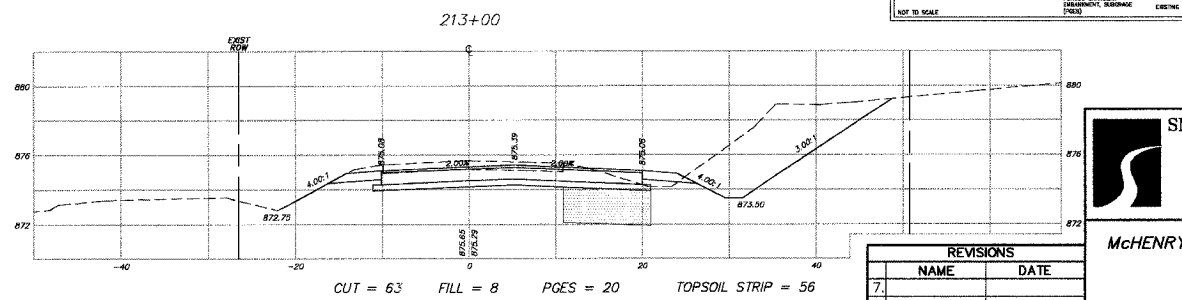

NOTE:
SEE EARTHWORK TABLE FOR A
SUMMARY OF THE CUTS AND FILLS.

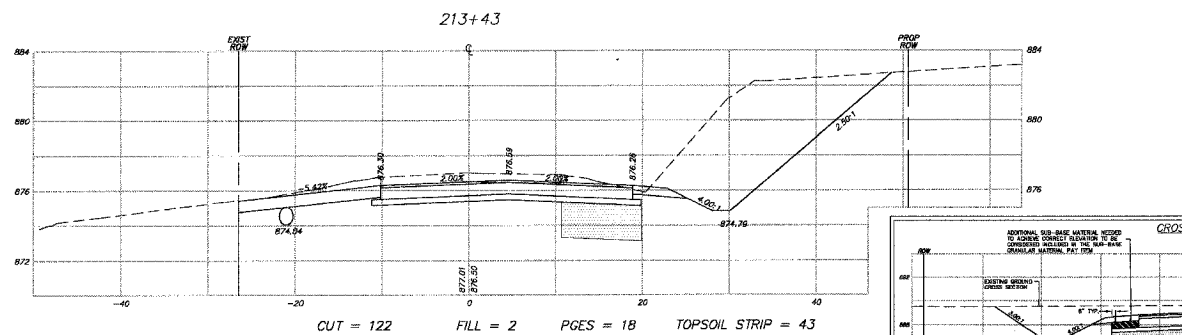
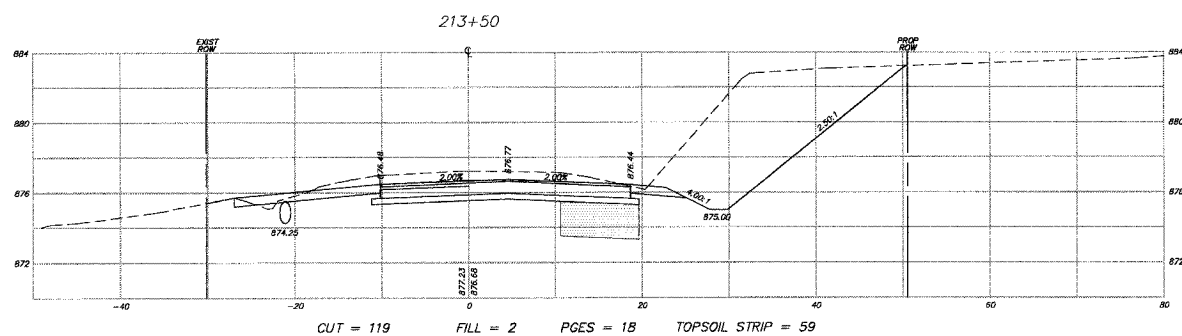
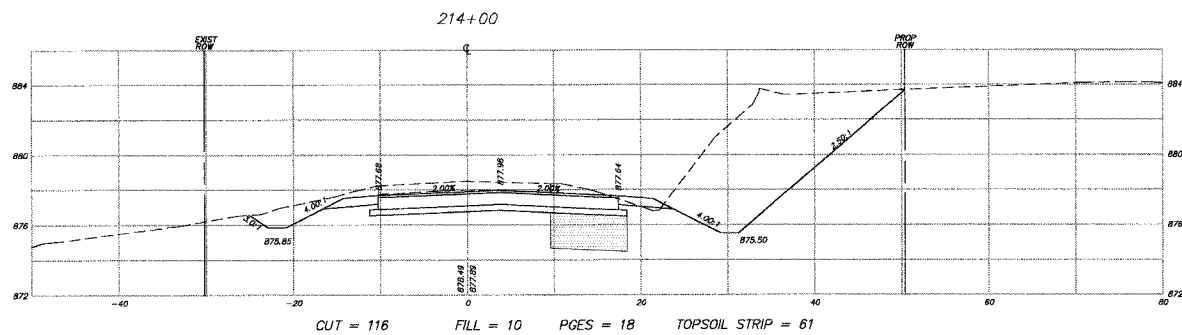
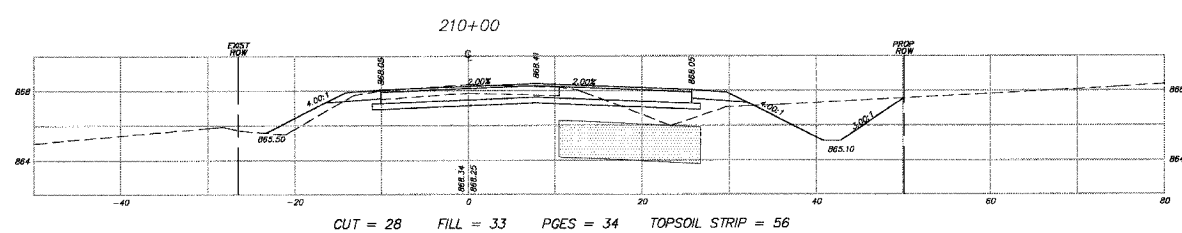
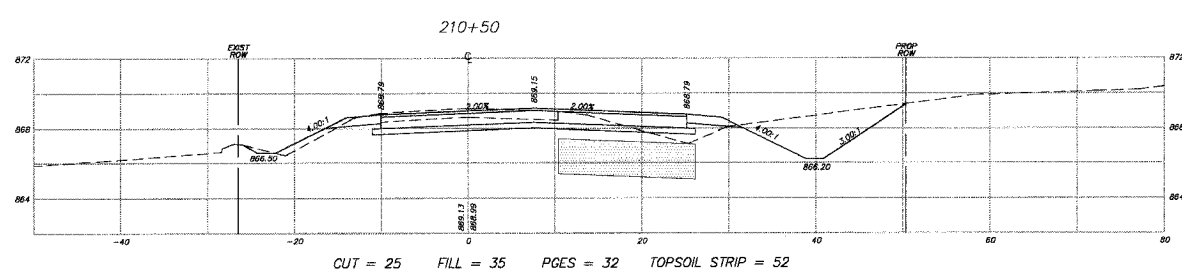
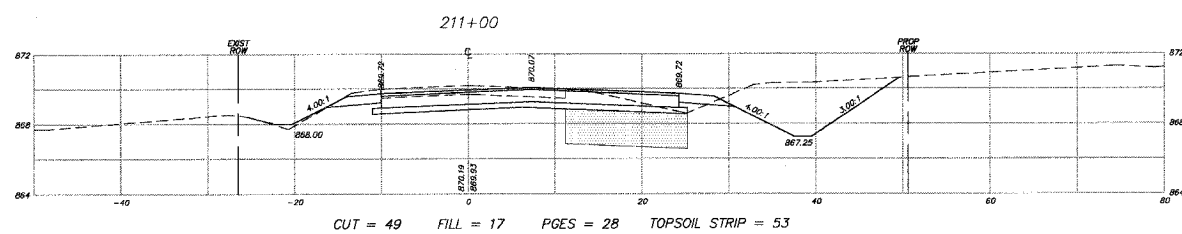
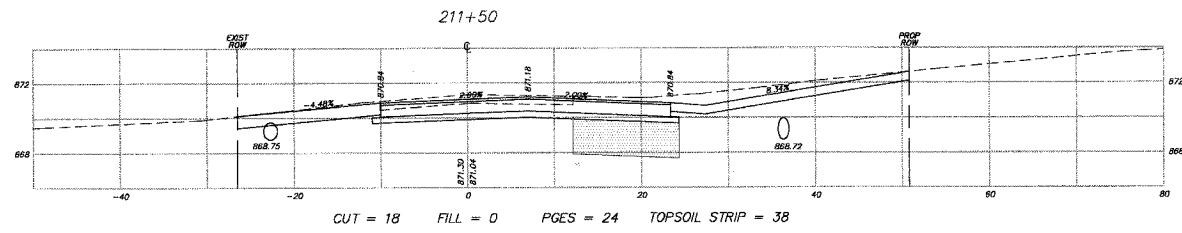
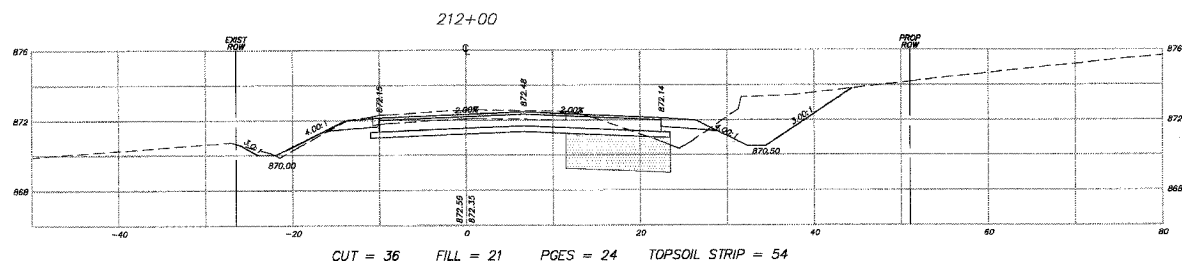
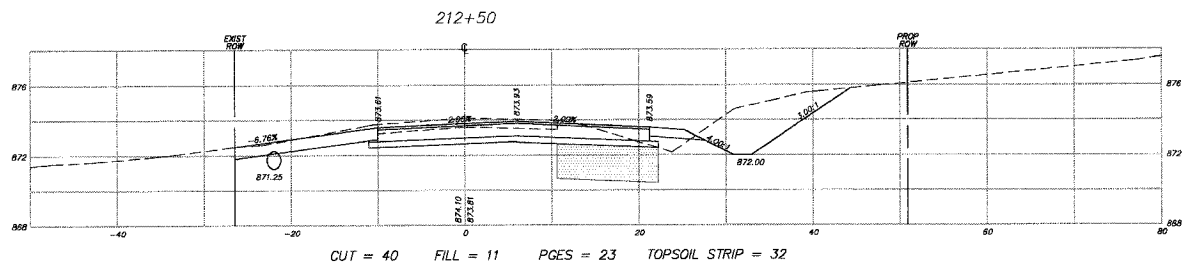
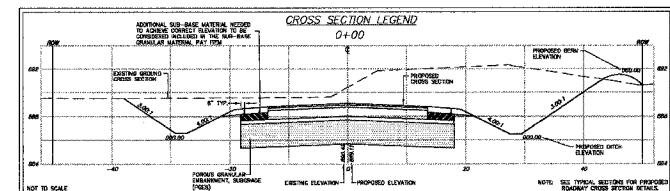

REVISIONS	
NAME	DATE
7.	
6.	
5.	
4.	
3.	
2.	
1.	

SMITH ENGINEERING CONSULTANTS, INC.
 CIVIL/STRUCTURAL ENGINEERS AND SURVEYORS
 4500 FRANK PARKWAY, SUITE 201
 MCHENRY, ILLINOIS 60050
 PH: 815-380-1778 FAX: 815-380-1781
 www.smithengineering.com E-MAIL: seo@smithengineering.com
 MCHENRY HUNTLEY YORKVILLE
 ILLINOIS PROFESSIONAL DESIGN FIRM # 184-000108

McHENRY COUNTY DIVISION OF TRANSPORTATION
 ACKMAN ROAD EXTENSION

CROSS SECTIONS FOR
 HALIGUS RD

SCALE: H:1"=10', V:1"=5'
 DATE 10-05-2005
 DRAWN BY CJP
 CHECKED BY TEH

PLOT FILE: 0.38210243HALIGUS.dwg
 COMP. FILE: 0.38210243HALIGUS.dwg