

F.A. RTE.	SECTION	COUNTY	TOTAL SHEETS	SHEET NO.
595	1 - 1	ROCK ISLAND	239	58
STA. 76+50.00	TO STA. 116+00.00			
FED. ROAD DIST. NO.	ILLINOIS	FED. AID PROJECT		
			CONTRACT # 84986	

**STAGE III CONSTRUCTION**  
(WESTBOUND LANES AND APPURTENANCES)

**SHEET LEGEND**

- ➔ INDICATES DIRECTION OF ONE LANE OF TRAFFIC
- BARRICADE OR DRUM WITH MONODIRECTIONAL STEADY-BURN LIGHT
- VERTICAL BARRICADE
- TYPE III BARRICADE

MAINTAIN ACCESS TO THIS ENTRANCE UNTIL RELOCATED ENTRANCE LT. STA 101+07 IS COMPLETED

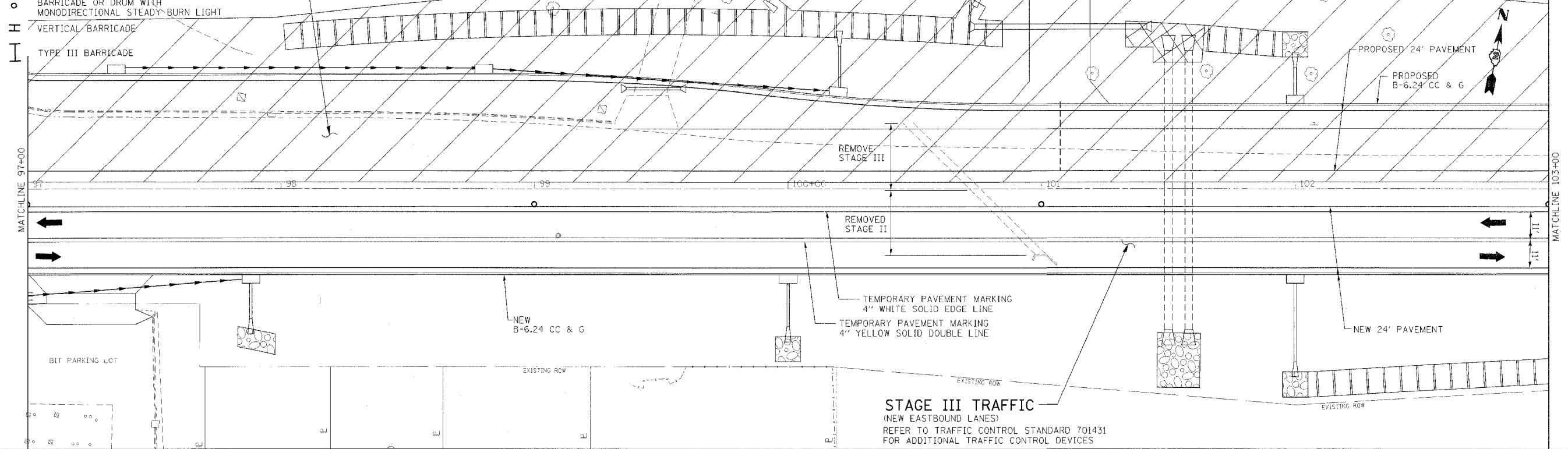

**STAGE III TRAFFIC**  
(NEW EASTBOUND LANES)  
REFER TO TRAFFIC CONTROL STANDARD 701431 FOR ADDITIONAL TRAFFIC CONTROL DEVICES

**STAGE III CONSTRUCTION**  
(WESTBOUND LANES AND APPURTENANCES)

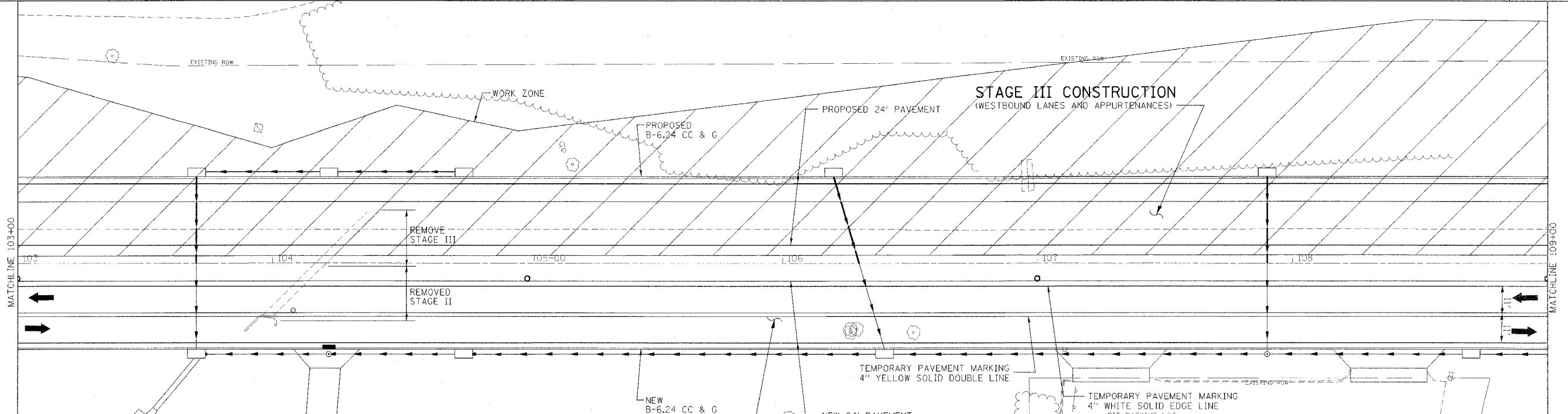

**STAGE III TRAFFIC**  
(NEW EASTBOUND LANES)  
REFER TO TRAFFIC CONTROL STANDARD 701431 FOR ADDITIONAL TRAFFIC CONTROL DEVICES

REVISIONS	
NAME	DATE

ILLINOIS DEPARTMENT OF TRANSPORTATION

**STAGE III STAGING DETAILS**

SCALE: VERT. \_\_\_\_\_  
HORIZ. \_\_\_\_\_  
DATE \_\_\_\_\_ DRAWN BY \_\_\_\_\_  
CHECKED BY \_\_\_\_\_

ILLINOIS PROFESSIONAL DESIGN FIRM NO. 184-001533



Stanley Consultants Inc.  
650 West Higgins Road, Suite 730, Chicago, Illinois 60639-2901  
www.stanley.com