

ESTIMATED BILL OF MATERIALS

ITEM	UNITS	QUANTITY
SPAN WIRE	LIN. FT.	470
TETHER WIRE	LIN. FT.	470
WOOD POLE	EACH	4
CONTROLLER, FIXED TIME, 3 DIALS	EACH	1
TIME CLOCK	EACH	2
ELECTRIC CABLE, NO. 8, 2/C	LIN. FT.	105
ELECTRIC CABLE, NO. 10, 2/C	LIN. FT.	295
ELECTRIC CABLE, NO. 14, 5/C	LIN. FT.	655
ELECTRIC CABLE, NO. 14, 7/C	LIN. FT.	685
250 WATT HPS LUMINARE & LAMP W/BUILT IN PHOTOCELL	EACH	2
8' STREET LIGHT ARM	EACH	2
SIGNAL HEAD, 1-FACE, 3 SECTION SPAN-WIRE MOUNTED	EACH	4
SIGNAL HEAD, 1-FACE, 5 SECTION SPAN-WIRE MOUNTED	EACH	4
TRAFFIC SIGNAL BACKPLATES	EACH	8

LEGEND

- ⊗ - WOOD POLE, CL V, 40'
- ⊠ - CONTROLLER, FIXED TIME, 3-DIAL
- - 250 WATT HPS LUMINARE & LAMP
- ▷ - SIGNAL HEAD

SIGNAL HEAD LOCATIONS

- STAGE I - 3, 4, 7, 8, 11, 12, 15, 16
- STAGE II, PHASE I - 1, 2, 9, 10, 13, 14, 15, 16
- STAGE II, PHASE II - 5, 6, 9, 10, 11, 12, 15, 16
- STAGE III, PHASE I - 1, 2, 7, 8, 13, 14, 17, 18
- STAGE III, PHASE IIA - 1, 2, 7, 8, 11, 12, 17, 18
- STAGE III, PHASE IIB - 5, 6, 7, 8, 11, 12, 17, 18
- STAGE IV, PHASE I - 3, 4, 7, 8, 13, 14, 15, 16
- STAGE IV, PHASE II - 5, 6, 7, 8, 11, 12, 15, 16

NOTE:

MOVING SIGNAL HEADS AS SHOWN ABOVE
OR AS OTHERWISE DIRECTED BY THE ENGINEER
SHALL BE CONSIDERED INCIDENTAL

F.A. RTE.	SECTION	COUNTY	TOTAL SHEETS	SHEET NO.
595	1-1	ROCKISLAND	239	98
STA.	TO STA.			
FED. ROAD DIST. NO.	ILLINOIS FED. AID PROJECT			
CONTRACT # 84986				

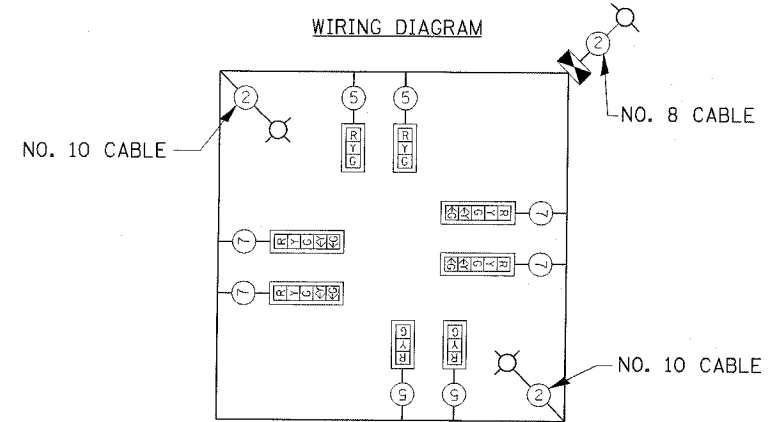
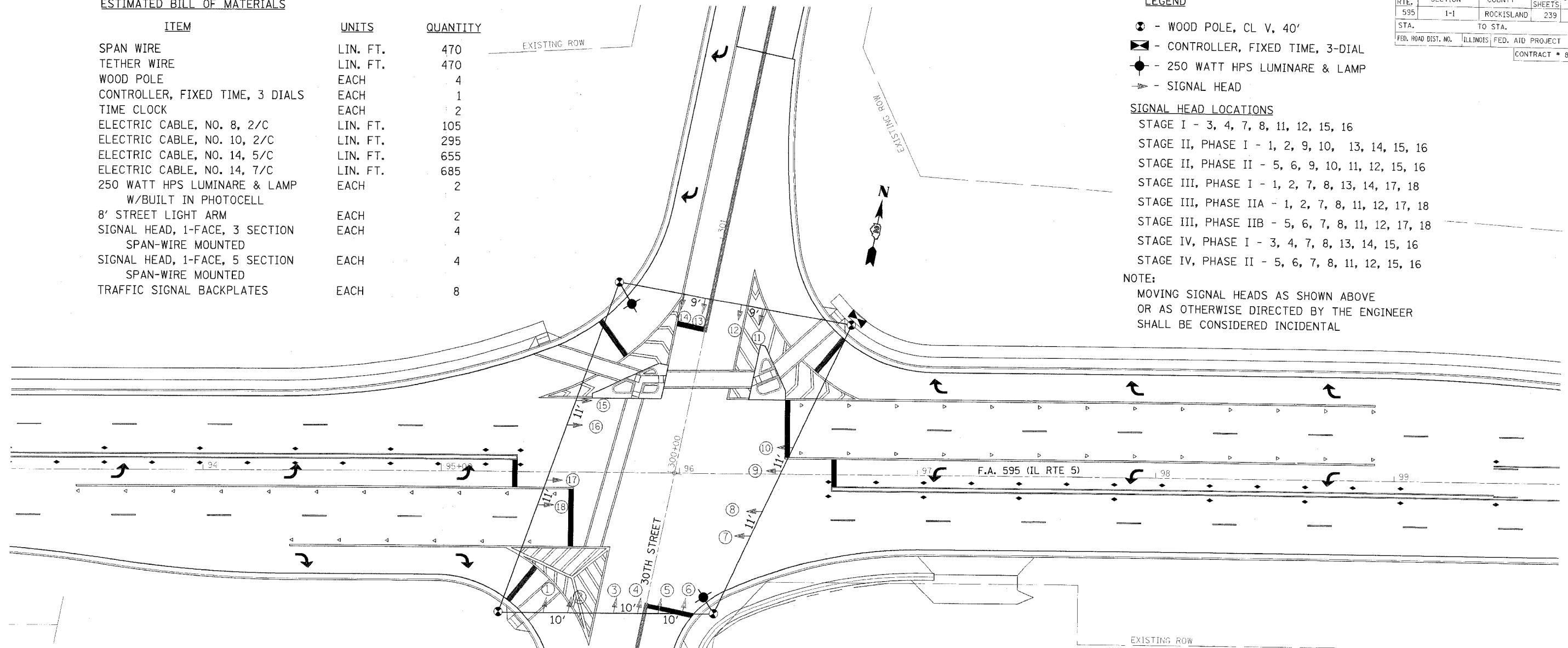

TEMPORARY SEQUENCE OF OPERATIONS

PHASE	A		B		C		FLASH			
MOVEMENT	↔		↕		↕		↑↓			
INTERVAL	1	2	3	4	5	6	7	8	9	10
IL-5(BLACKHAWK RD)	G	Y	R	R	R	R	G	Y	R	R
30TH STREET	R	R	R	G	Y	R	R	R	R	R

NOTE:
ALL SIGNAL HEADS WITH
12" LENSES AND BACKPLATES.



REVISIONS	
NAME	DATE

ILLINOIS PROFESSIONAL
DESIGN FIRM NO. 184-001533

Stanley Consultants Inc.
953 West Algonquin Road, Suite 730, Chicago, Illinois 60631-2838
www.stanleyinc.com

ILLINOIS DEPARTMENT OF TRANSPORTATION

**TEMPORARY TRAFFIC
SIGNAL DETAILS**

SCALE: VERT. _____
HORIZ. _____

DATE _____

DRAWN BY _____
CHECKED BY _____