

STATE OF ILLINOIS
DEPARTMENT OF TRANSPORTATION

ROUTE NO.	SECTION	COUNTY	TOTAL SHEETS	SHEET NO.
595	I-1	ROCK ISLAND	239	145
FED. ROAD DIST. NO. 2		ILLINOIS	FED. AID PROJECT	13 SHEETS

Contract No. 84986

BILL OF MATERIAL

Bar	No.	Size	Length	Shape
d1 (E)	36	#4	2'-0"	□
h71 (E)	2	#4	31'-1"	—
h72 (E)	2	#4	31'-8"	—
h73 (E)	2	#4	29'-8"	—
h74 (E)	8	#6	32'-1"	—
h75 (E)	10	#6	32'-8"	—
h76 (E)	10	#6	29'-9"	—
h77 (E)	2	#4	25'-6"	—
h78 (E)	2	#4	13'-2"	—
v51 (E)	60	#4	3'-6"	—
v52 (E)	60	#4	2'-4"	—
v53 (E)	124	#4	4'-0"	—
v54 (E)	62	#4	2'-5"	—
v55 (E)	30	#4	3'-8"	—
v56 (E)	32	#4	5'-0"	—
Porous Granular Backfill			Cu Yd	11.9
Structure Excavation			Cu Yd	40.5
Rock Excavation			Cu Yd	8.1
For Structures				
Concrete Structures			Cu Yd	16.8
Reinforcement Bars, Epoxy Coated			Pound	2390

Reinforcement bars designated (E) shall be epoxy coated.

See Sheet 2 of 13 for Expansion Joint and Water Seal Placement Detail.

See Sheet 10 of 13 for Pedestrian Railing Details.

See Sheet 3 of 13 for Retaining Wall, Typical Section and Underdrain Details.

Min Lap Length: #4 bar - 1'-8"
#6 bar - 2'-7"

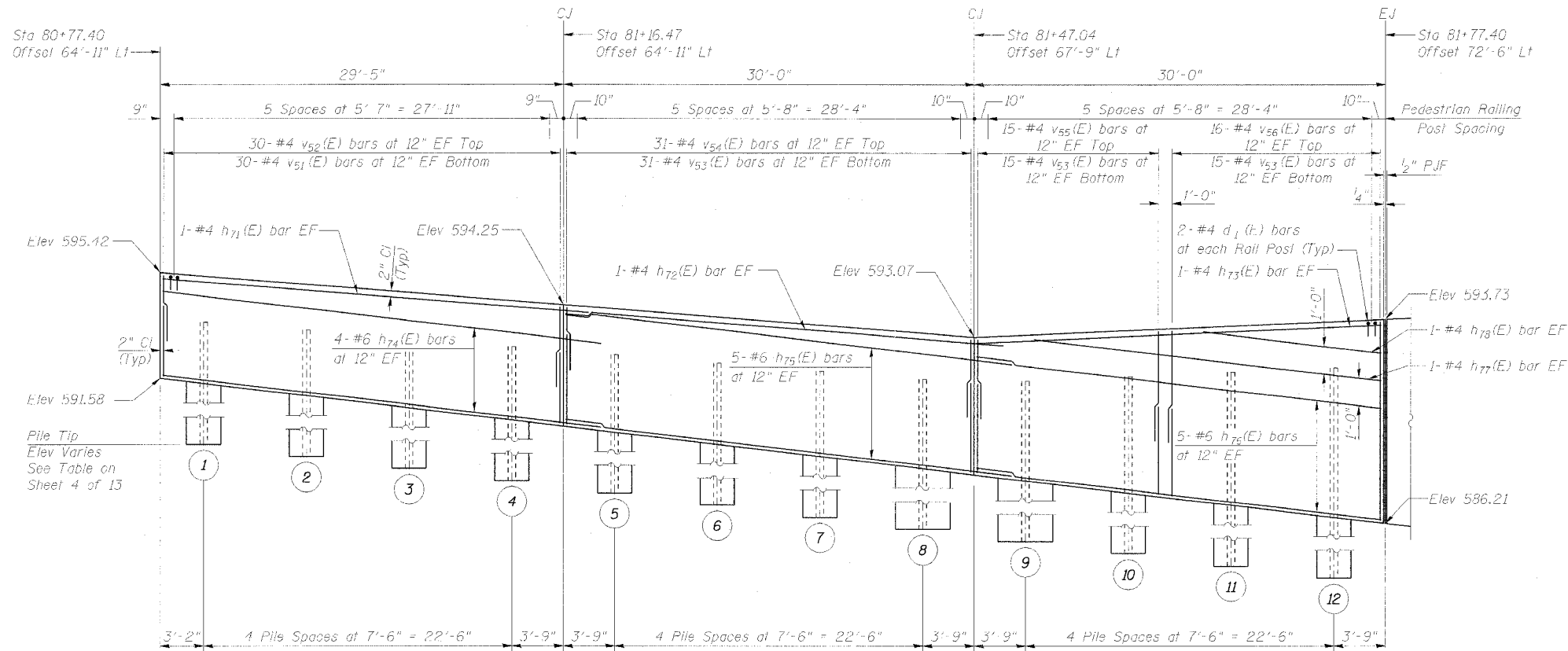
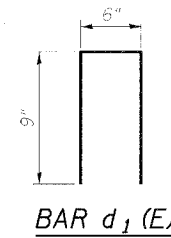

FRONT FACE ELEVATION

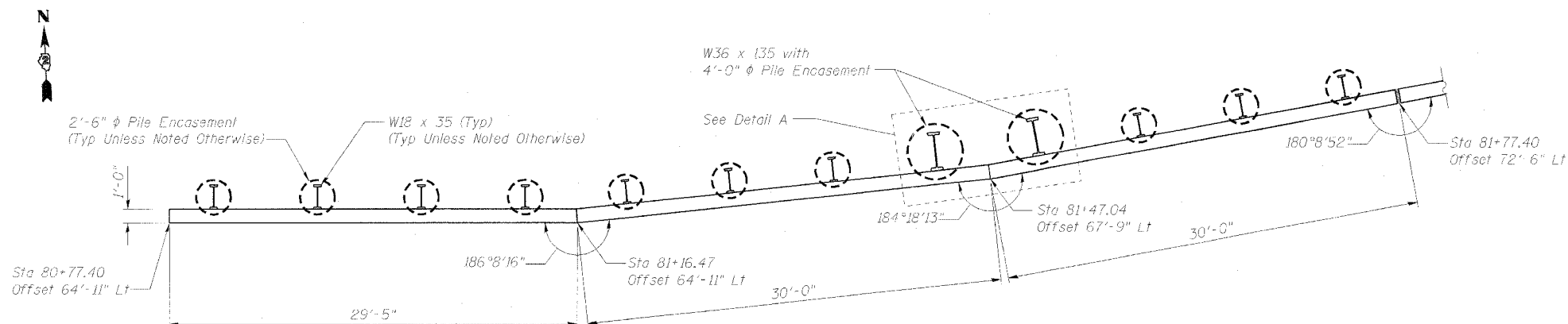

PLAN

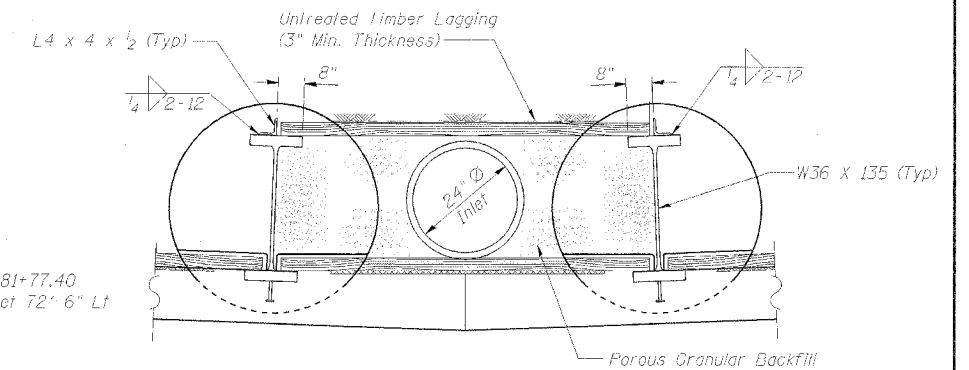

DETAIL A

NOTE:

Lagging and angles to extend from top of pile to base of rock bedding for inlet, as shown in Special Utility Details in Roadway Plans.

Illinois Firm Registration No. 04-00533



WALL PLAN AND ELEVATION
RETAINING WALL F ALONG
INDIAN HILL ROAD
FA 595 (IL ROUTE 5) SECTION I-1
ROCK ISLAND COUNTY
STA 80+86.37 TO STA 13+73.25

DESIGNED	NLV
CHECKED	DSE
DRAWN	RTT
CHECKED	DSE
DATE	JAN 31, 2006