

SHEET NO.	SECTION	COUNTY	TOTAL SHEETS	SHEET NO.
5-84 F.A. 224	04-00137-03-FP	HENRY	31	1
FED. ROAD DIST. NO. 7		ILLINOIS	FED. AID PROJECT OR-624(107)	

STATE OF ILLINOIS
COUNTY OF HENRY

PLANS FOR PROPOSED
FEDERAL-AID SECONDARY PROJECT

SECTION 04-00137-03-FP
WOLF ROAD /1280 E. ROAD
INTERSECTION & TURN LANES
F.A.S. ROUTE 224 C.H. 2
PROJECT SR-224(107)
JOB NO. C-92-063-05
CONTRACT NO. 85372
2006

INDEX OF SHEETS

1	COVER SHEET AND INDEX OF SHEETS
2	SUMMARY OF QUANTITIES
3 - 4	TYPICAL SECTIONS
5 - 8	SCHEDULES OF QUANTITIES & GENERAL NOTES
9 - 13	PLAN AND PROFILE - WOLF ROAD
14	PLAN AND PROFILE - 1280 E. ROAD
15 - 20	STORM WATER POLLUTION PREVENTION PLAN
21 - 27	CROSS SECTIONS - WOLF ROAD
28 - 29	CROSS SECTIONS - 1280 E. ROAD
30	CONCRETE GUTTER TYPE A, (MODIFIED)
31	INLET SPECIAL WITH FRAME AND GRATE

STANDARDS

000001-04	STANDARD SYMBOLS, ABBREVIATIONS, AND PATTERNS
280001-02	TEMPORARY EROSION CONTROL SYSTEMS
406201	MAILBOX TURNOUT
542401	METAL END SECTION FOR PIPE CULVERTS
606101-01	TYPE A GUTTER (INLET, OUTLET & ENTRANCE)
666001	RIGHT OF WAY MARKERS
701001-01	OFF-ROAD OPERATIONS, 2L 2W, 4.5 m (15') MIN. AWAY, FOR SPEEDS > 45 MPH
701006-02	OFF-ROAD OPERATIONS, 2L 2W, 4.5 m (15') TO 600 m (24')
701301-02	LANE CLOSURE, 2L 2W, SHORT TIME OPERATIONS
701306-01	LANE CLOSURE, 2L 2W, SLOW MOVING OPERATIONS DAY ONLY, FOR SPEEDS > 45 MPH
701311-02	LANE CLOSURE, 2L 2W, MOVING DAY ONLY OPERATIONS
701326-02	LANE CLOSURE 2L, 2W PAVEMENT WIDENING, FOR SPEEDS > 45 MPH
702001-06	TRAFFIC CONTROL DEVICES
780001-01	TYPICAL PAVEMENT MARKINGS

NAME AND ADDRESS OF UTILITIES	TYPE
MEDIACOM 3900 26th Avenue Moline, IL 61265 Attn: Dennis Jarding (309) 743-4750	CABLE TV
GENESEO COMMUNICATIONS 111 E. First Street Geneseo, IL 61254 Attn: Matt Storm (309) 944-2103 X-012	TELEPHONE
MIDAMERICAN ENERGY 2811 Fifth Avenue Rock Island, IL 61201 Attn: Steve Kelsey (309) 793-3778	GAS/ELECTRIC

PLAN HORIZ. 1" = 20'
SCALES: PROFILE HORIZ. 1" = 20'
PROFILE VERT. 1" = 5'
CROSS SECTIONS 1" = 5', 10'

1280 E. ROAD
STARTS AT STA. 40+19

1280 E. ROAD
ENDS AT STA. 42+03

WOLF ROAD
BEGINS AT STA. 678+10.84

WOLF ROAD
ENDS AT STA. 698+64.17

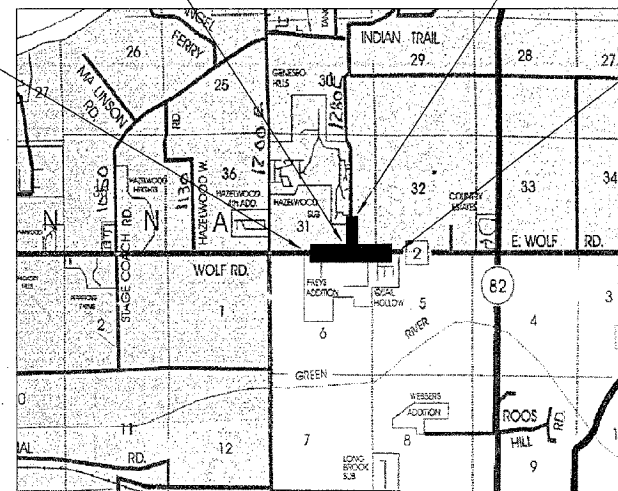

LOCATION MAP
NET LENGTH = 2,237.33 FEET = 0.42 MILES

APPROVED: Jon G 20.06
PASSED: January 27 20.06
APPROVED: January 27 20.06
FOR BIDDING: January 27 20.06

STATE OF ILLINOIS
DEPARTMENT OF TRANSPORTATION

DESIGN CRITERIA

DESIGN SPEED: 60 MPH - WOLF ROAD
50 MPH - 1280 E. ROAD

CLEAR ZONE: 20'

FUNCTIONAL CLASSIFICATION	HIGHWAY	DHV (2024)	TRUCKS (1%)
LOCAL	1280 E. ROAD	100-200	1
MAJOR COLLECTOR	WOLF ROAD	850	1

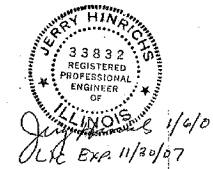

REVISED 11/17/05 WHA #1003D04

WILLETT, HOFMANN & ASSOCIATES, INC.
CONSULTING ENGINEERS
Land Surveying - Transportation - Structural
Environmental - Architecture

809 East Second Street Dixon, Illinois 61021
Phone 815.284.3361 Fax 815.284.3385
Design Firm #184-000918
www.willetthofmann.com